

Joseph Lstiburek, Ph.D., P.Eng, ASHRAE Fellow

Building Science

Adventures In Building Science

www.buildingscience.com

2nd Law of Thermodynamics

In an isolated system, a process can occur only if it increases the total entropy of the system

Rudolf Clausius

Heat Flow Is From Warm To Cold
Moisture Flow Is From Warm To Cold
Moisture Flow Is From More To Less
Air Flow Is From A Higher Pressure to a
Lower Pressure
Gravity Acts Down

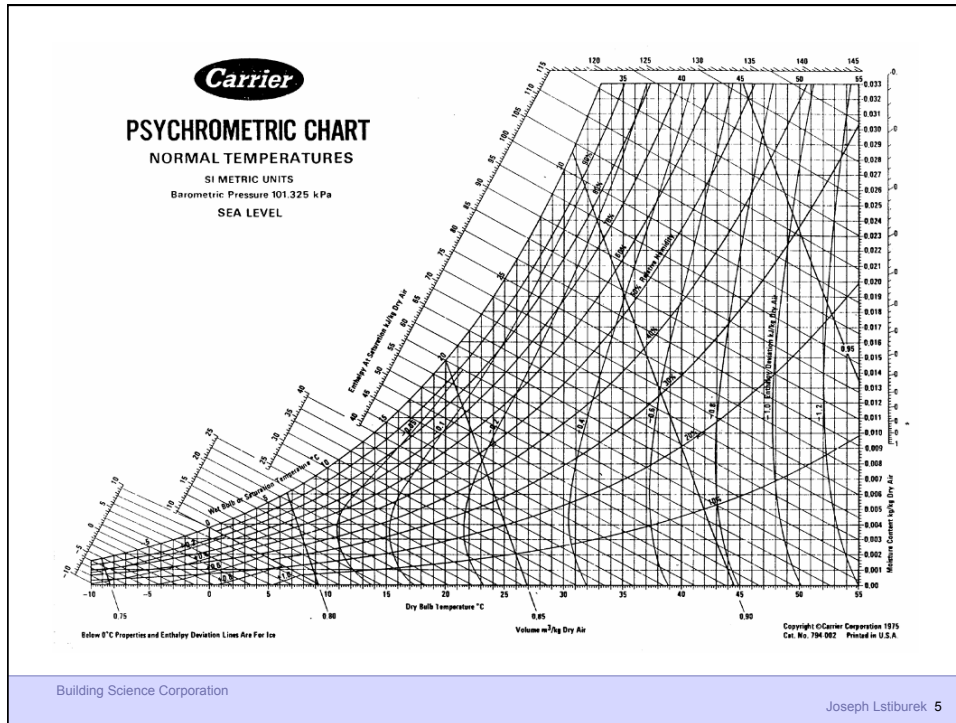

Damage Functions

Building Science Corporation

Joseph Lstiburek 6

The figure is a slide titled 'Damage Functions'. It contains the text 'Building Science Corporation' at the bottom left and 'Joseph Lstiburek 6' at the bottom right.

Damage Functions
Water
Heat
Ultra Violet Radiation

The Three Biggest Problems In Buildings Are
Water, Water and Water...

80 Percent of all Construction Problems are Related to Water

Building Science Corporation

Joseph Lstiburek 9

What is a Building?

Building Science Corporation

Joseph Lstiburek 10

- Control heat flow
- Control airflow
- Control water vapor flow
- Control rain
- Control ground water
- Control light and solar radiation
- Control noise and vibrations
- Control contaminants, environmental hazards and odors
- Control insects, rodents and vermin
- Control fire
- Provide strength and rigidity
- Be durable
- Be aesthetically pleasing
- Be economical

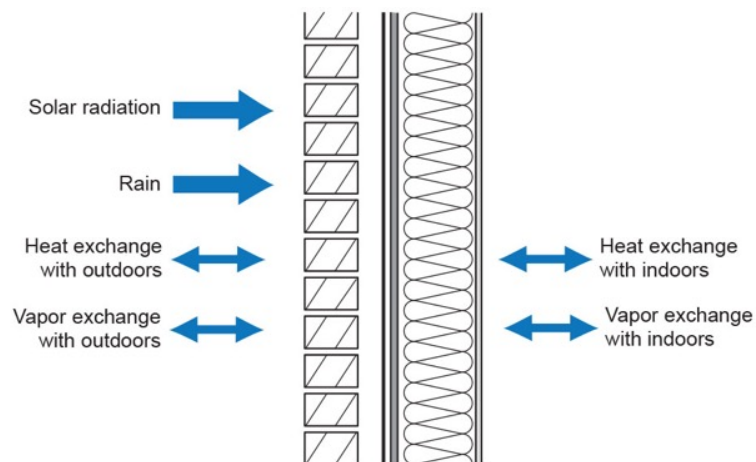

Water Control Layer
Air Control Layer
Vapor Control Layer
Thermal Control Layer

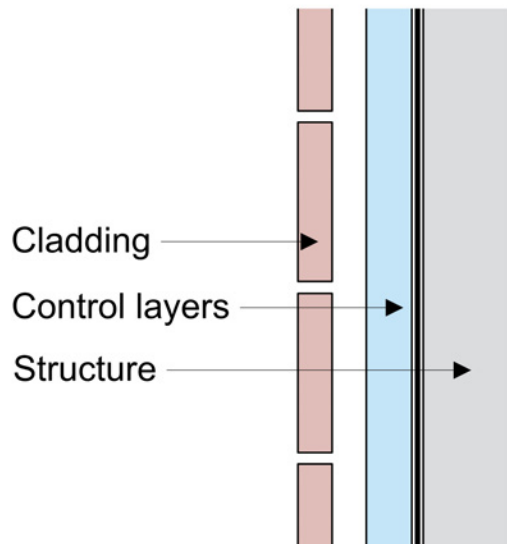

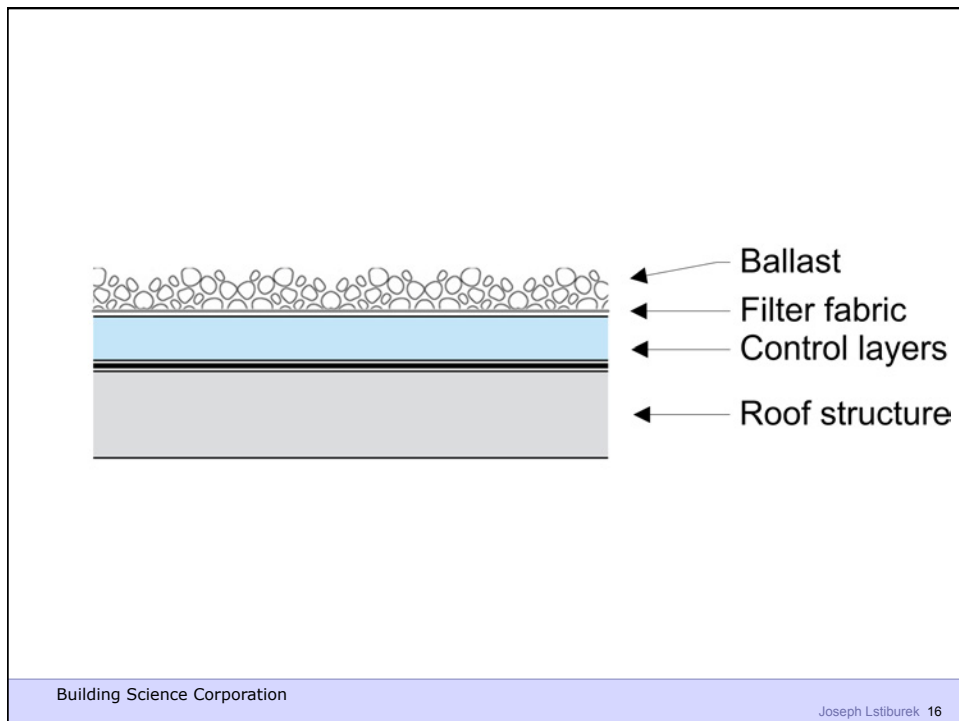
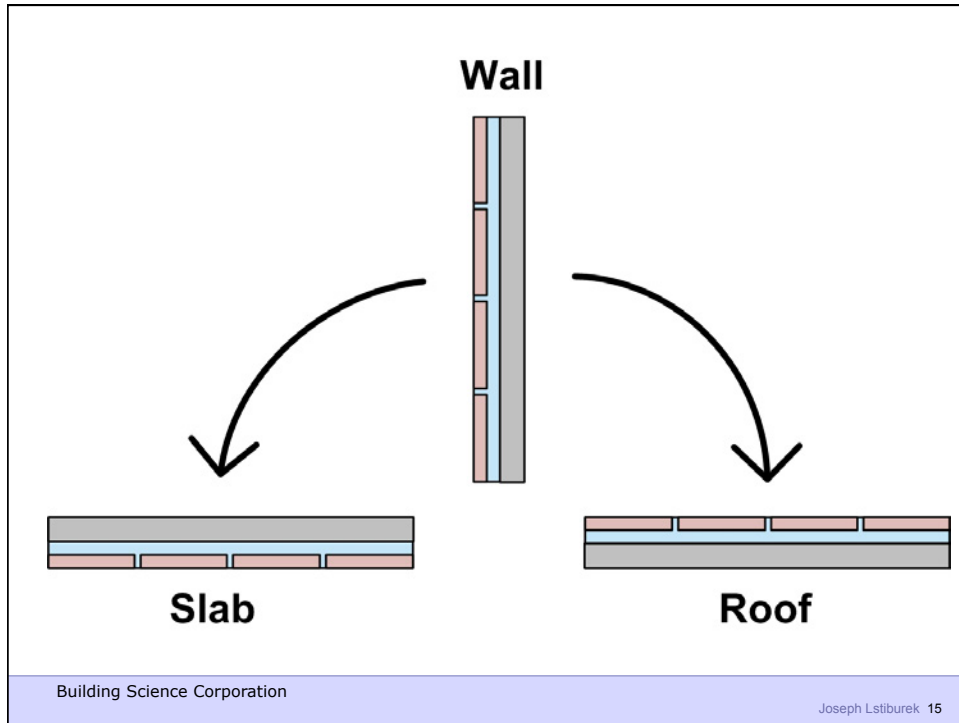

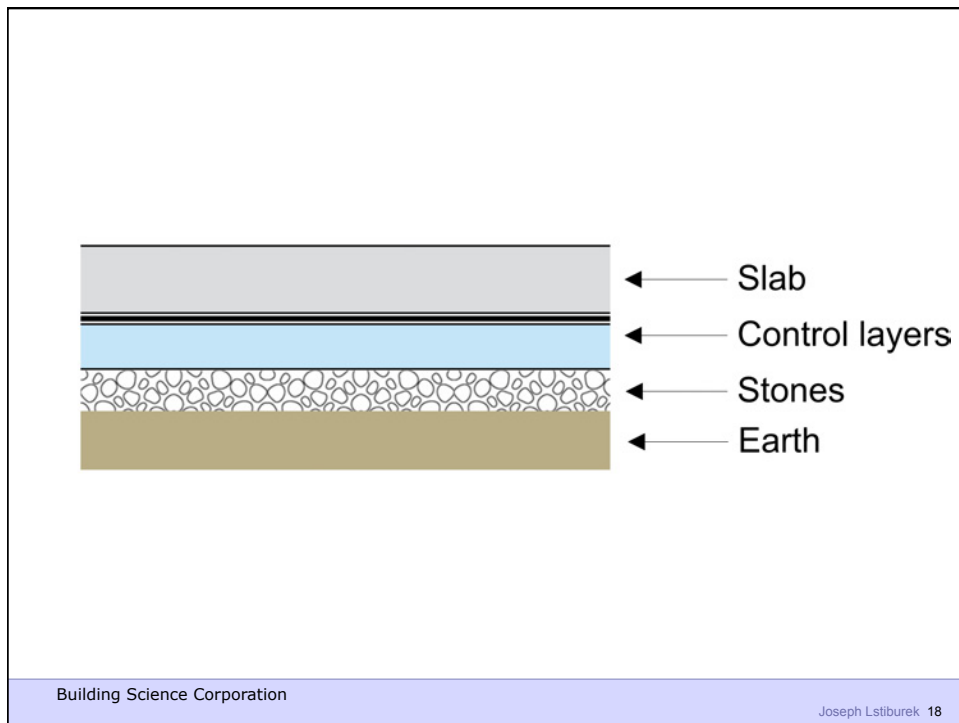
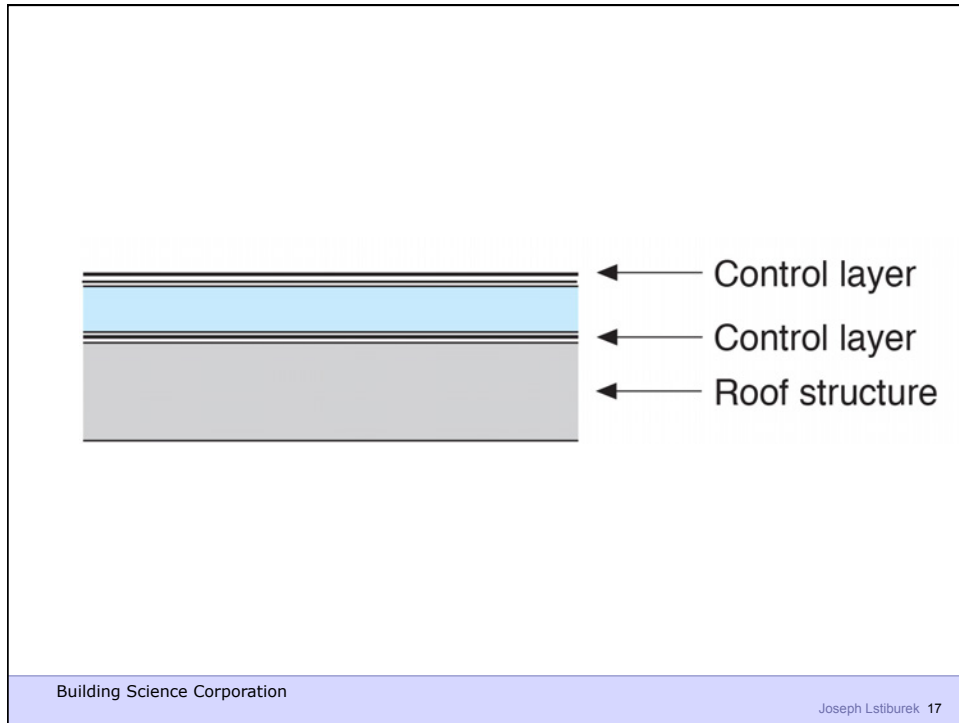

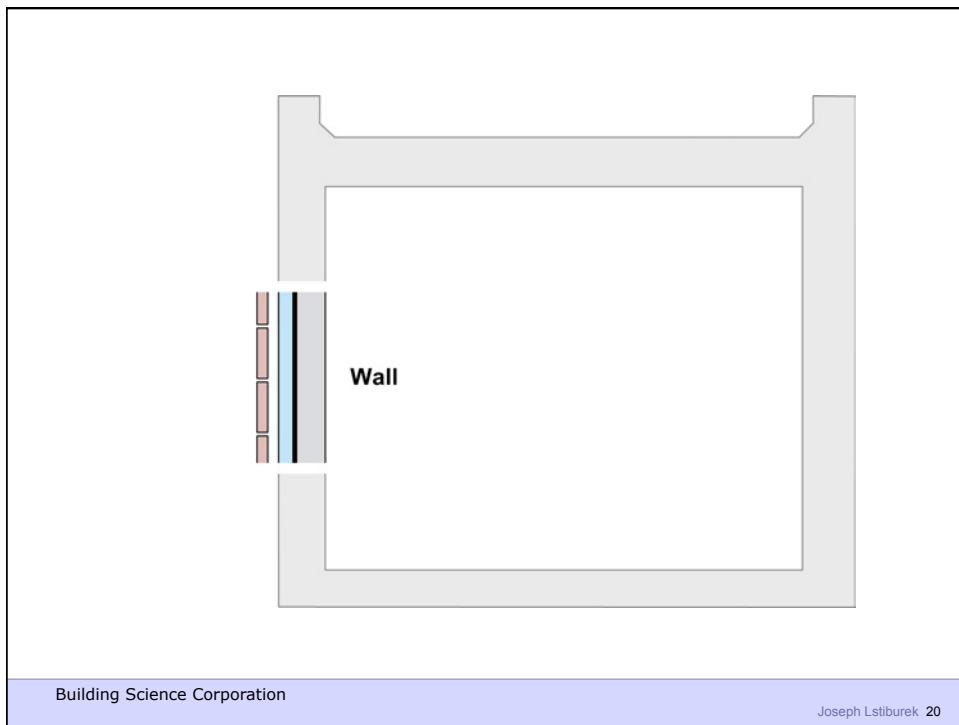
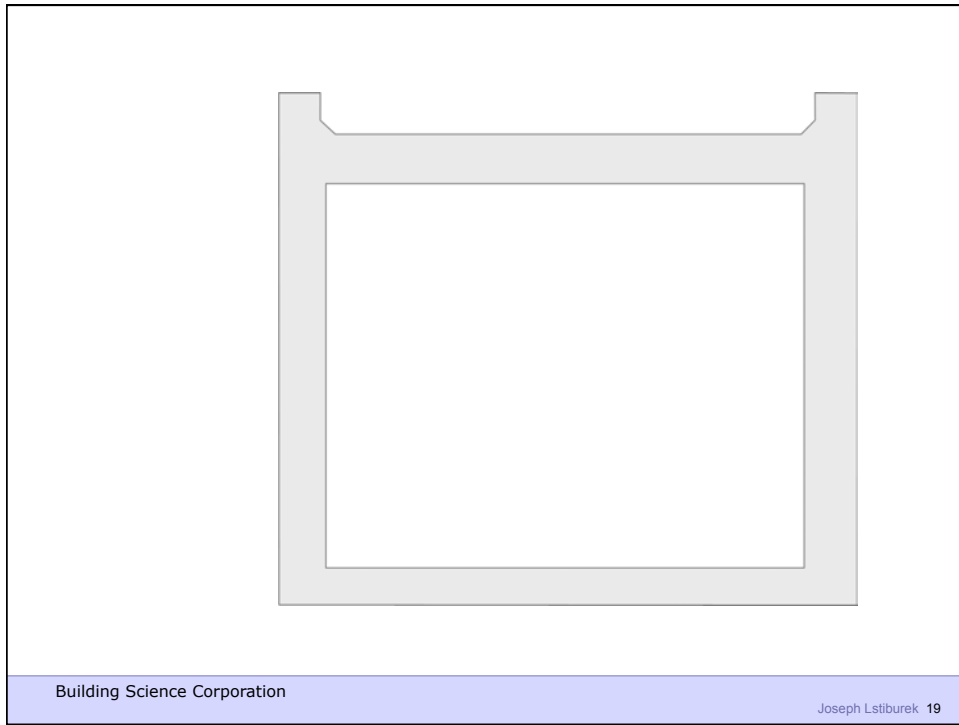

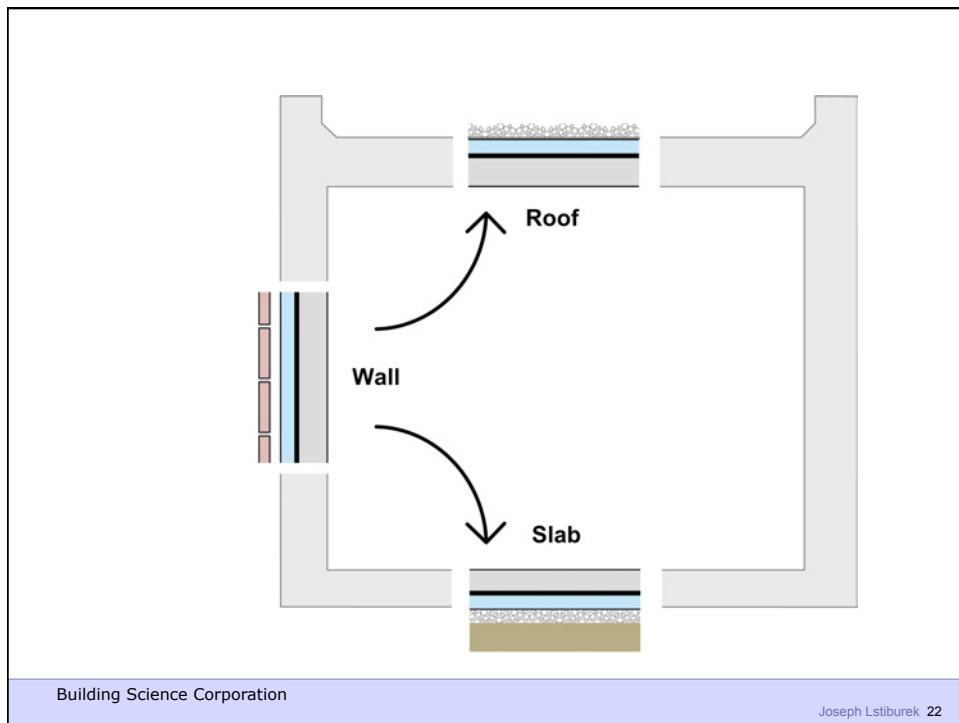
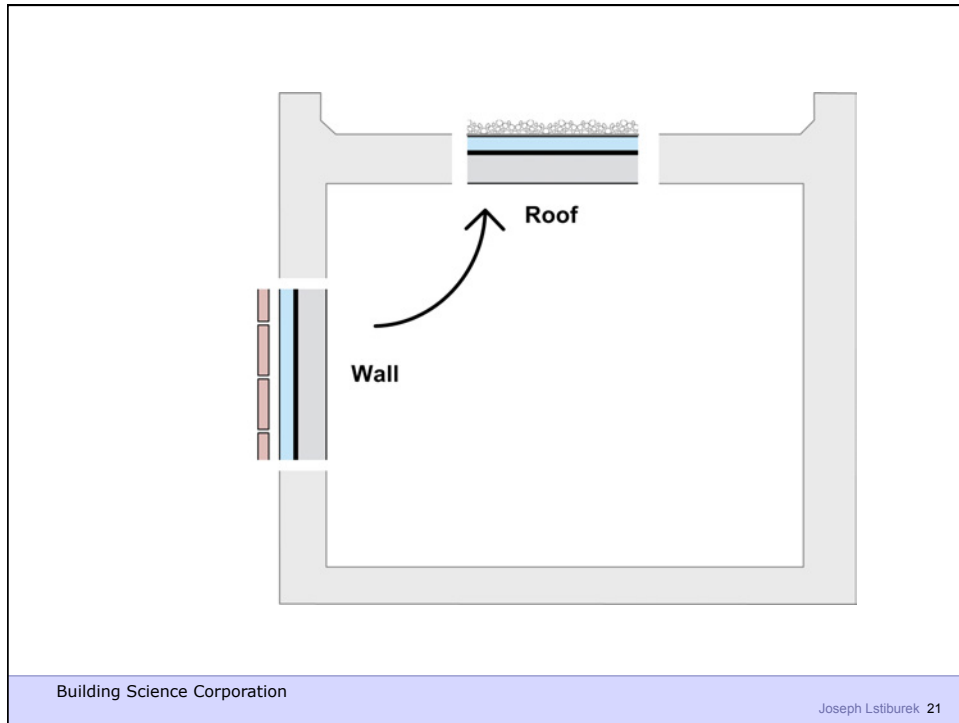

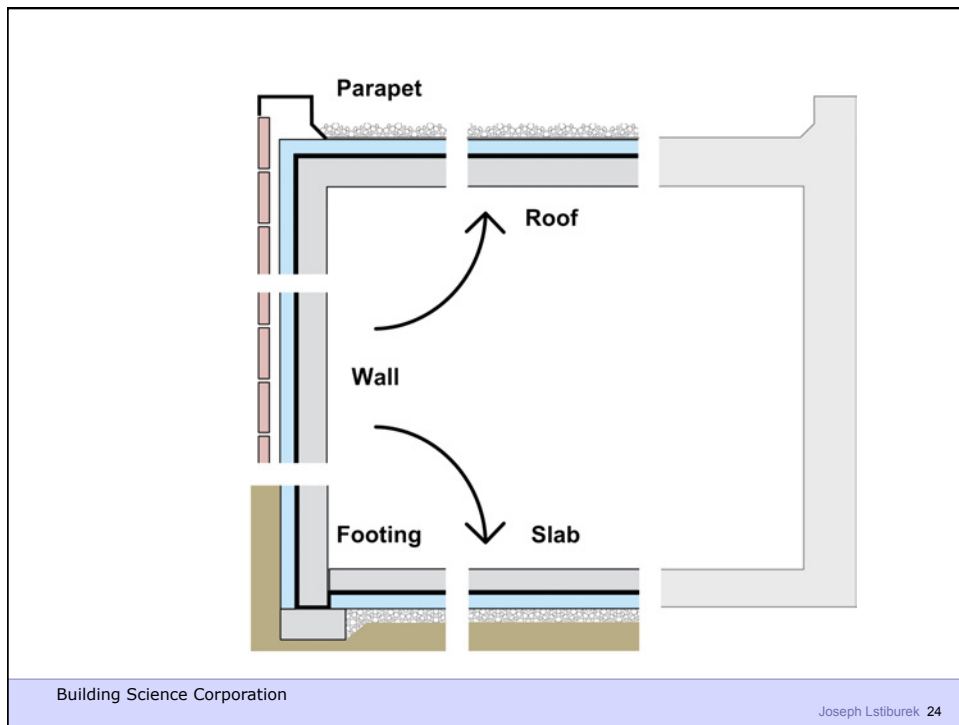
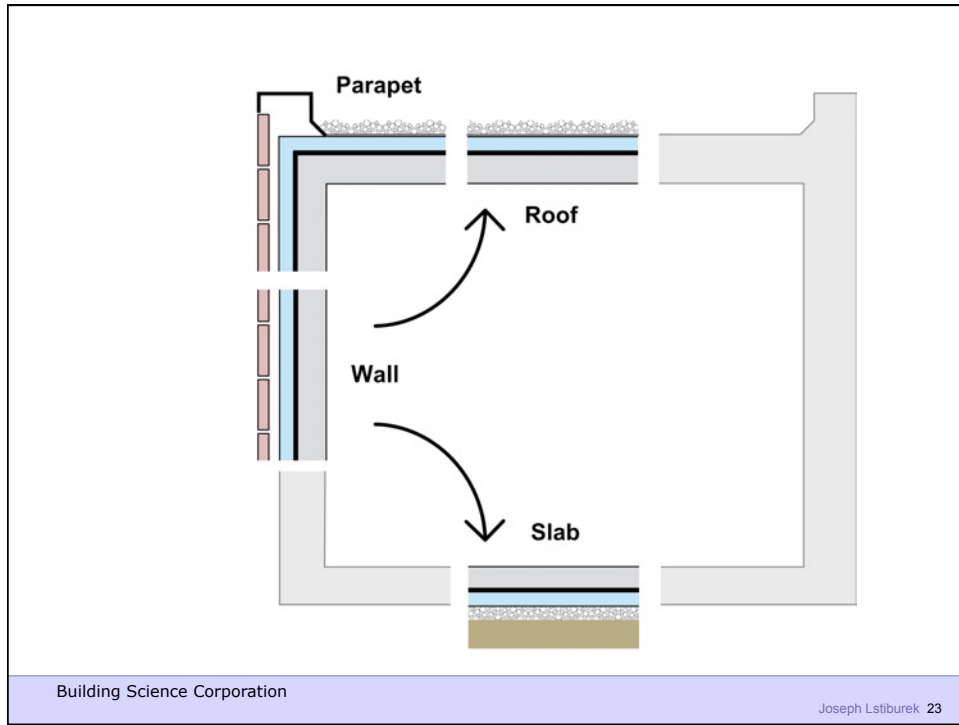

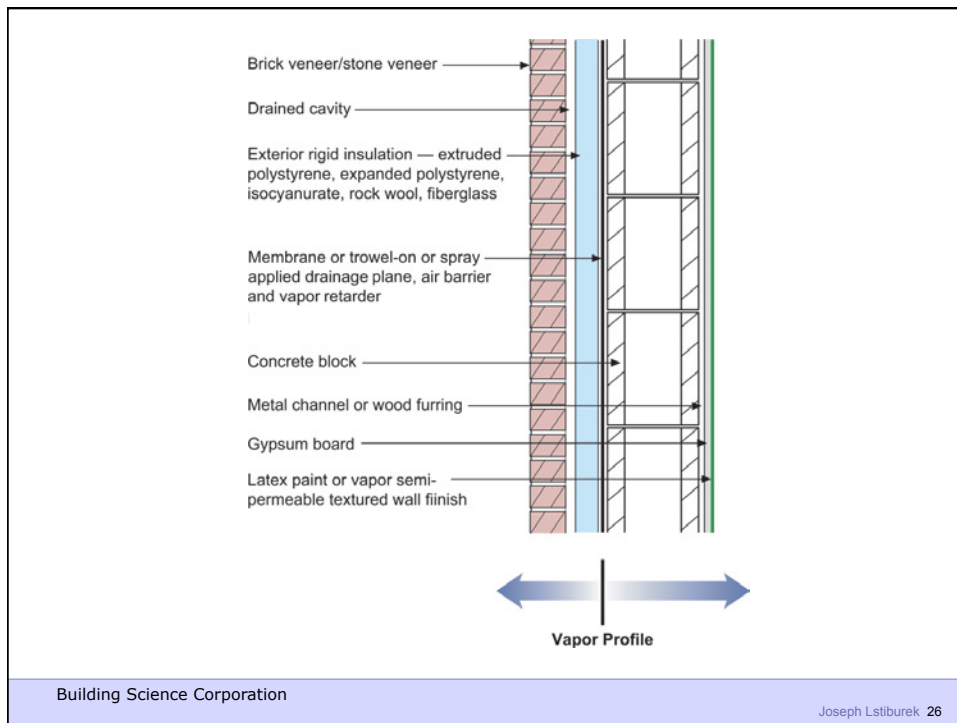
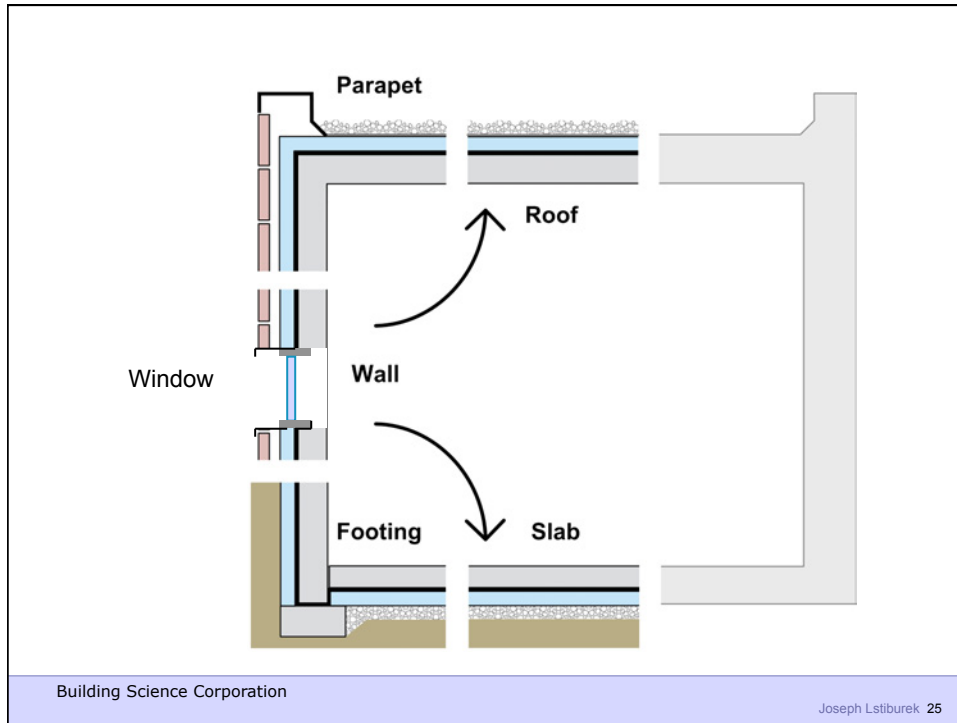

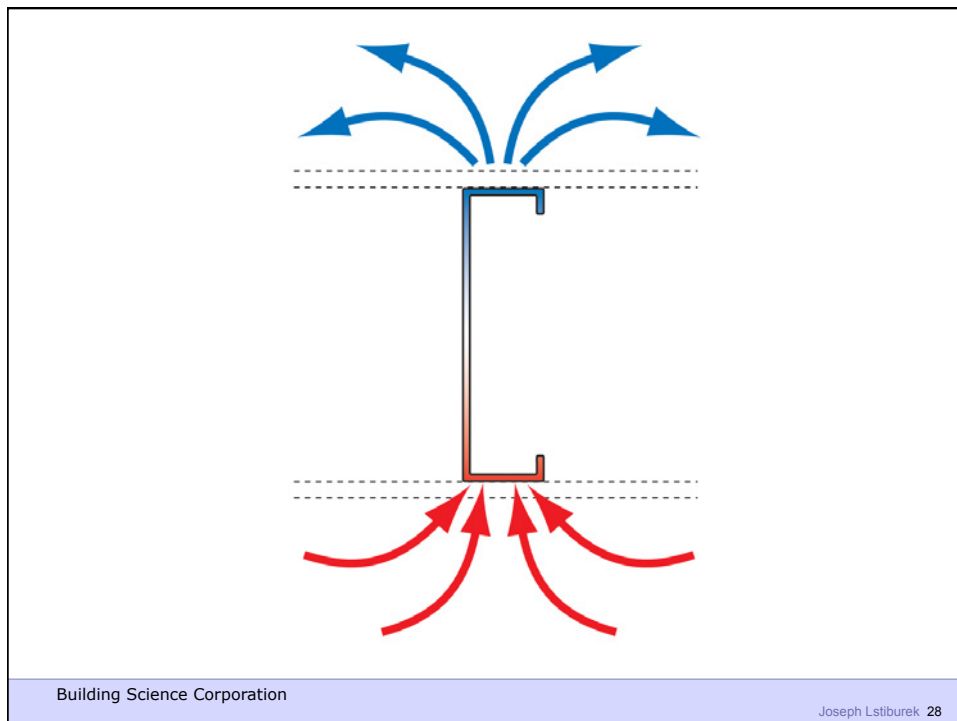
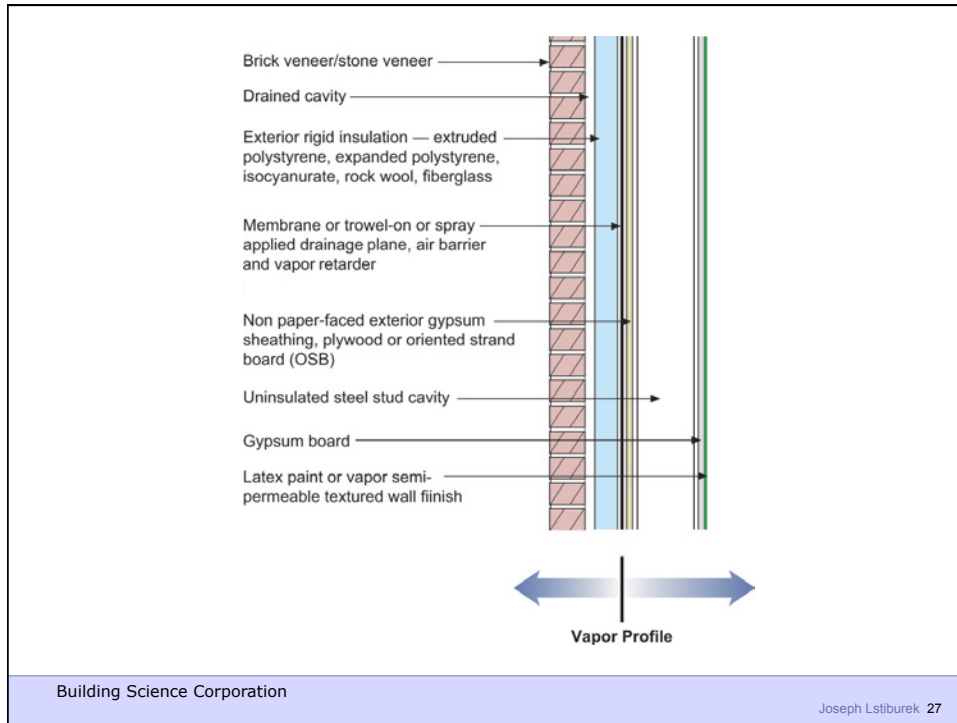

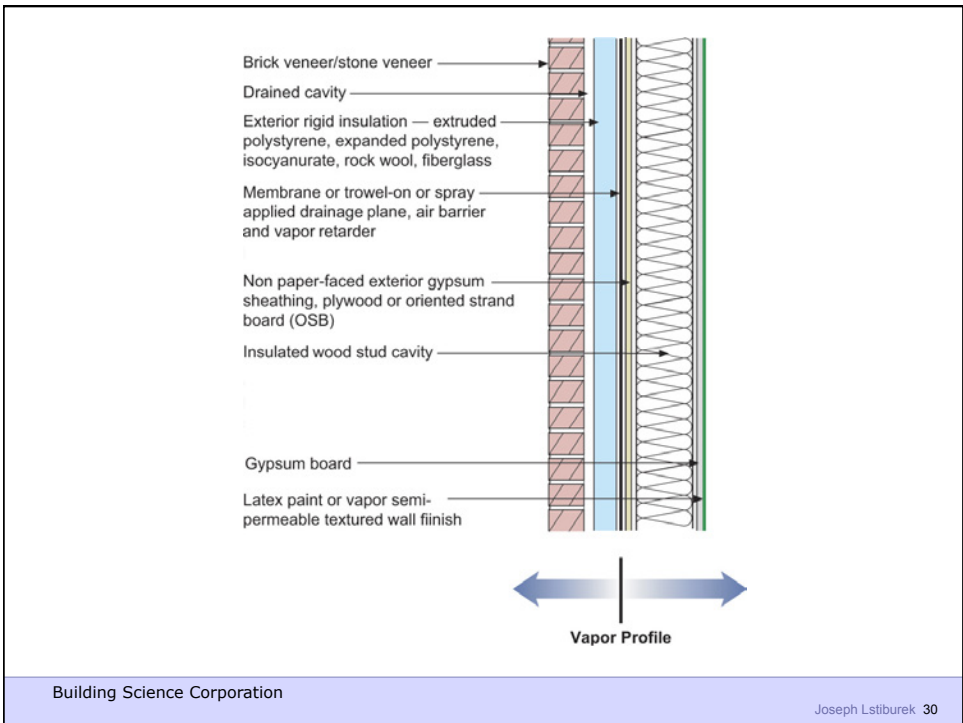

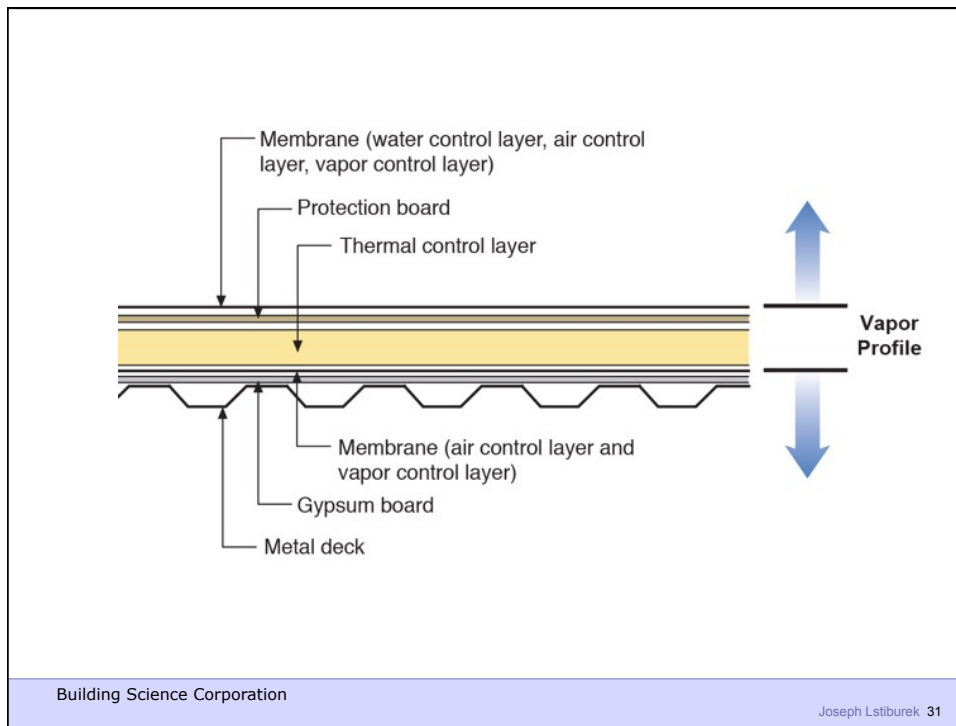

Commercial Enclosure: Simple Layers

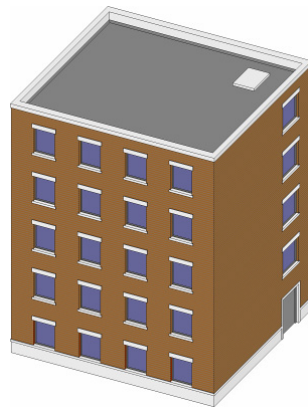

- Structure
- Rain/Air/Vapor
- Insulation
- Finish

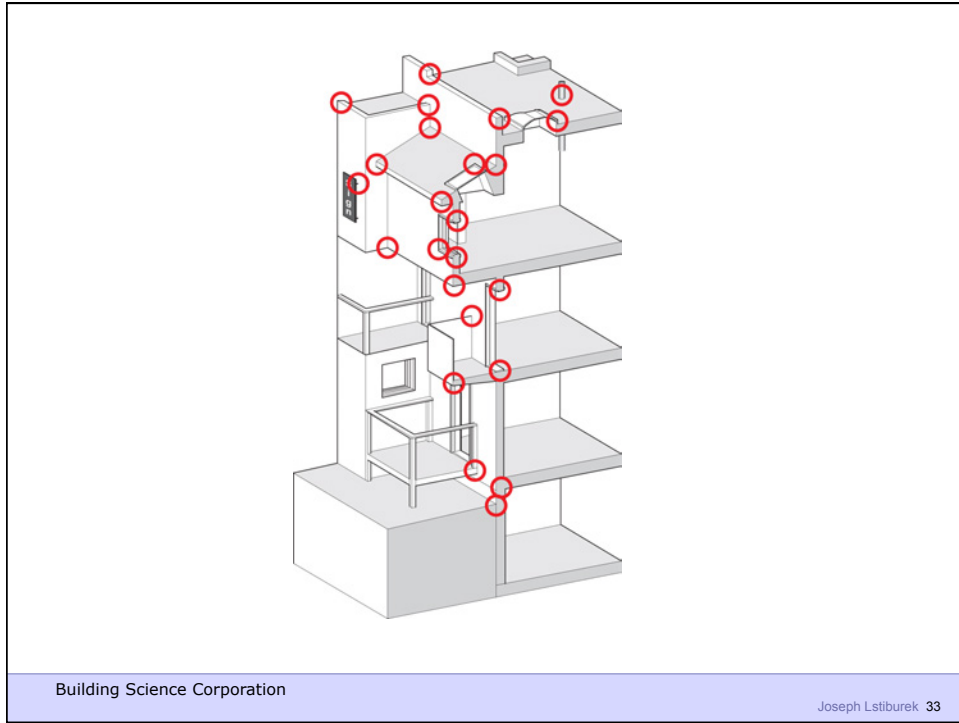











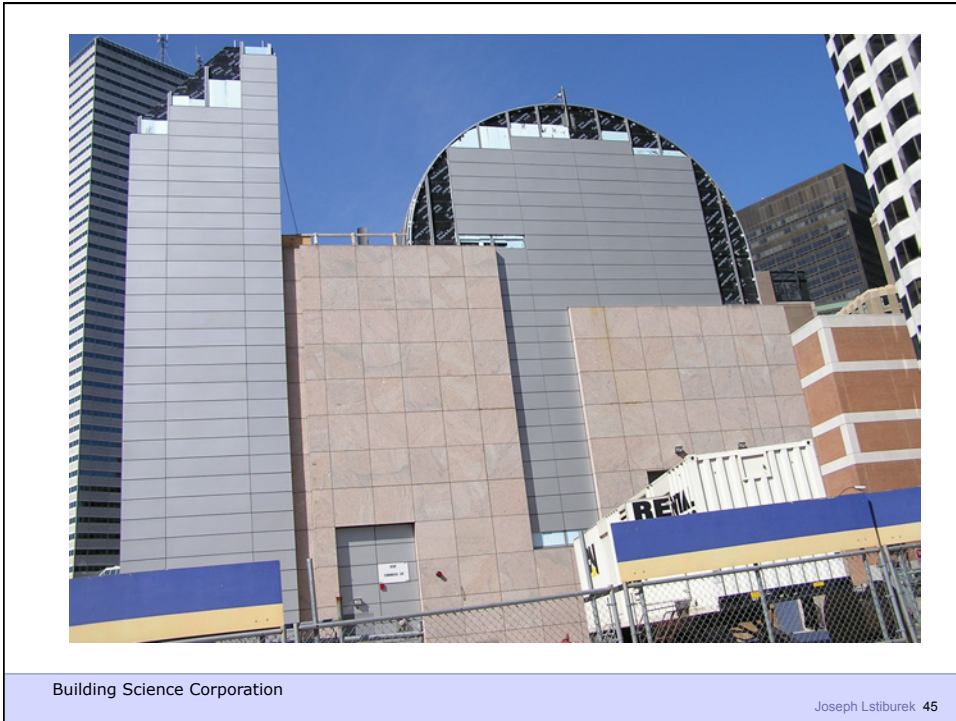

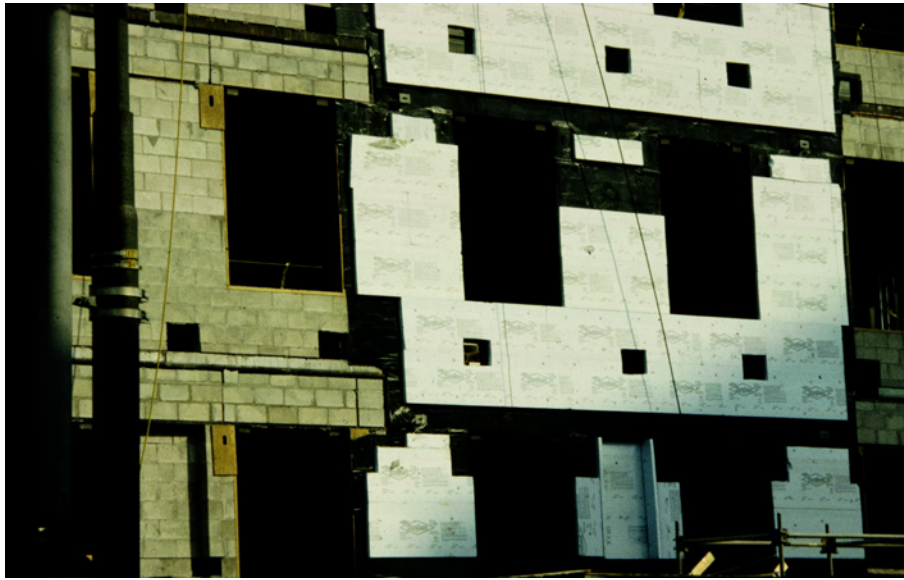

Building Science Corporation

Joseph Lstiburek 47



Building Science Corporation

Joseph Lstiburek 48



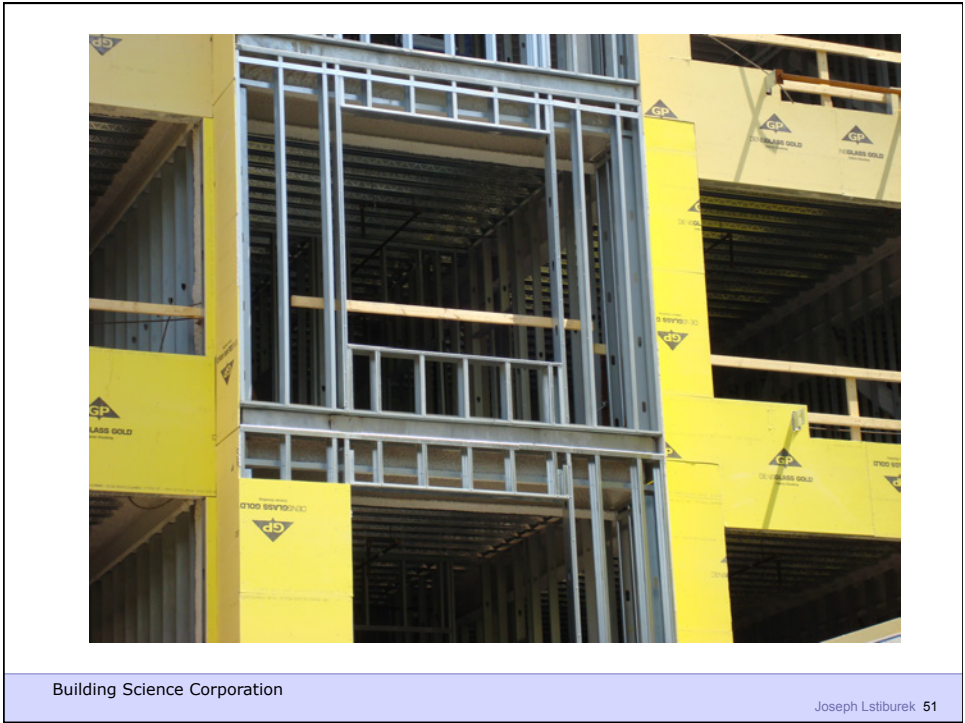





Building Science Corporation

Joseph Lstiburek 55



Building Science

Joseph Lstiburek 56



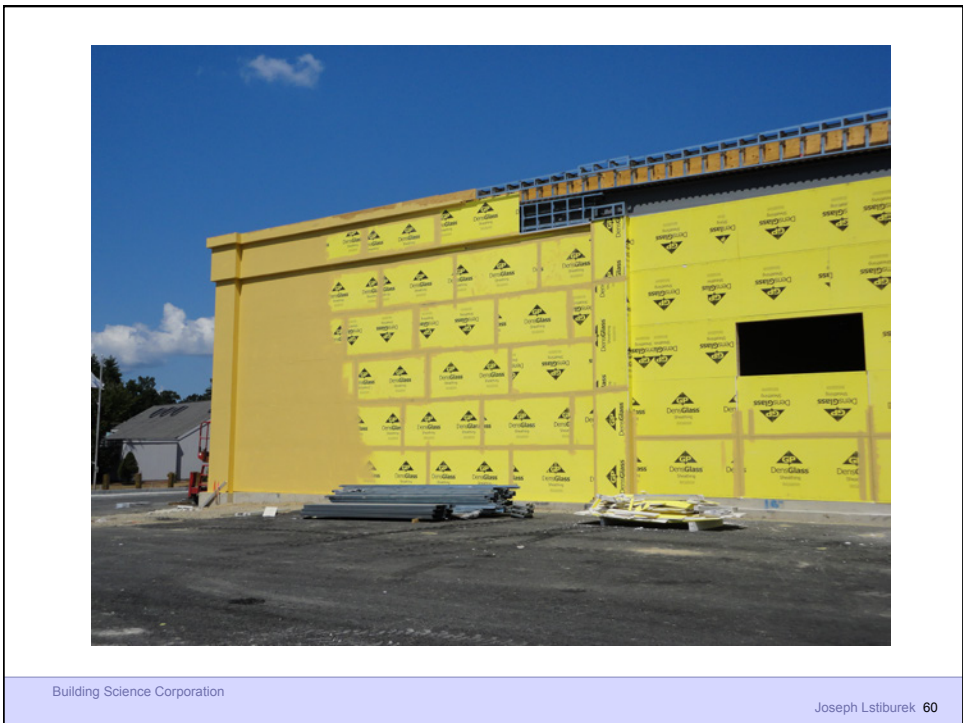



Building Science Corporation

Joseph Lstiburek 61



Building Science Corporation

Joseph Lstiburek 62

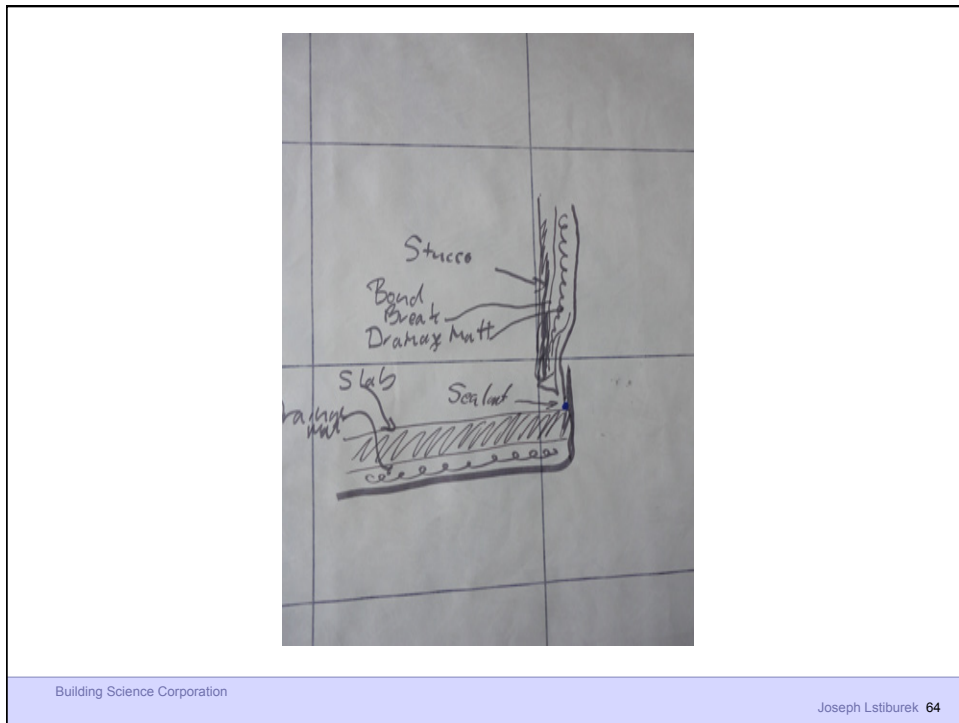
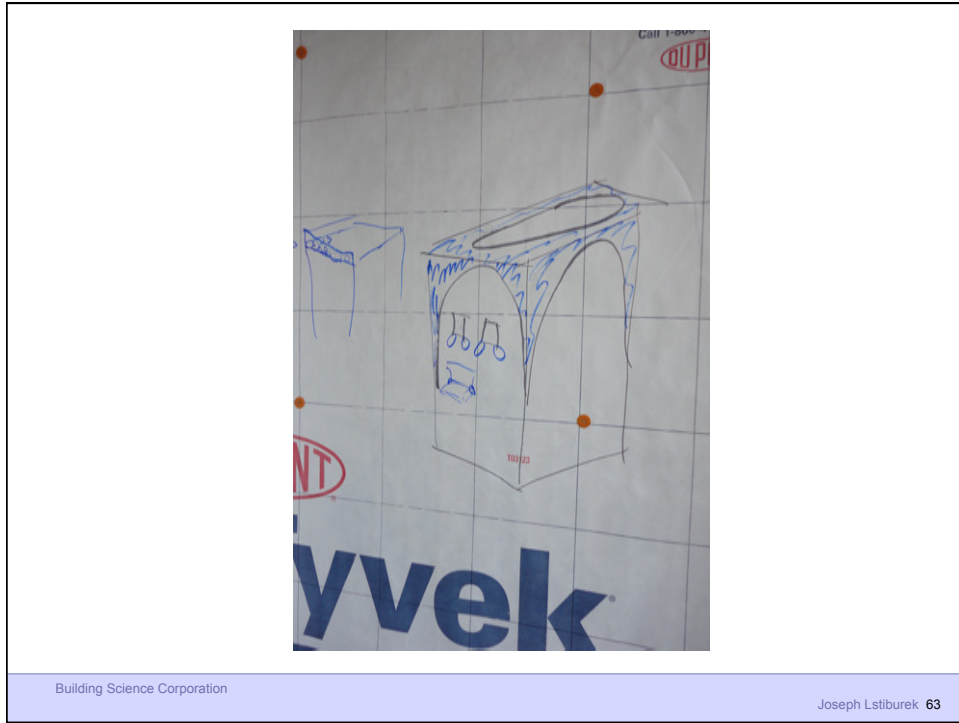





Building Science Corporation

Joseph Lstiburek 67



Building Science Corporation

Joseph Lstiburek 68



Building Science 2009

Joseph Lstiburek – HVAC 69



Building Science Corporation

Joseph Lstiburek 70



Building Science Corporation

Joseph Lstiburek 71



Building Science 2009

Joseph Lstiburek – HVAC 72

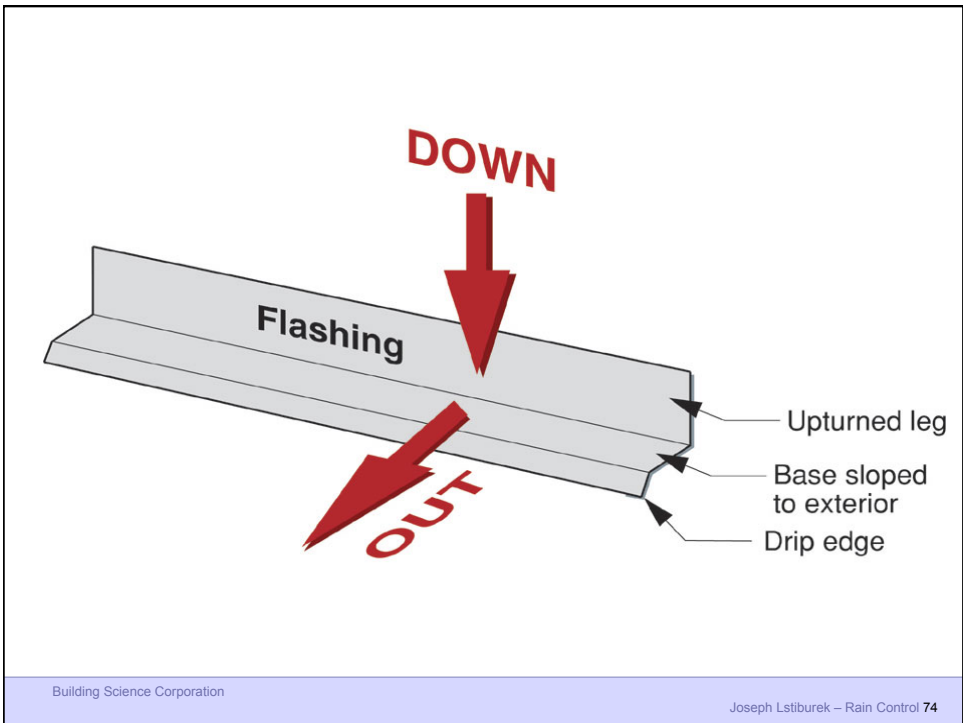

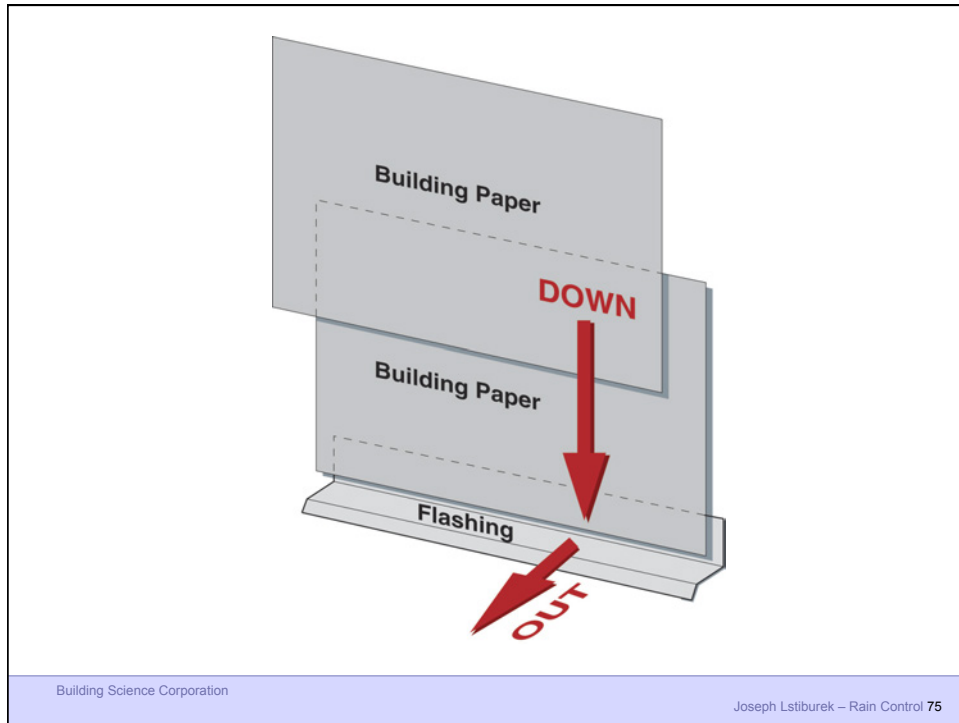





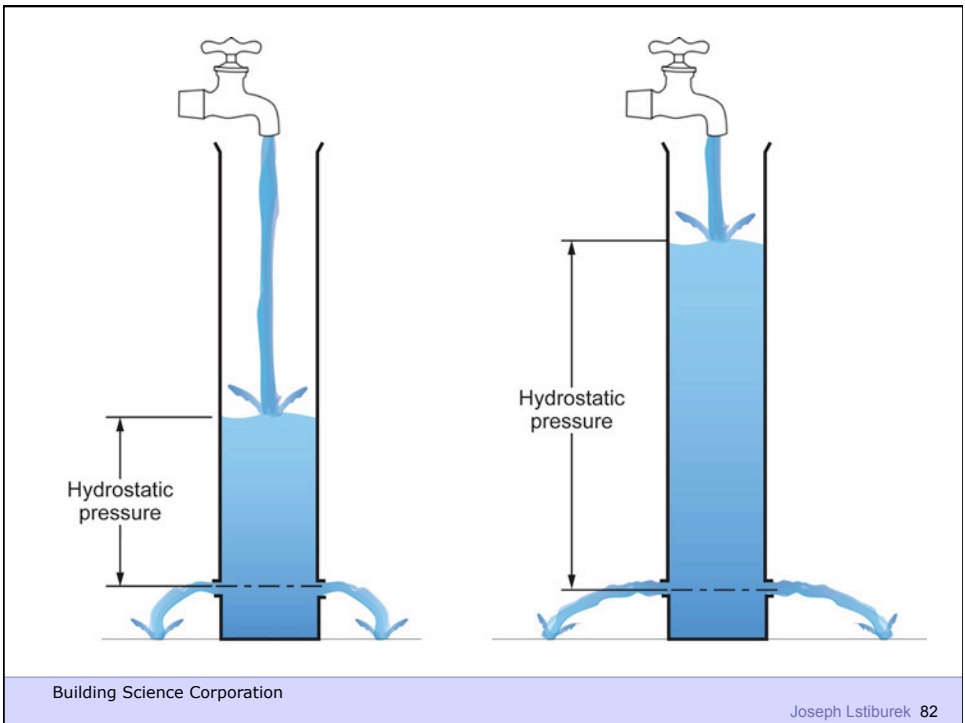



Building Science Corporation

Joseph Lstiburek 83

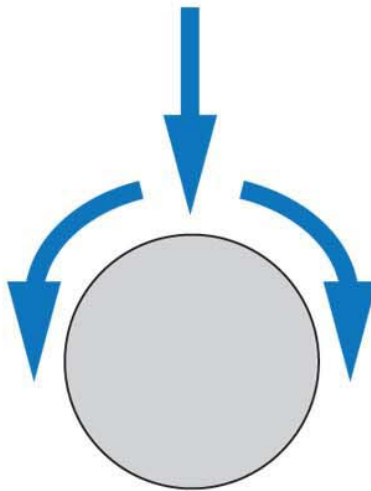

Building Science Corporation

Joseph Lstiburek 84

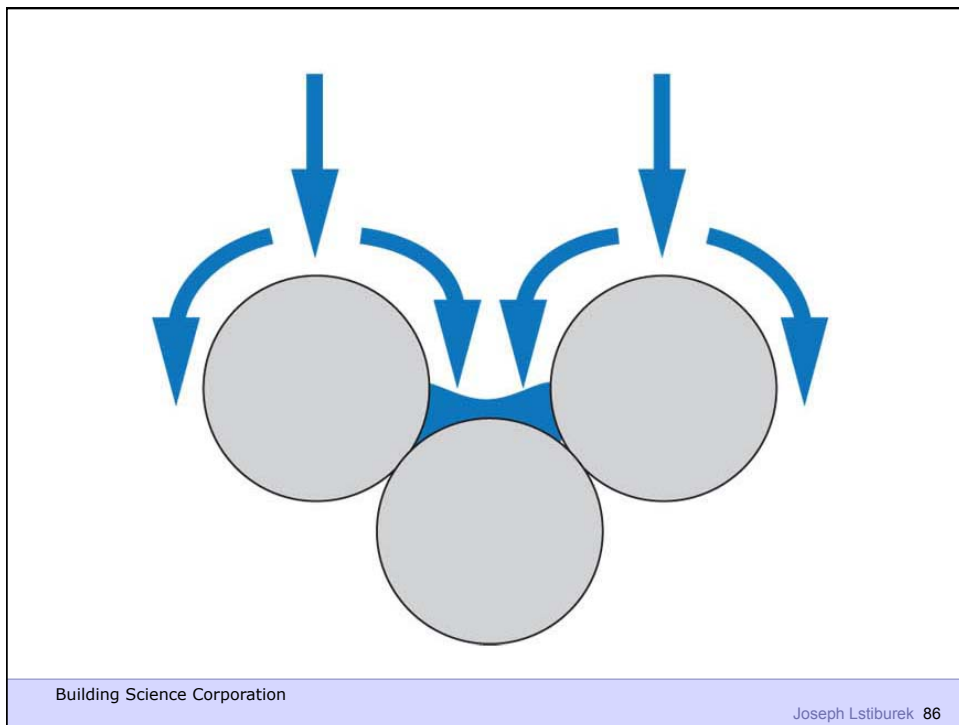
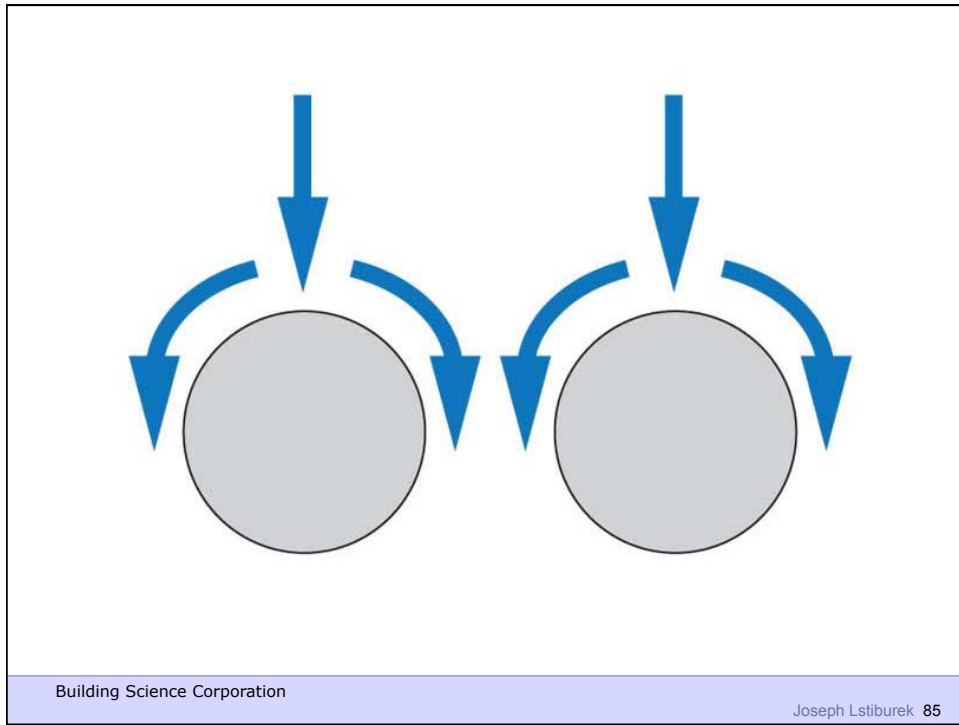



Building Science Corporation

Joseph Lstiburek 87

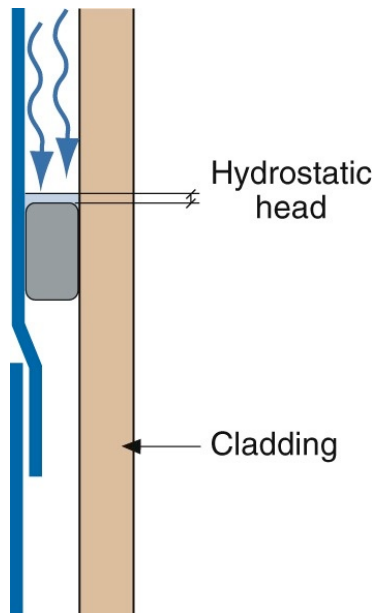

Building Science Corporation

Joseph Lstiburek 88

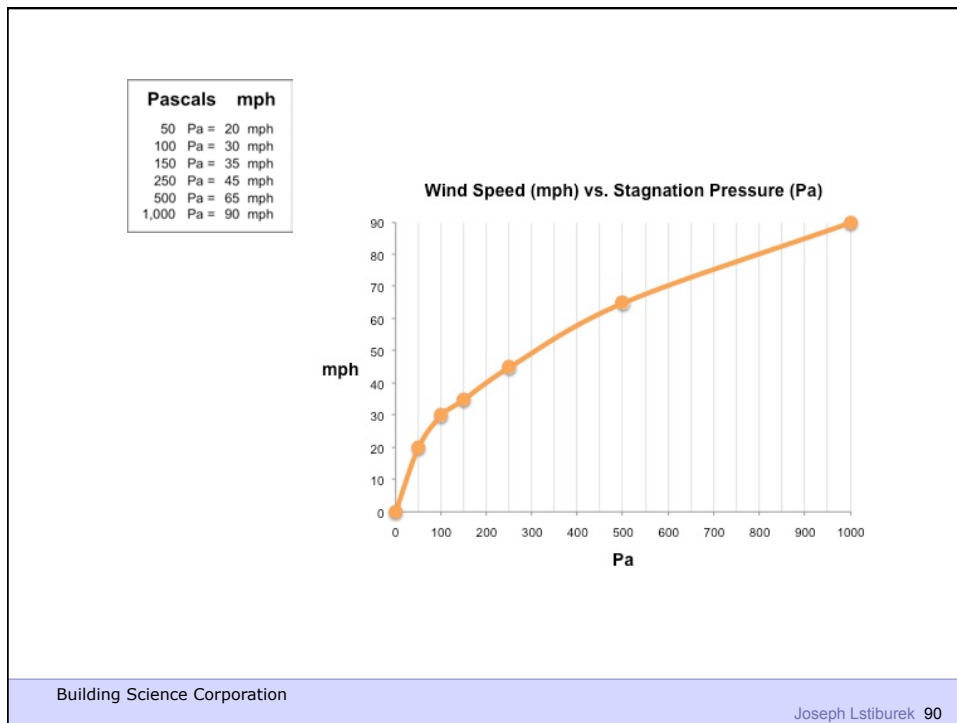
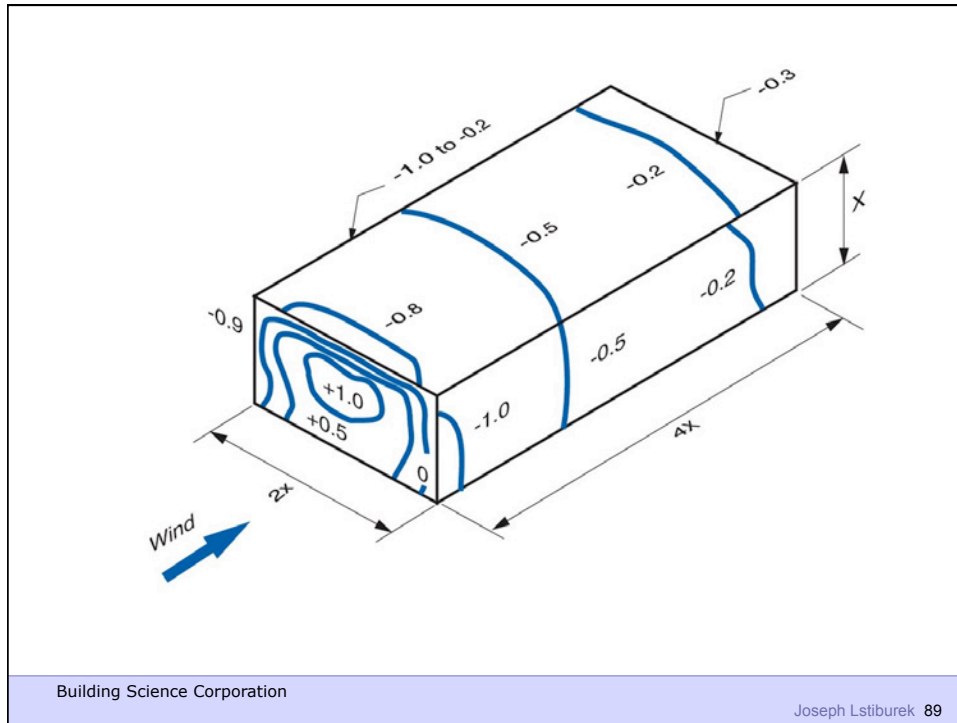



Building Science Corporation

Joseph Lstiburek 91



Building Science Corporation

Joseph Lstiburek – Rain Control 92

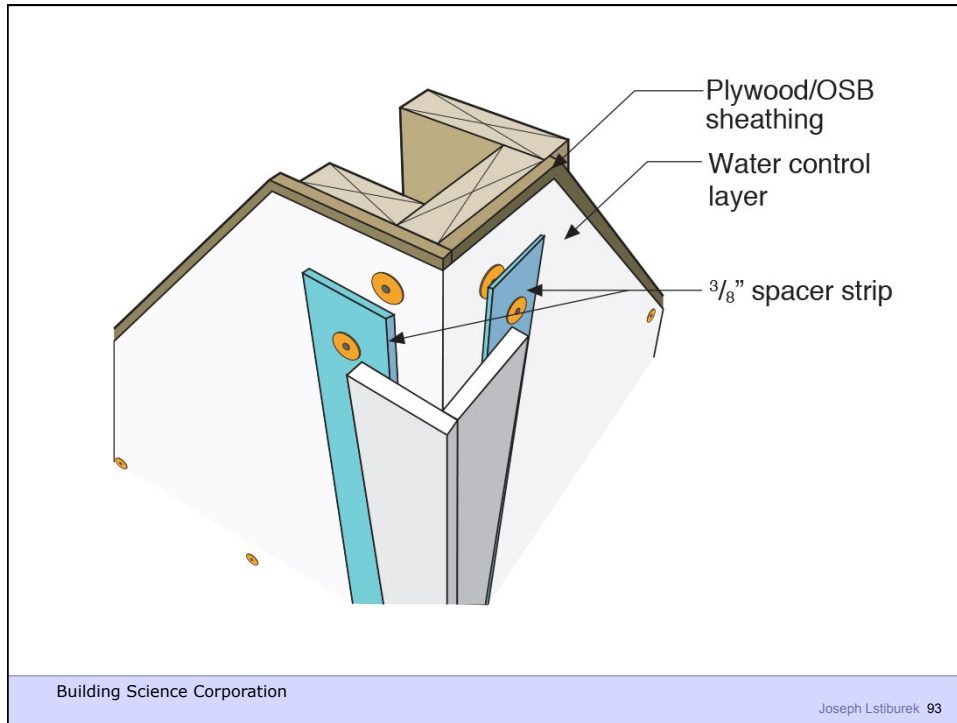



Building Science Corporation

Joseph Lstiburek 95

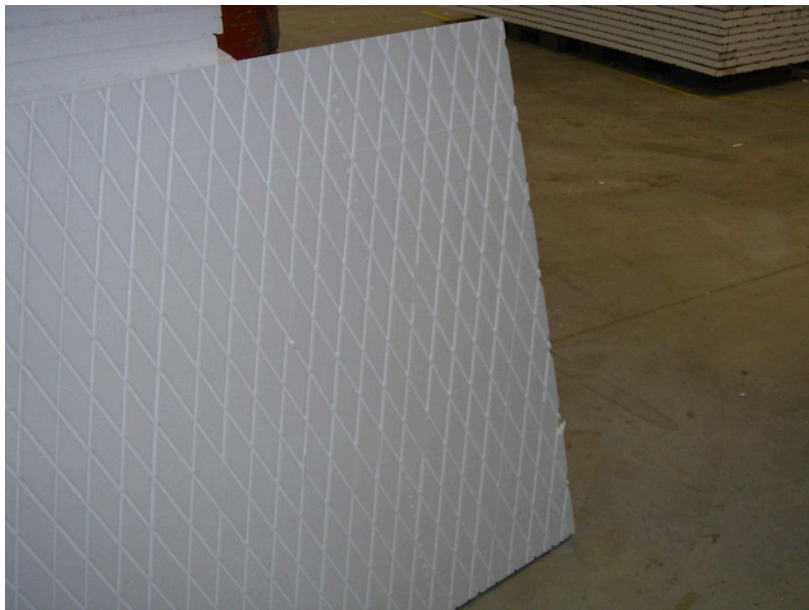

Building Science Corporation

Joseph Lstiburek 96

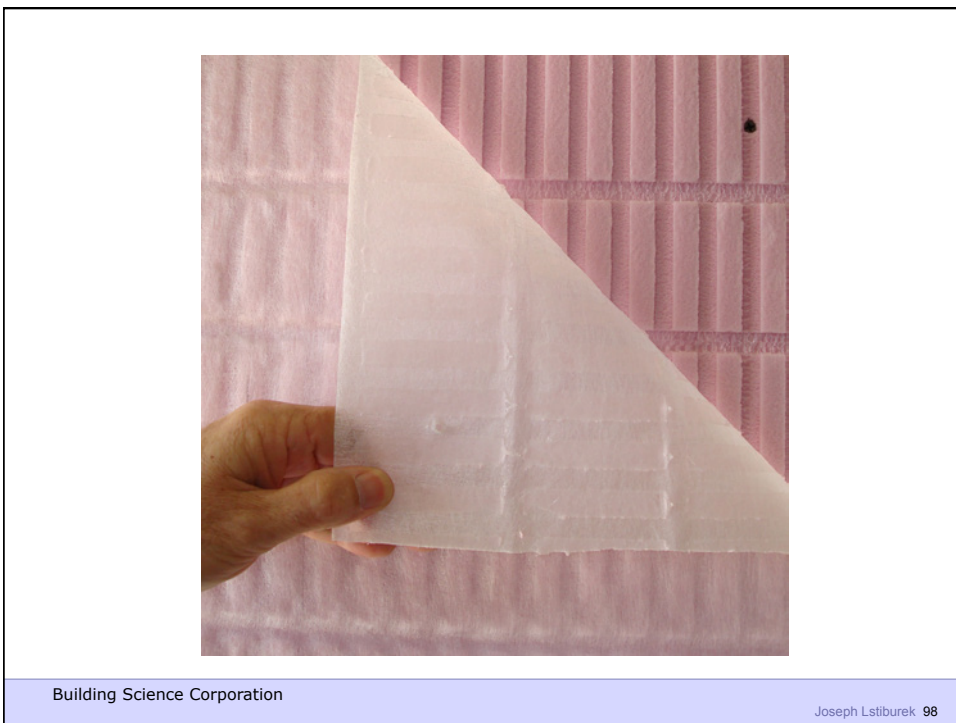



Rain Screen

Building Science Corporation

Joseph Lstiburek 101

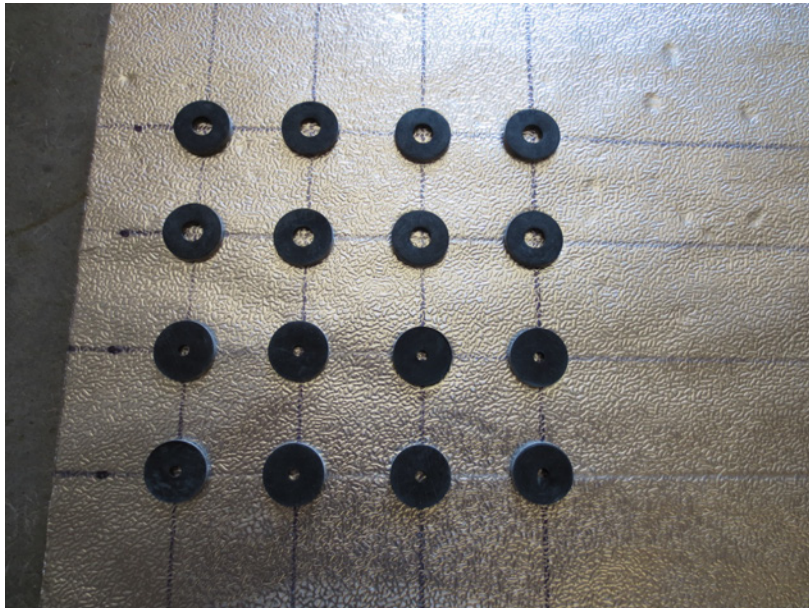

Building Science Corporation

Joseph Lstiburek 102

Beer Screen?

Building Science Corporation

Joseph Lstiburek 103

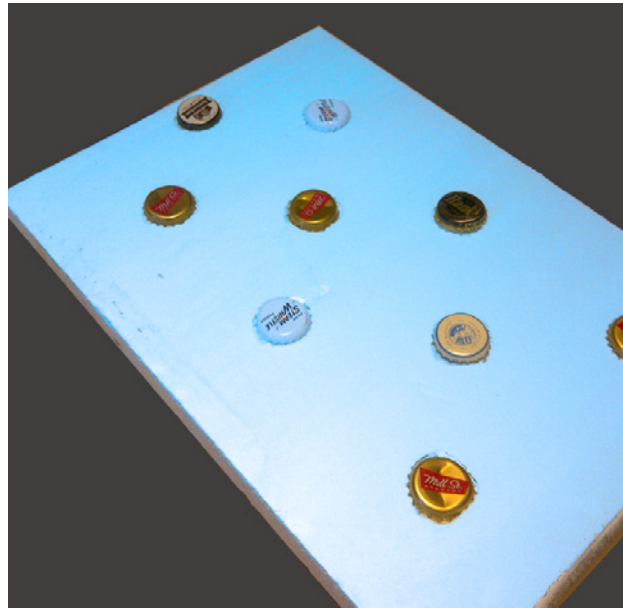

Building Science Corporation

Joseph Lstiburek 104

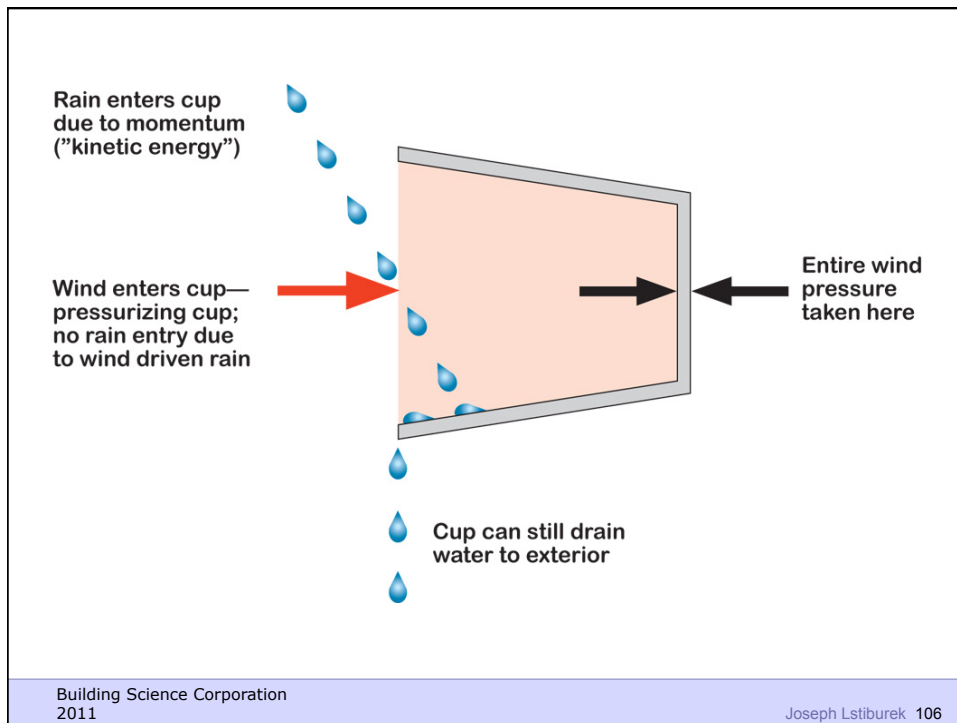
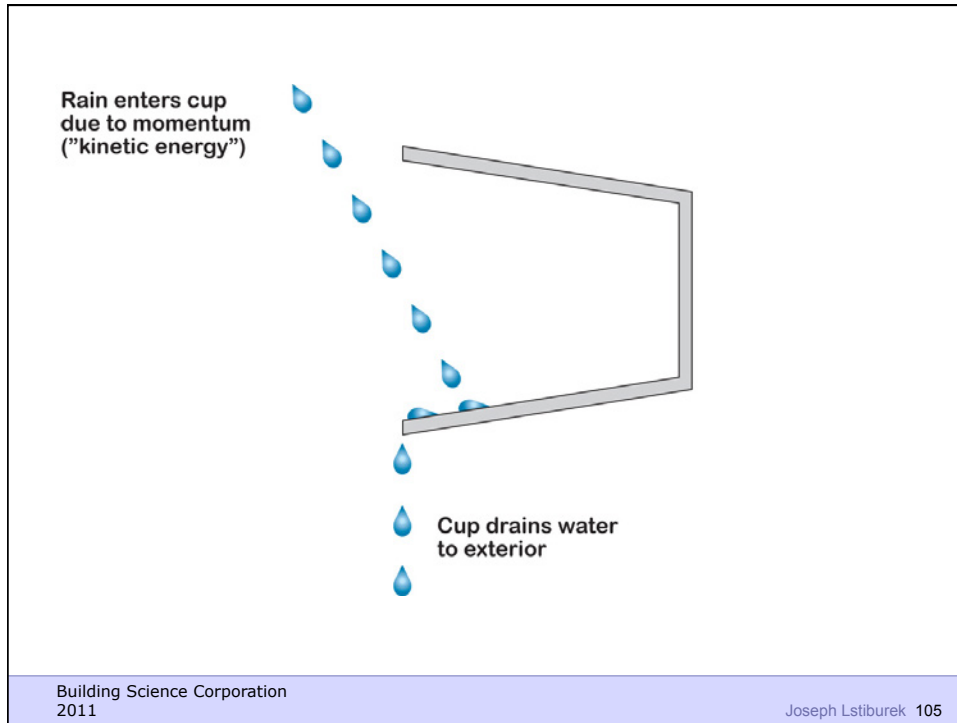

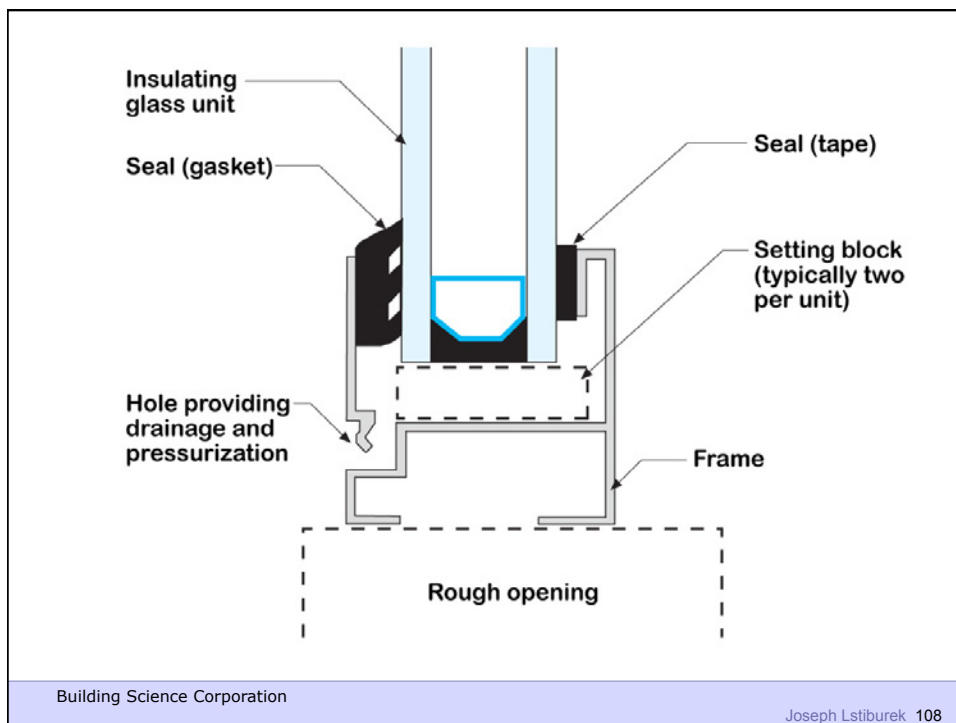
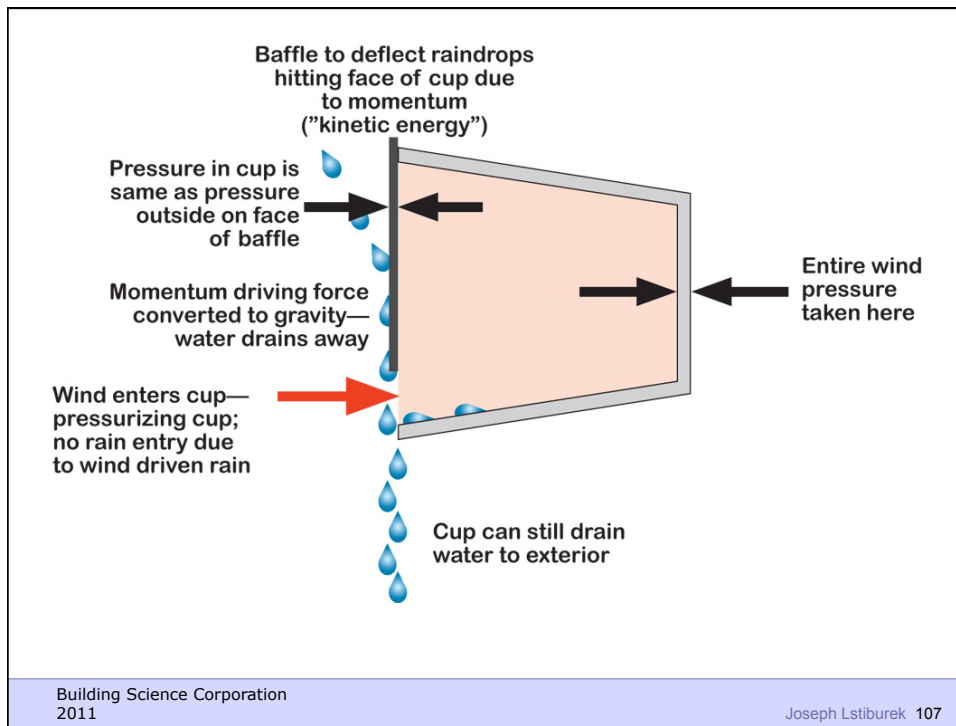

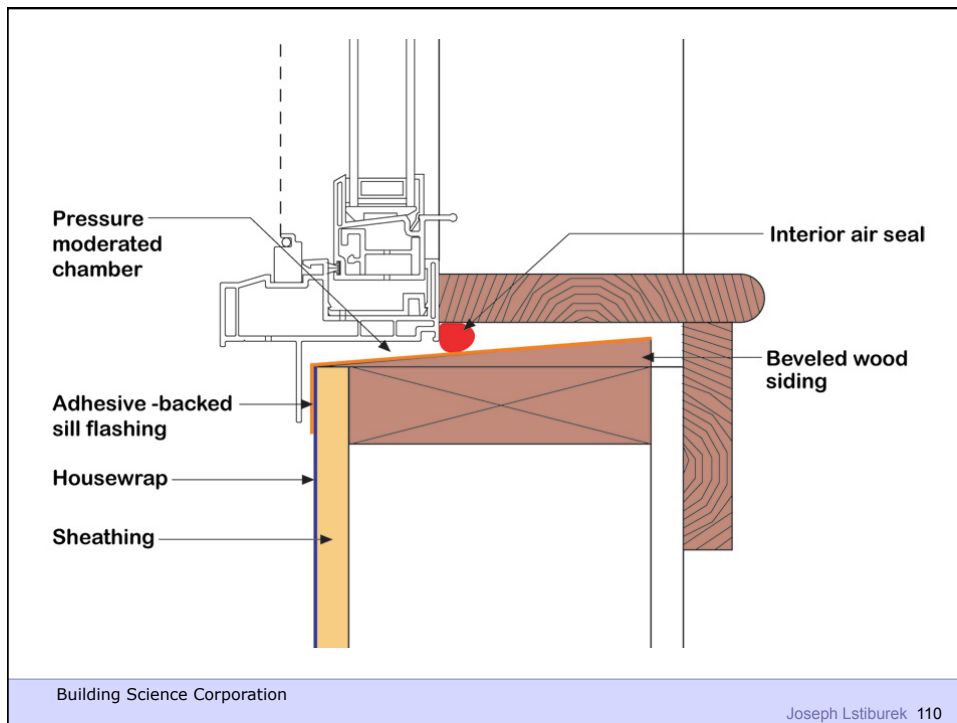
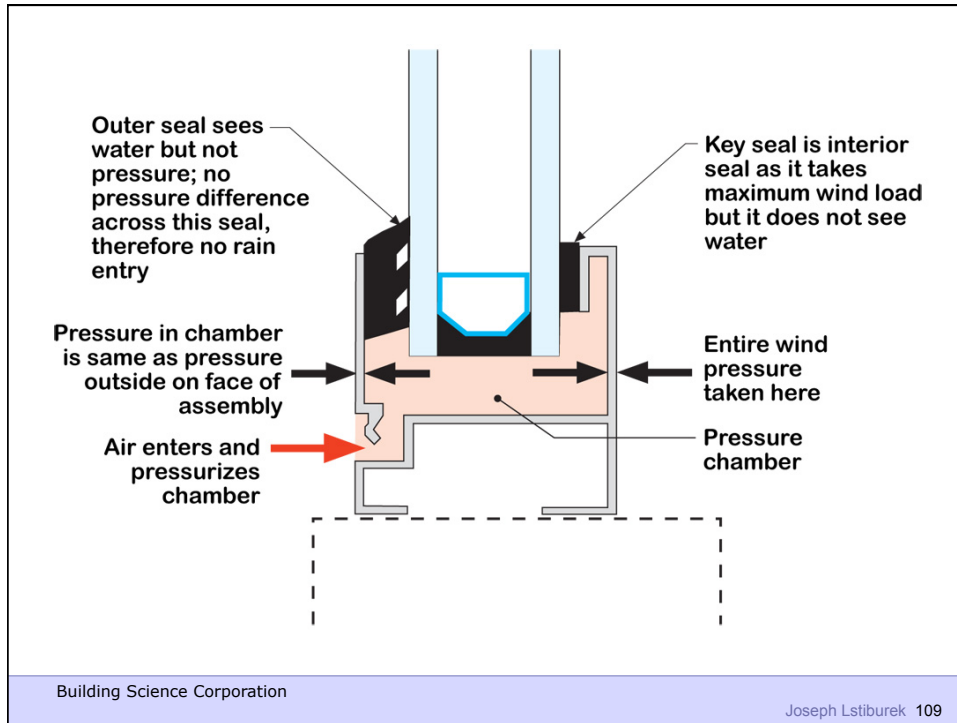



Building Science Corporation

Joseph Lstiburek 111



Building Science Corporation

Joseph Lstiburek 112

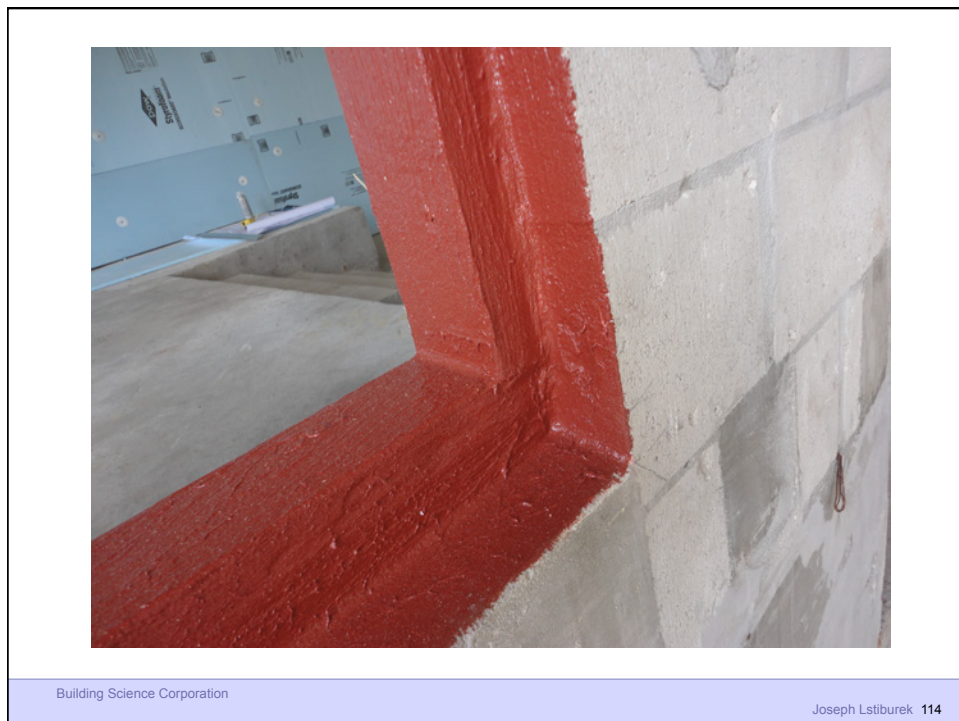

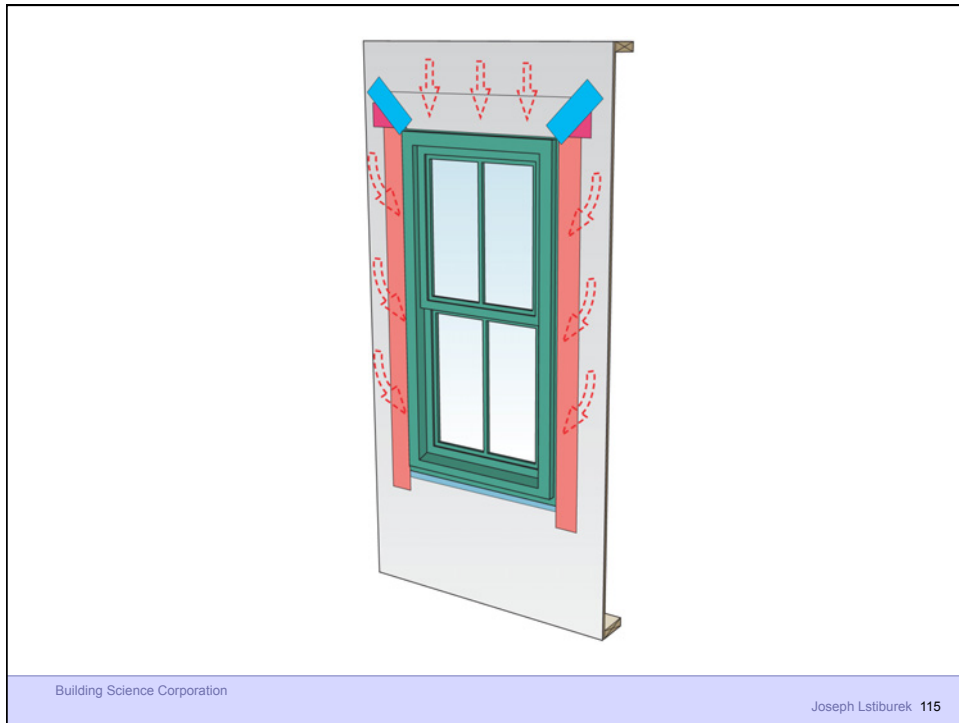

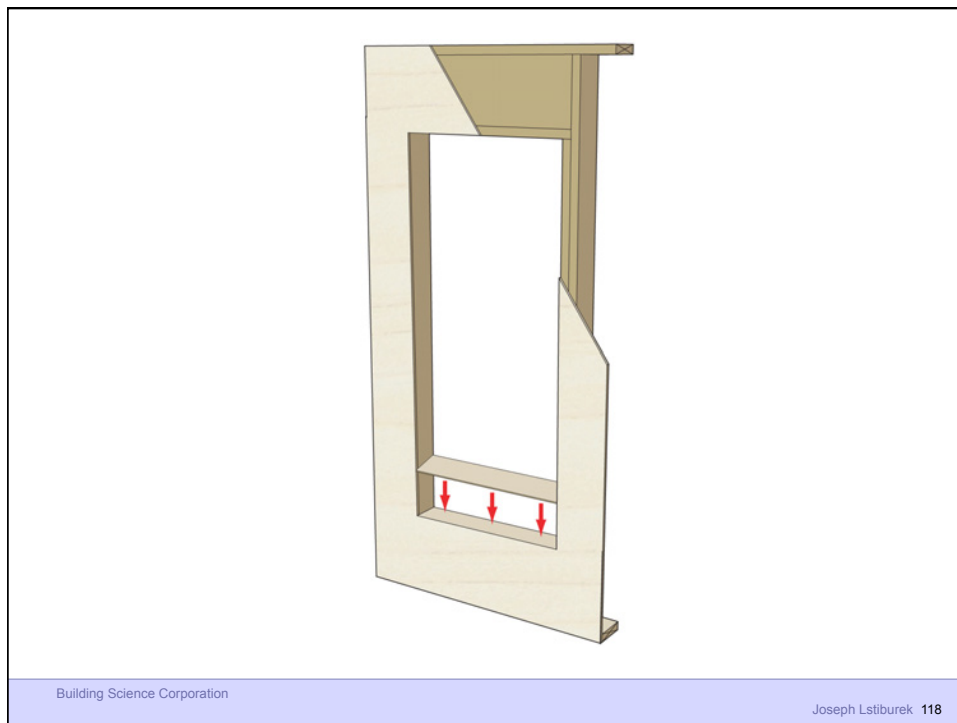
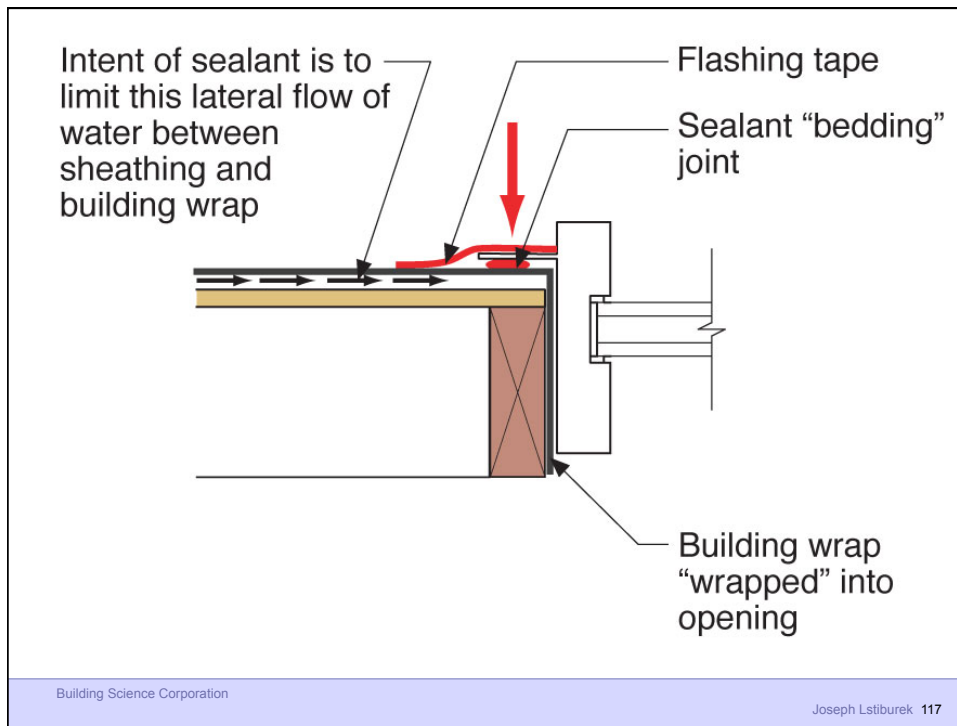

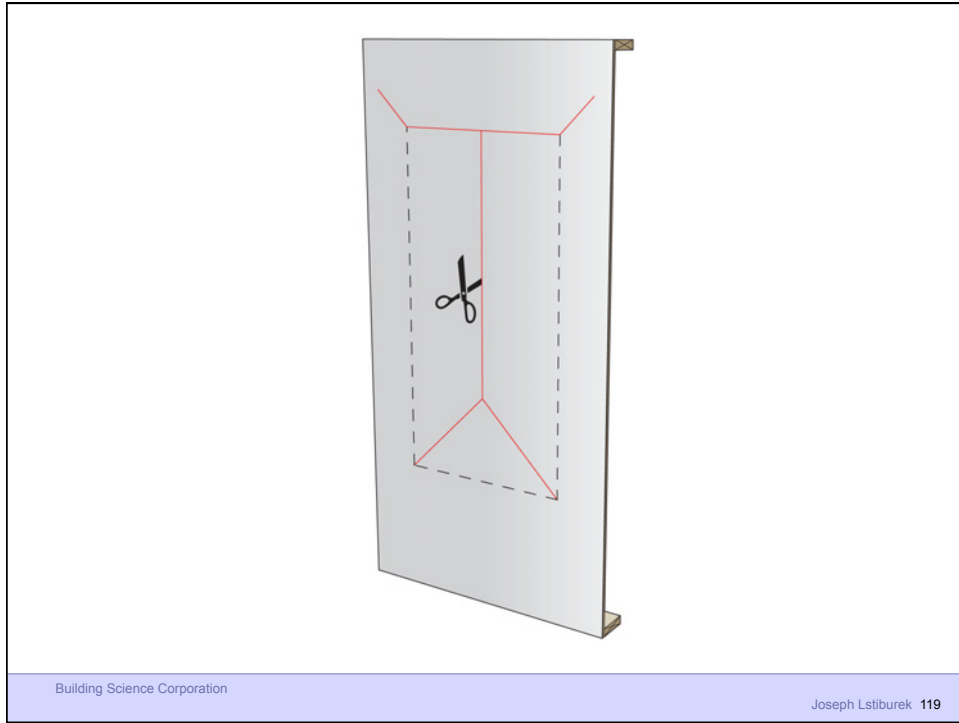

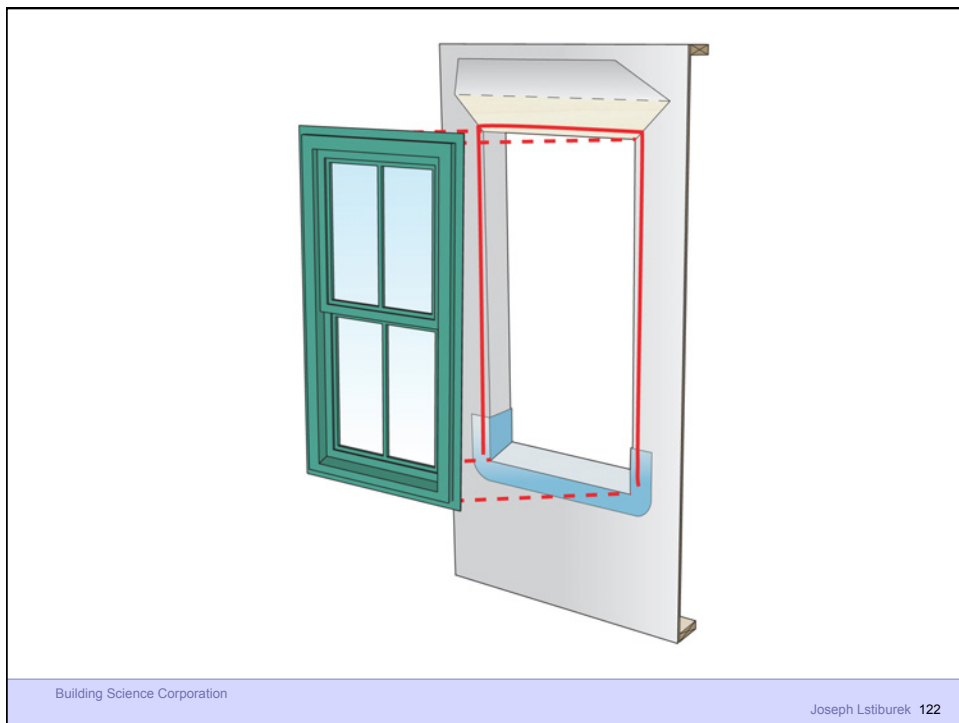
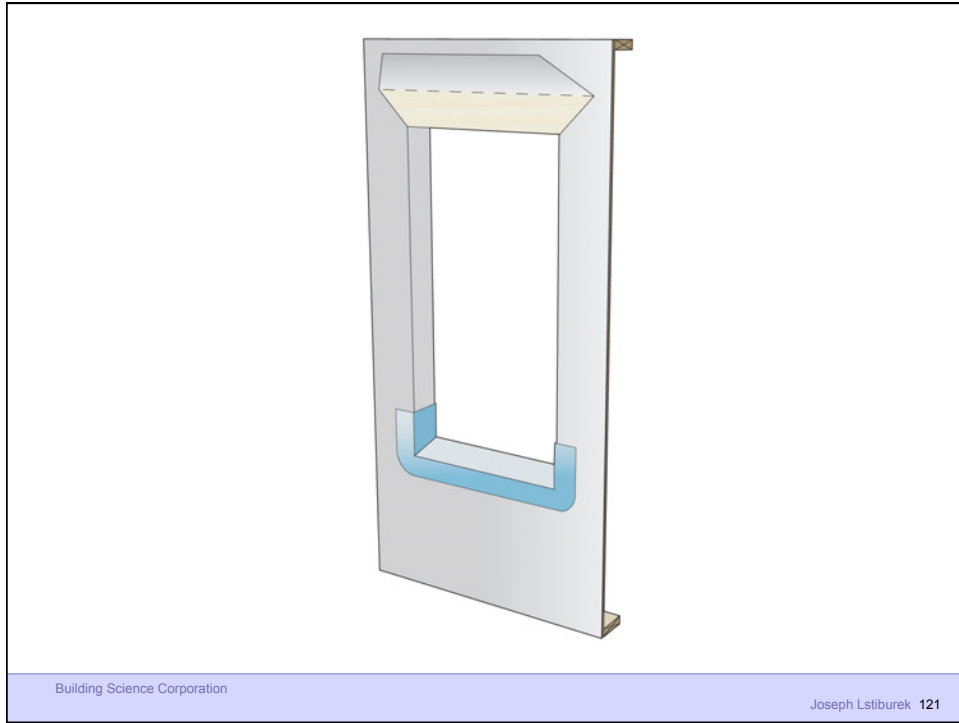

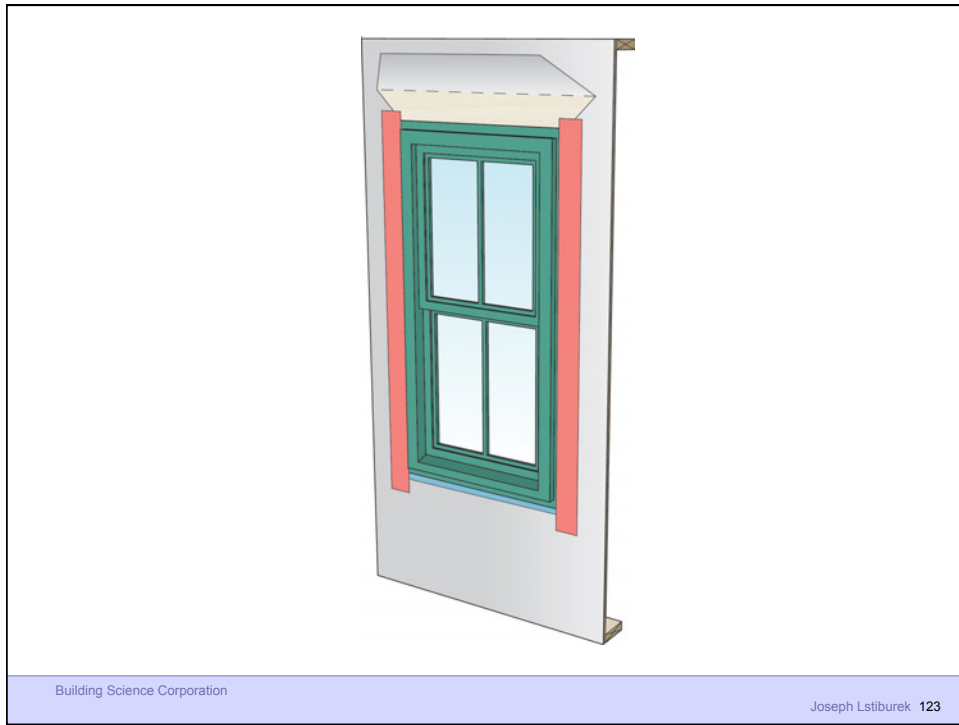

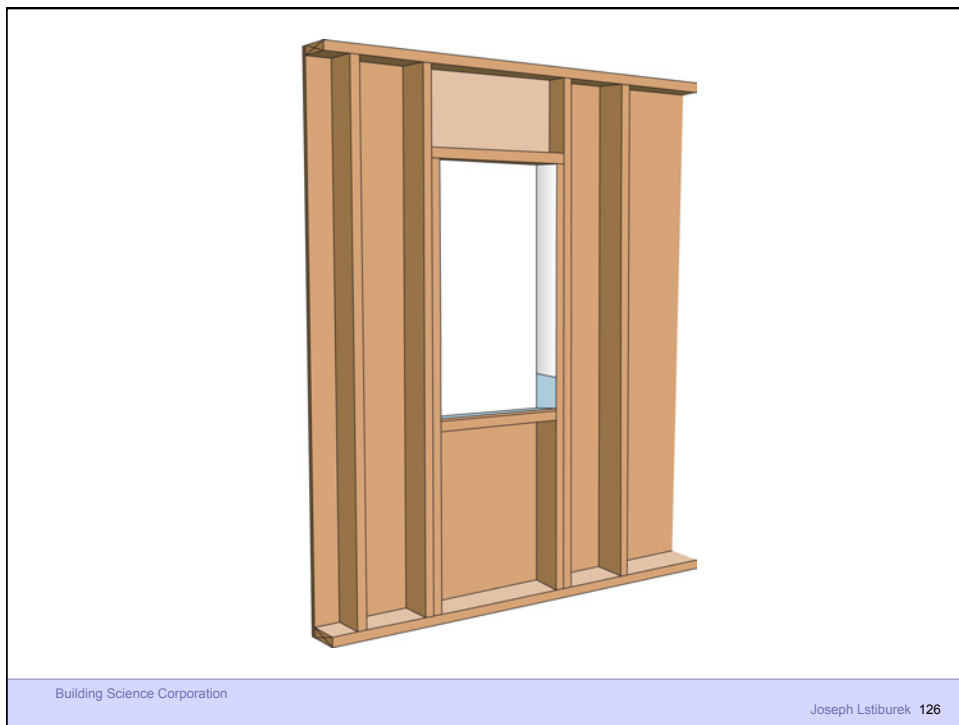
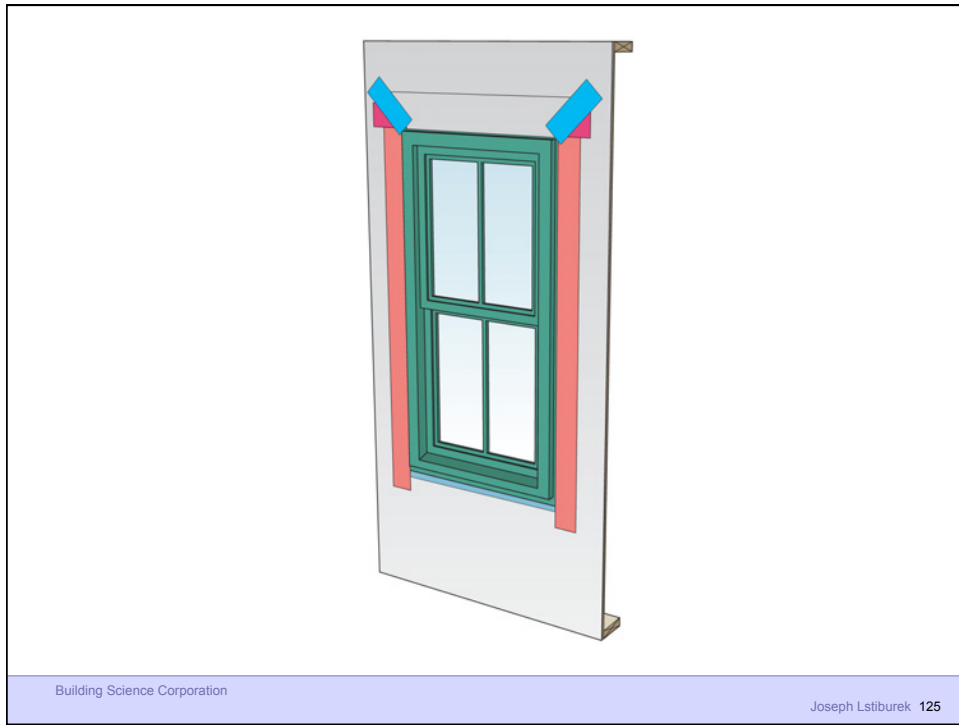

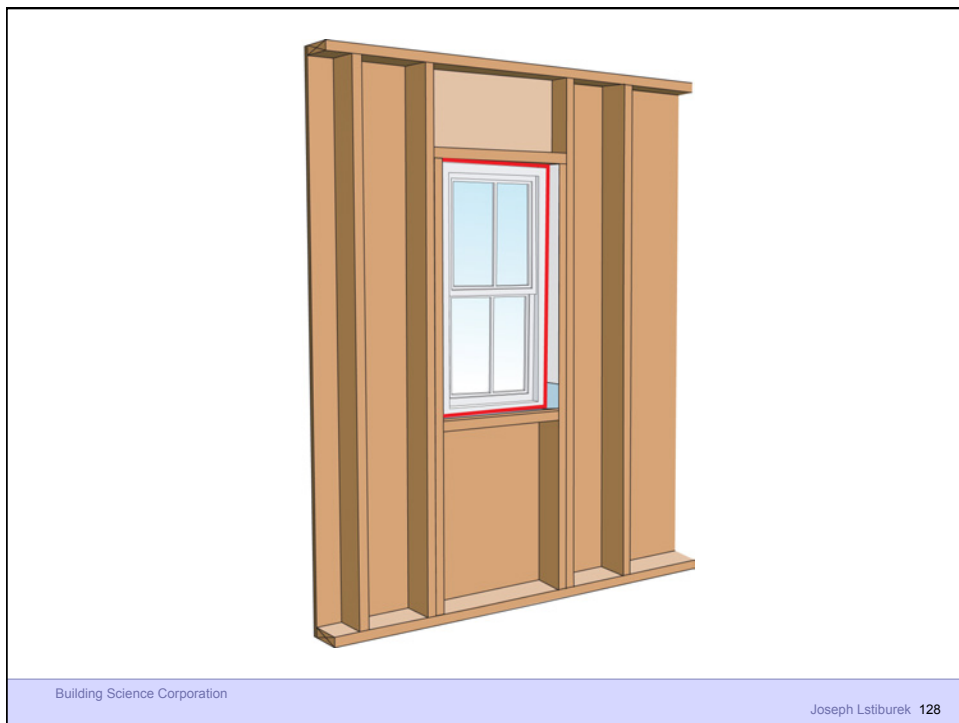
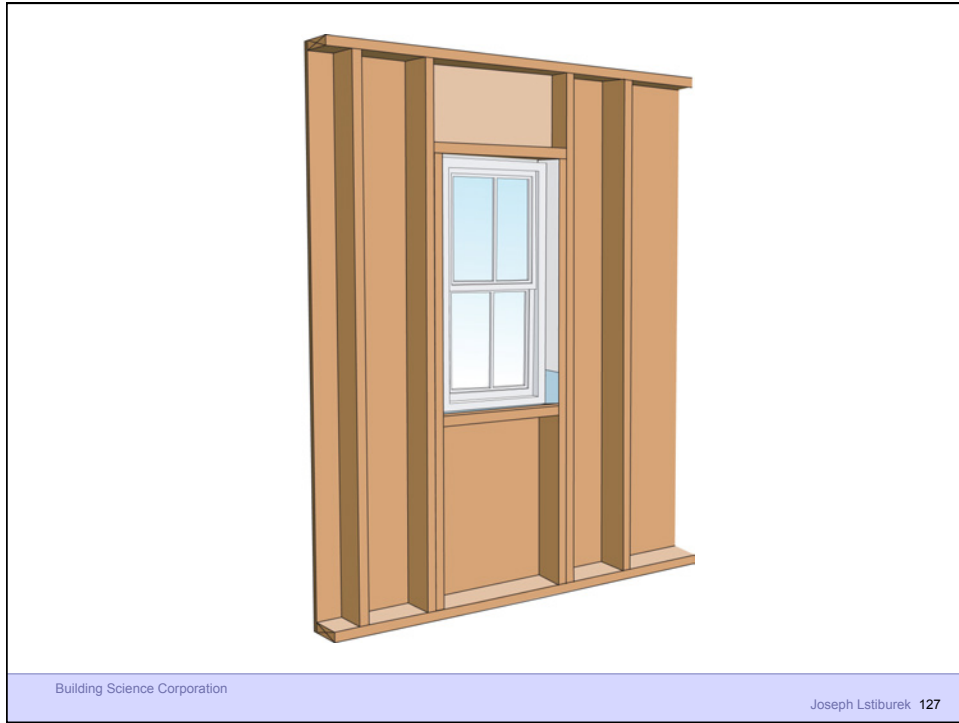



Building Science Corporation

Joseph Lstiburek 129



Building Science Corporation

Joseph Lstiburek 130

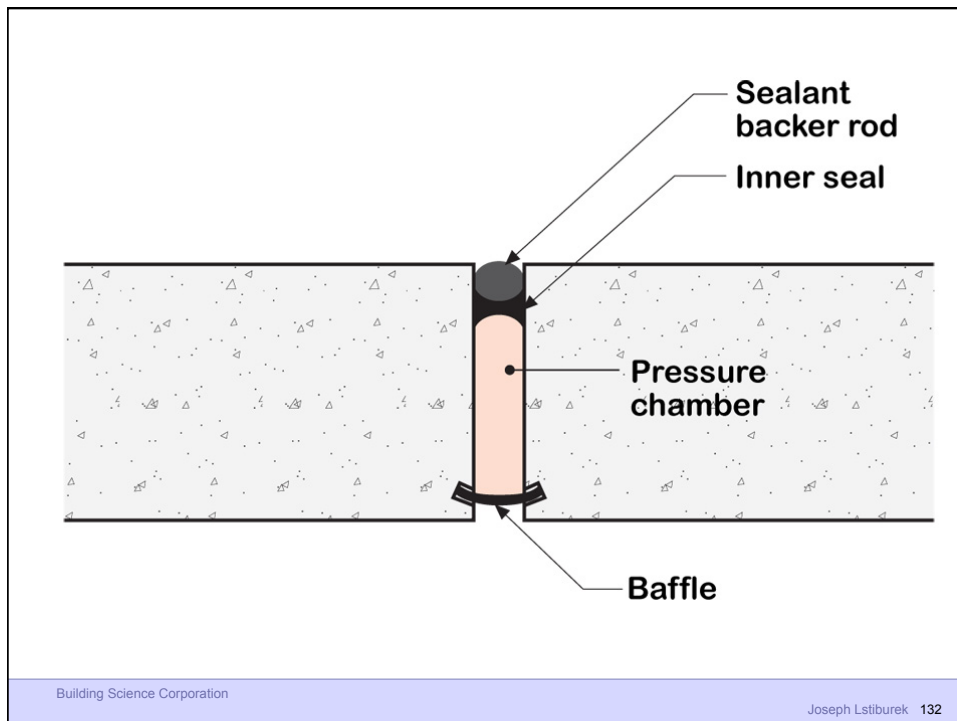
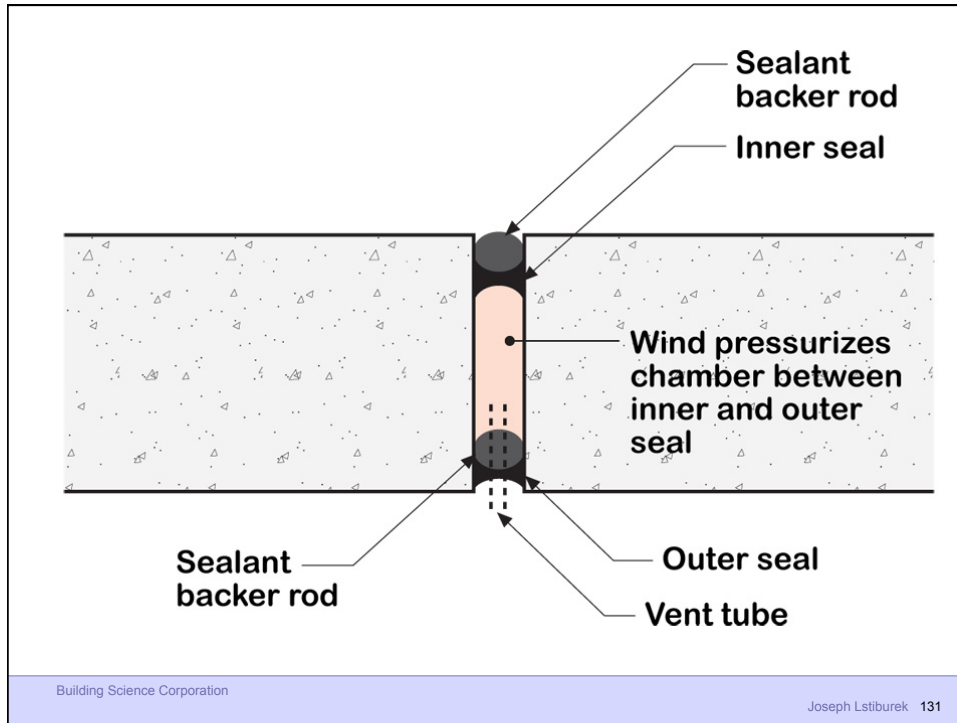

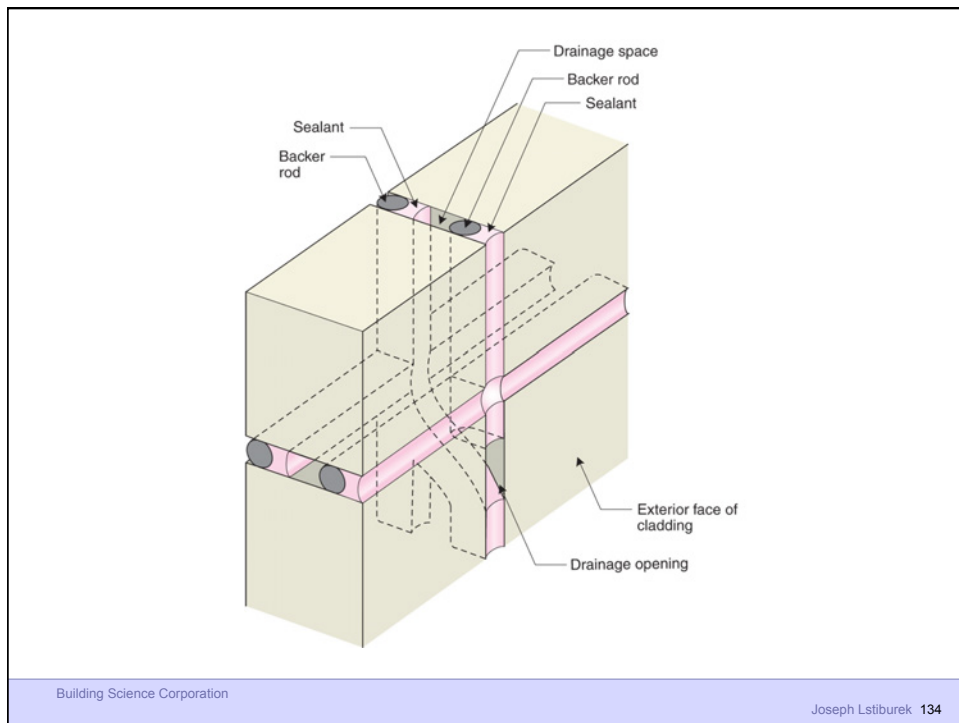
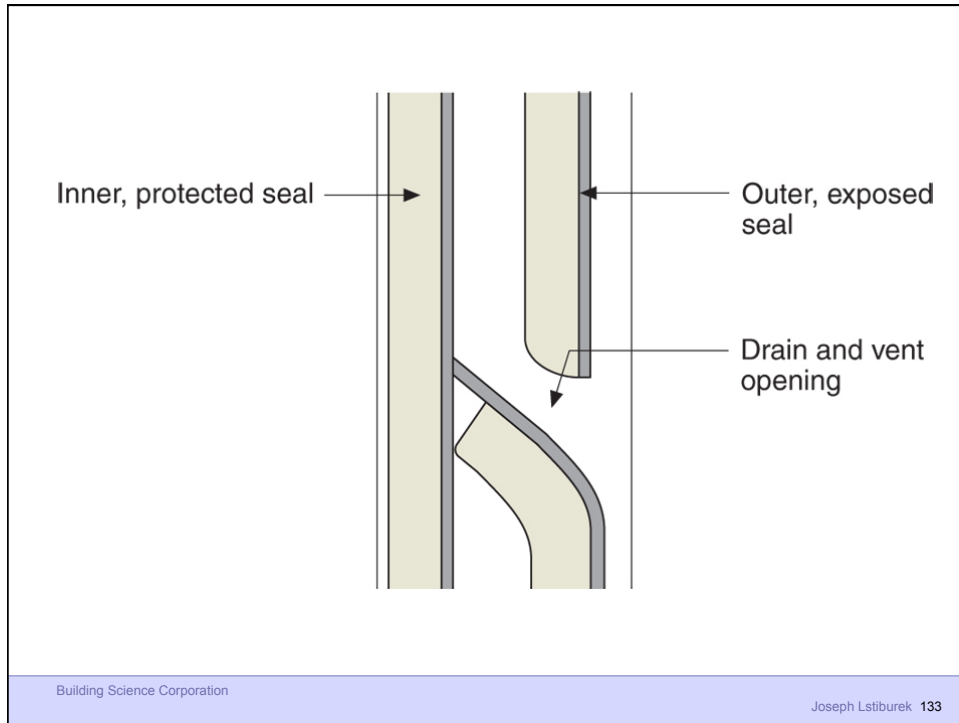





Building Science Corporation

Joseph Lstiburek 137



Building Science Corporation

Joseph Lstiburek 138

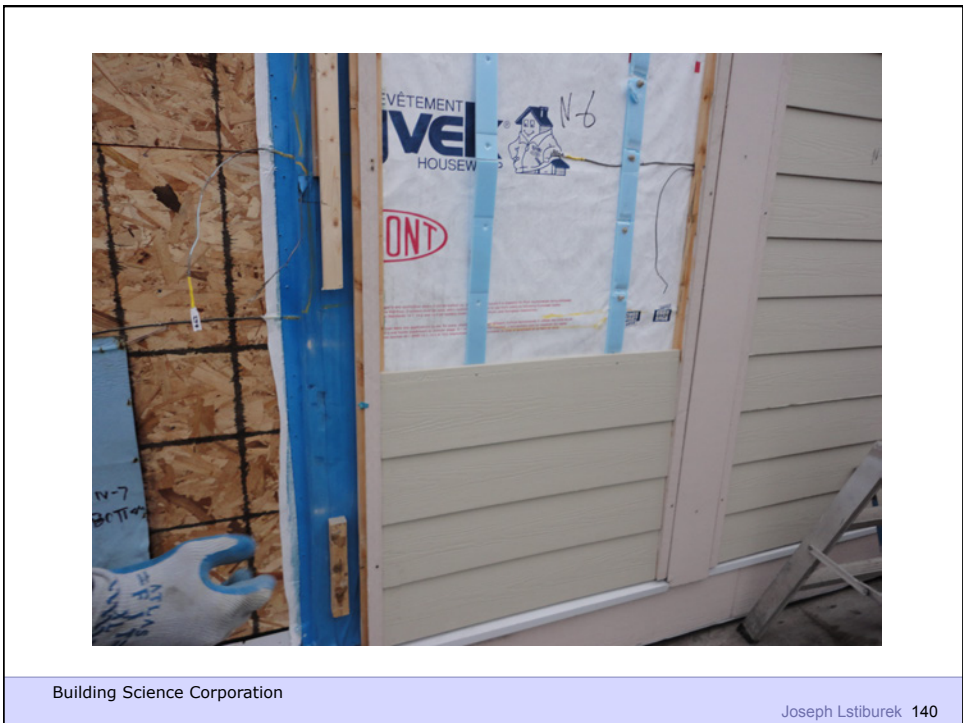



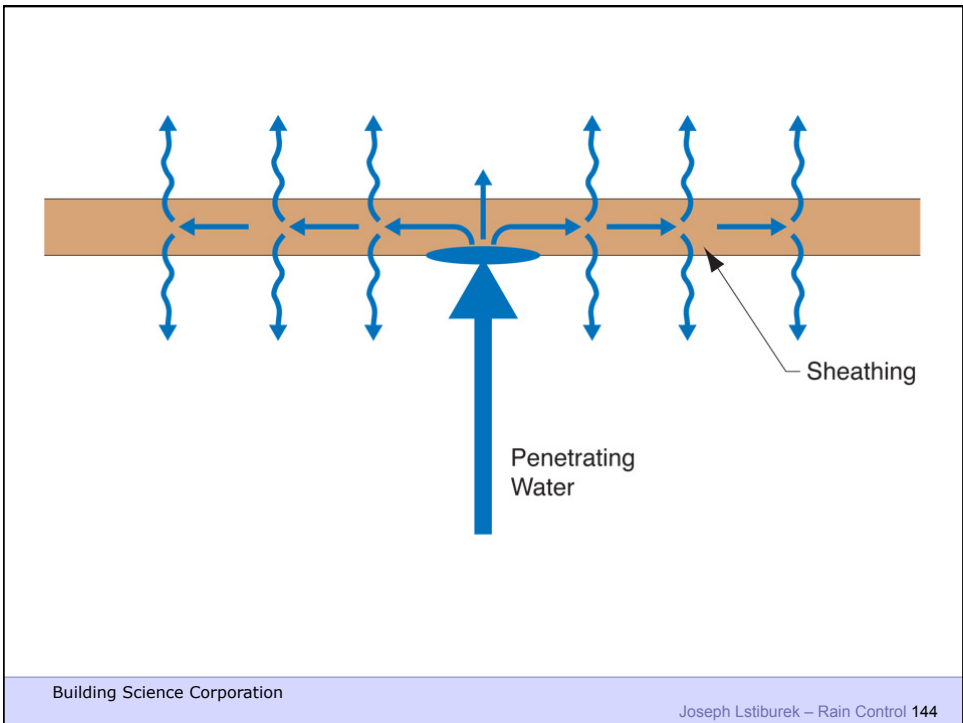

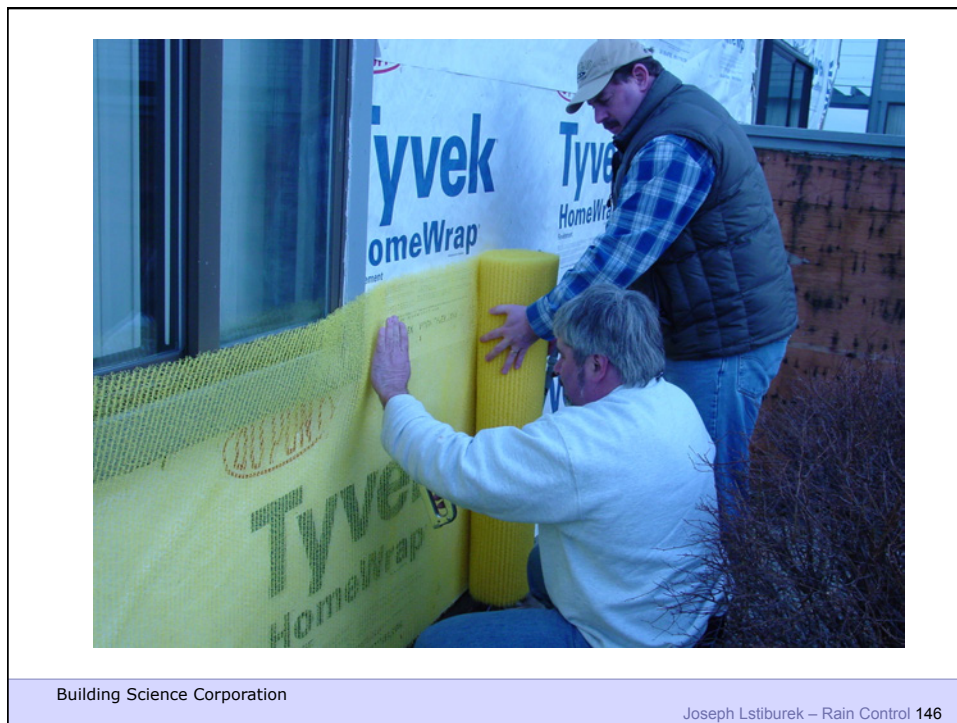
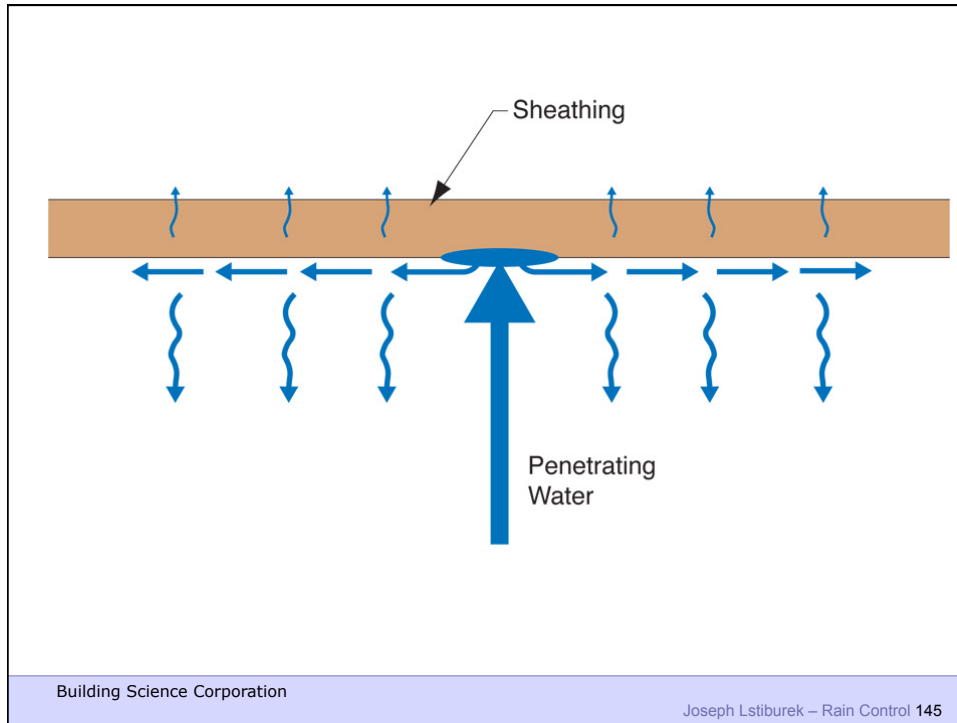

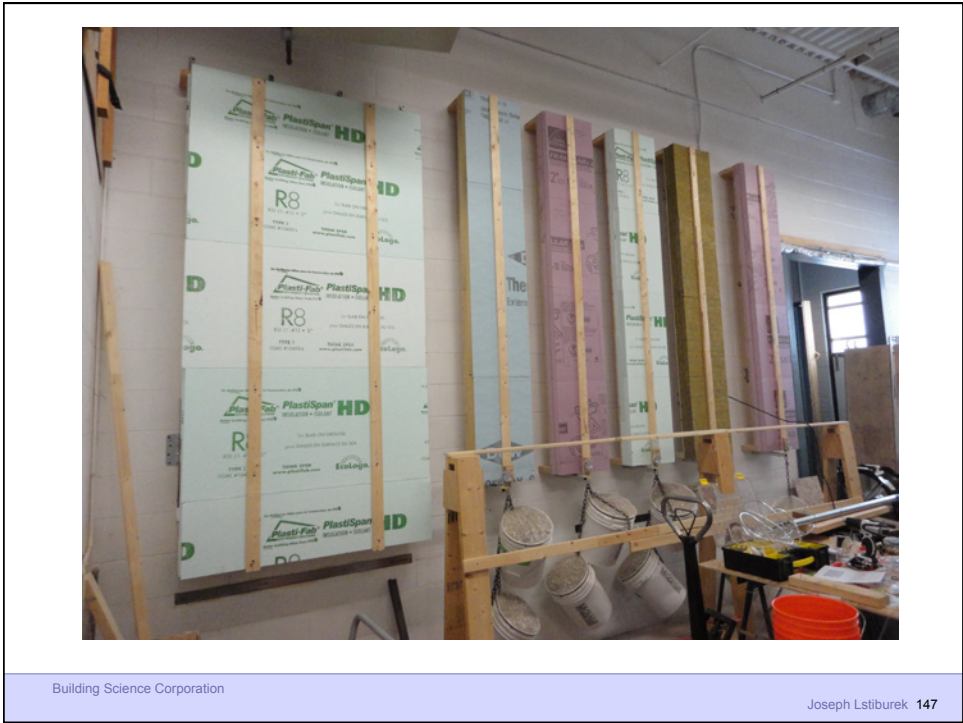



Building Science Corporation

Joseph Lstiburek 149

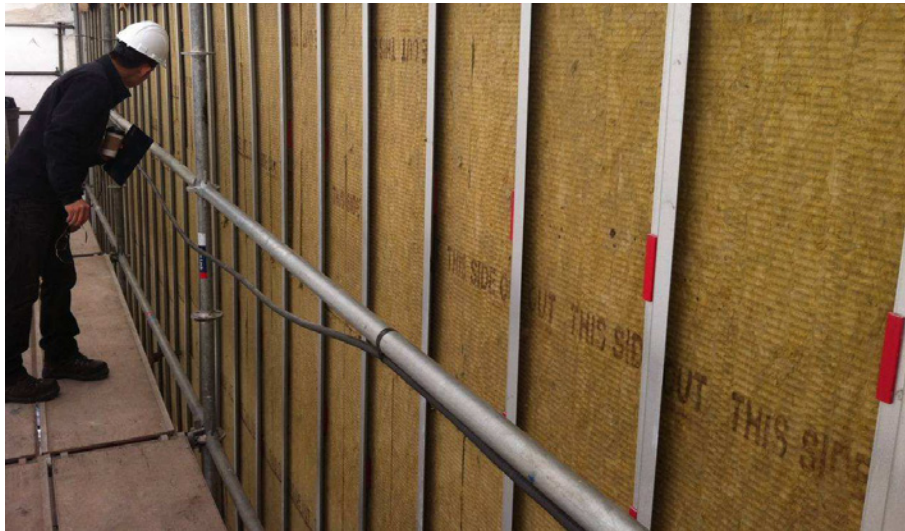

Building Science Corporation

Joseph Lstiburek 150

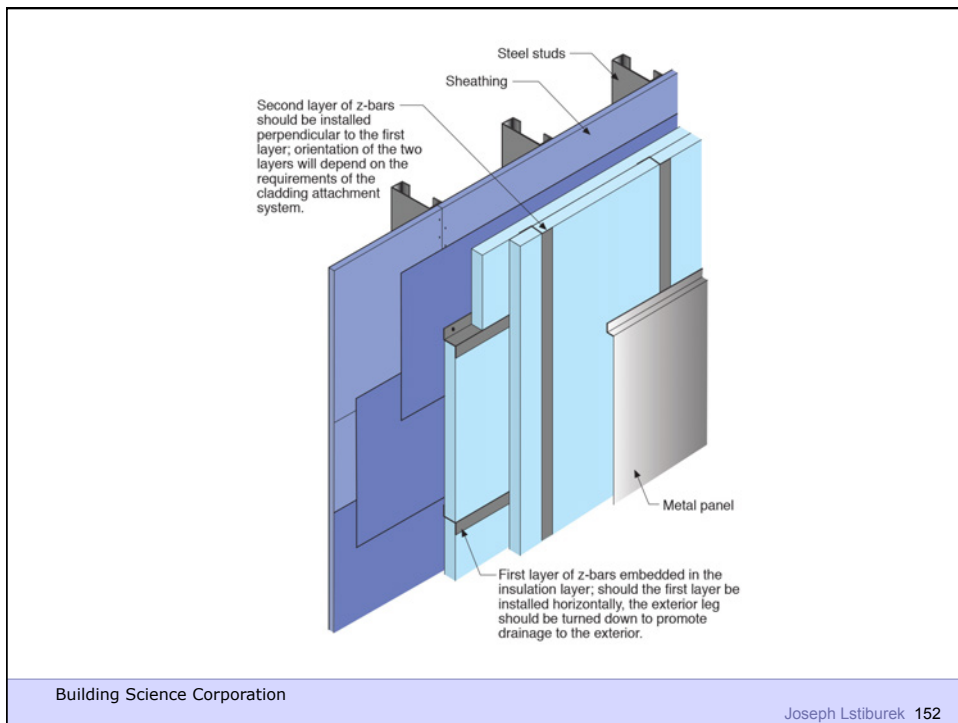
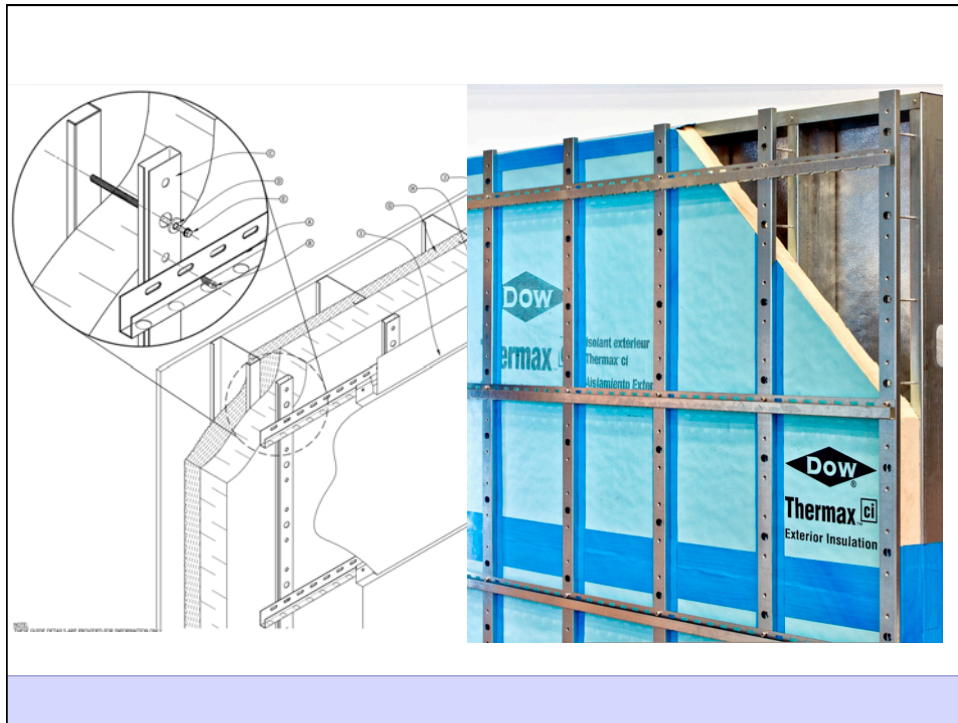

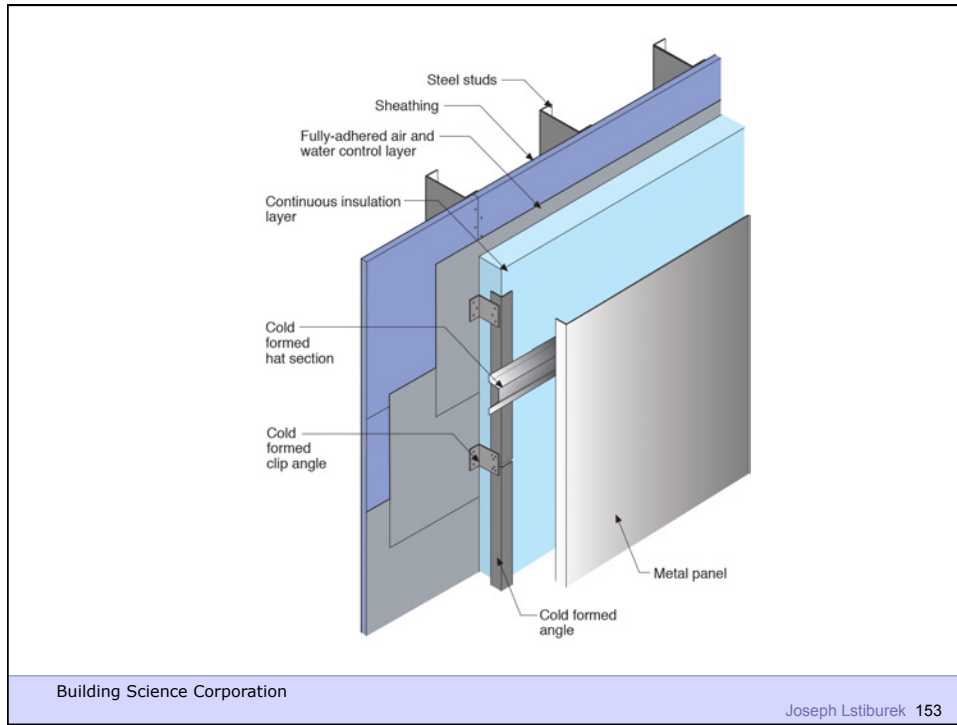



Building Science Corporation

Joseph Lstiburek – Rain Control 155

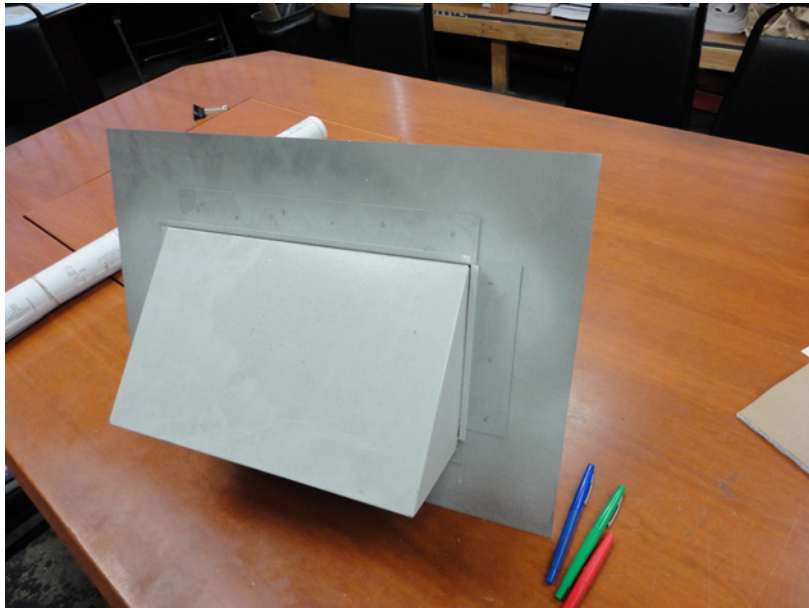

Building Science Corporation

Joseph Lstiburek 156

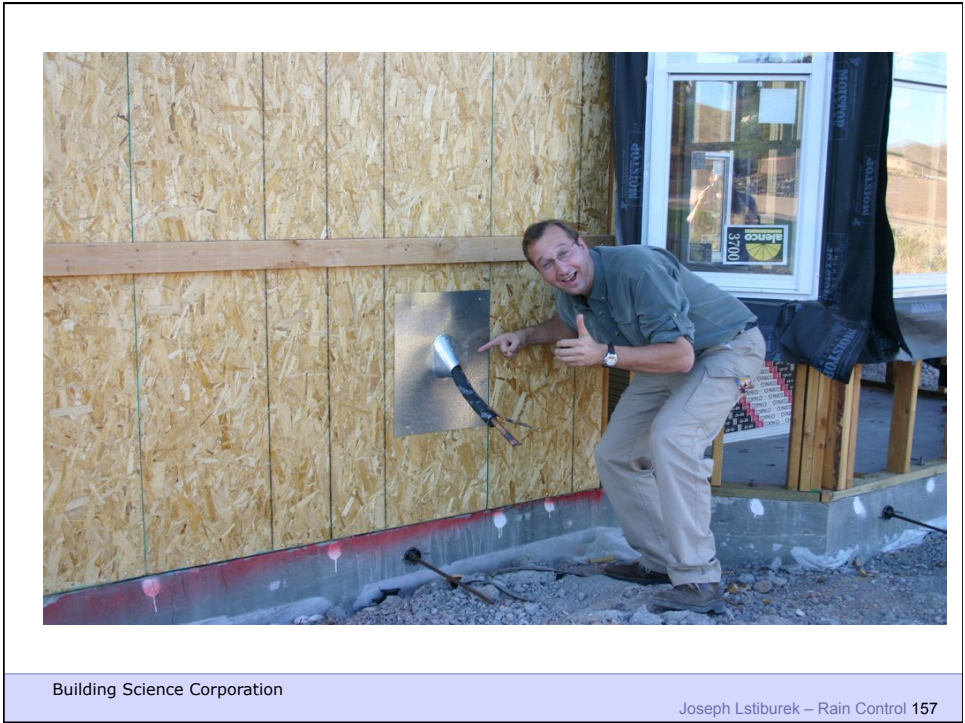



Building Science 2007

Joseph Lstiburek – Rain Control 159



Building Science 2007

Joseph Lstiburek – Rain Control 160

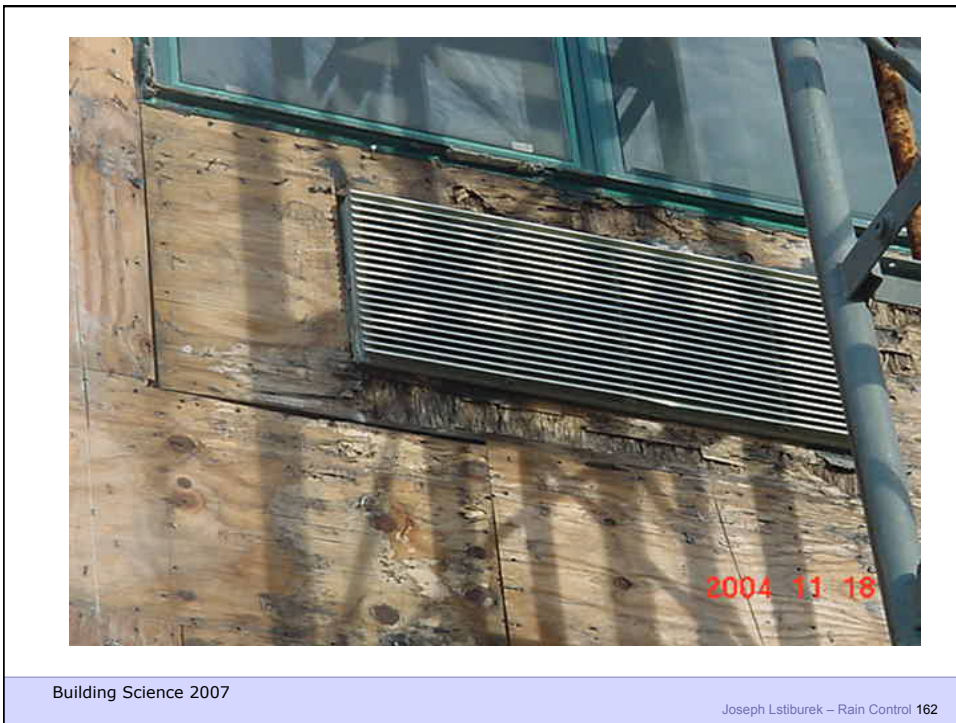



Building Science 2007

Joseph Lstiburek – Rain Control 163

People
Pollutant (hot, wet, UV, ozone)
Path
Pressure

Building Science Corporation

Joseph Lstiburek 164

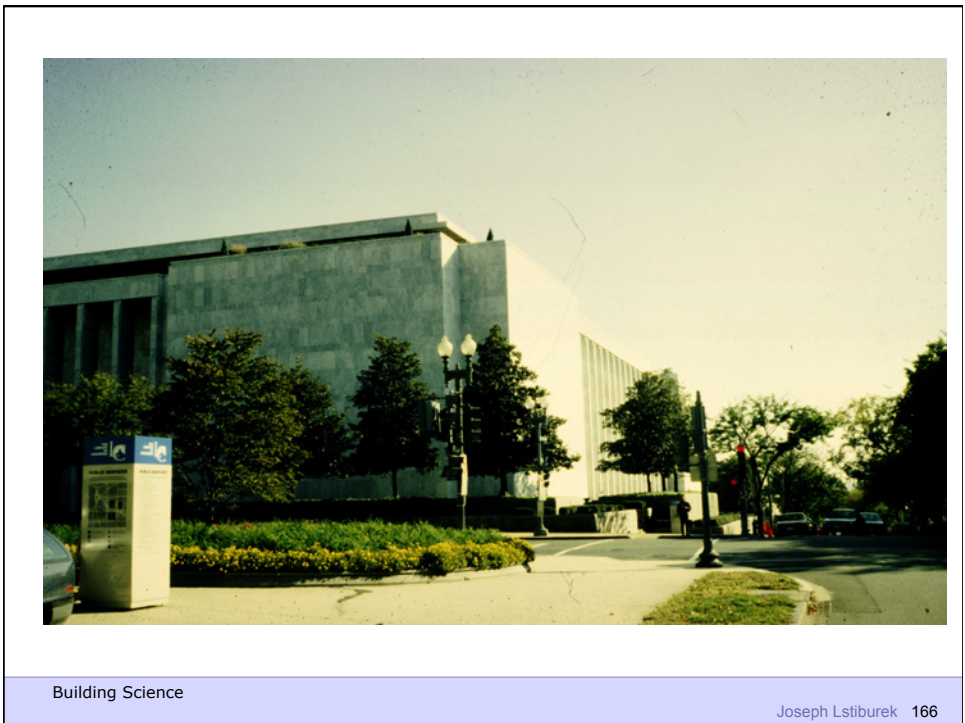



Building Science

Joseph Lstiburek 167



Building Science

Joseph Lstiburek 168

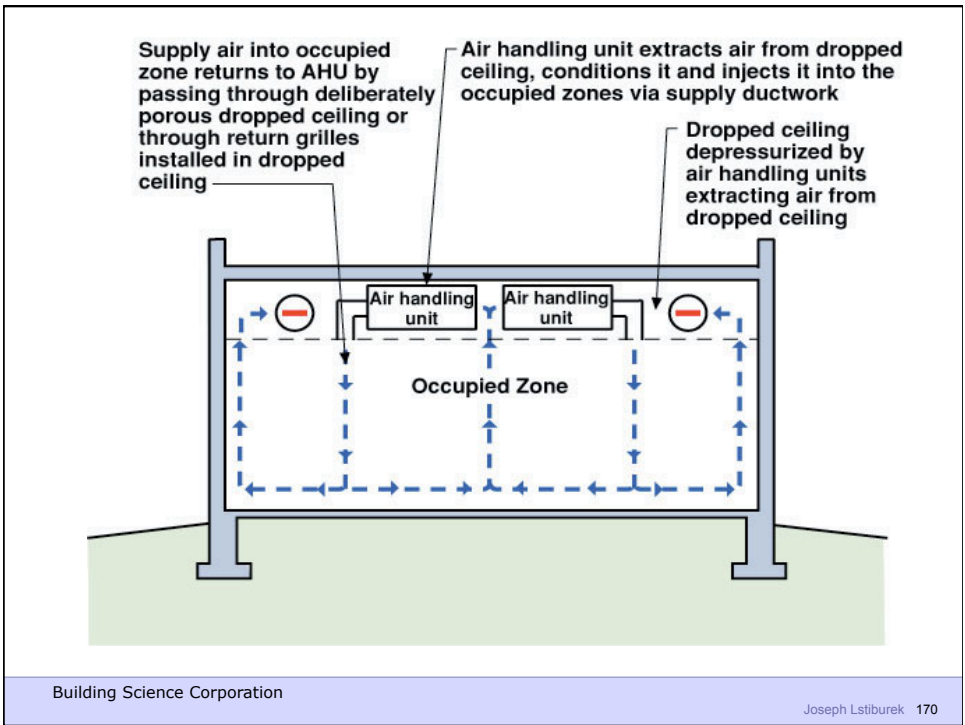
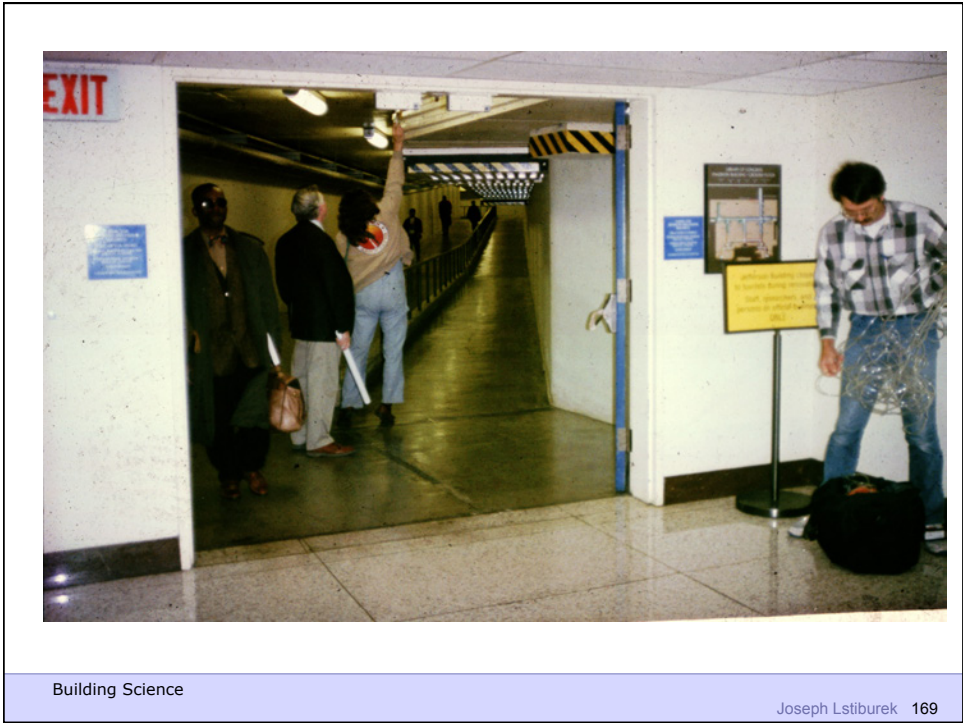

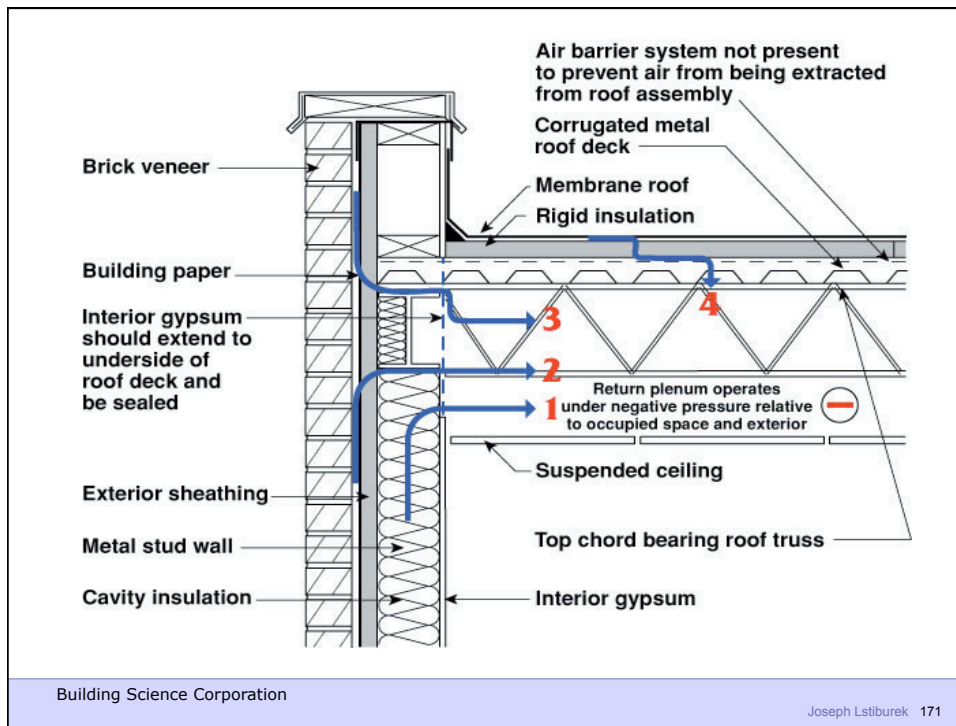



Building Science Corporation

Joseph Lstiburek 173



Building Science Corporation

Joseph Lstiburek 174

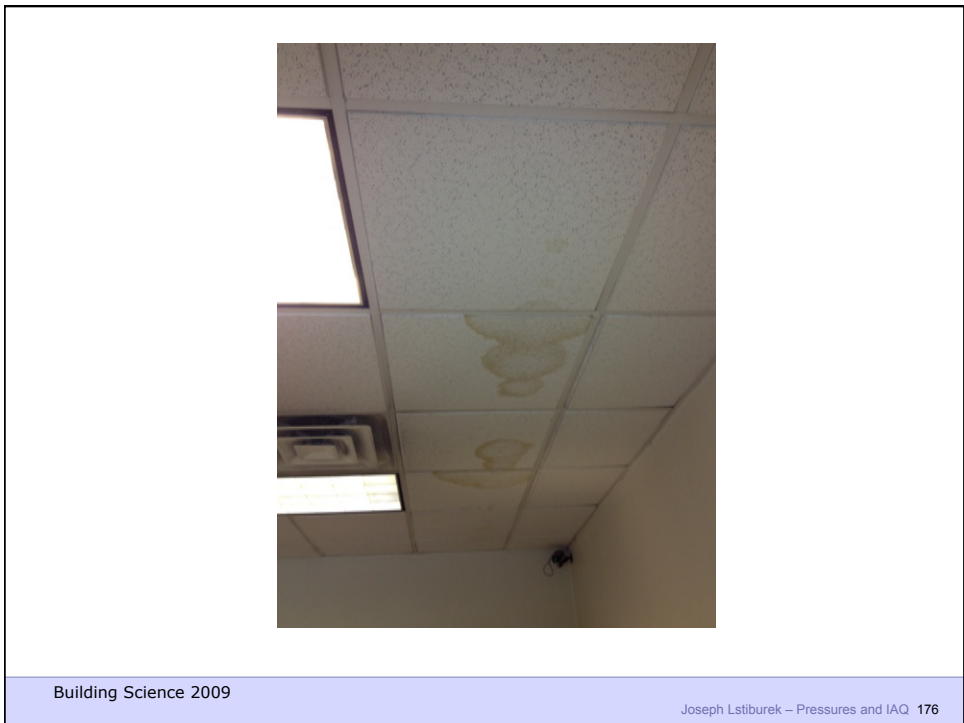

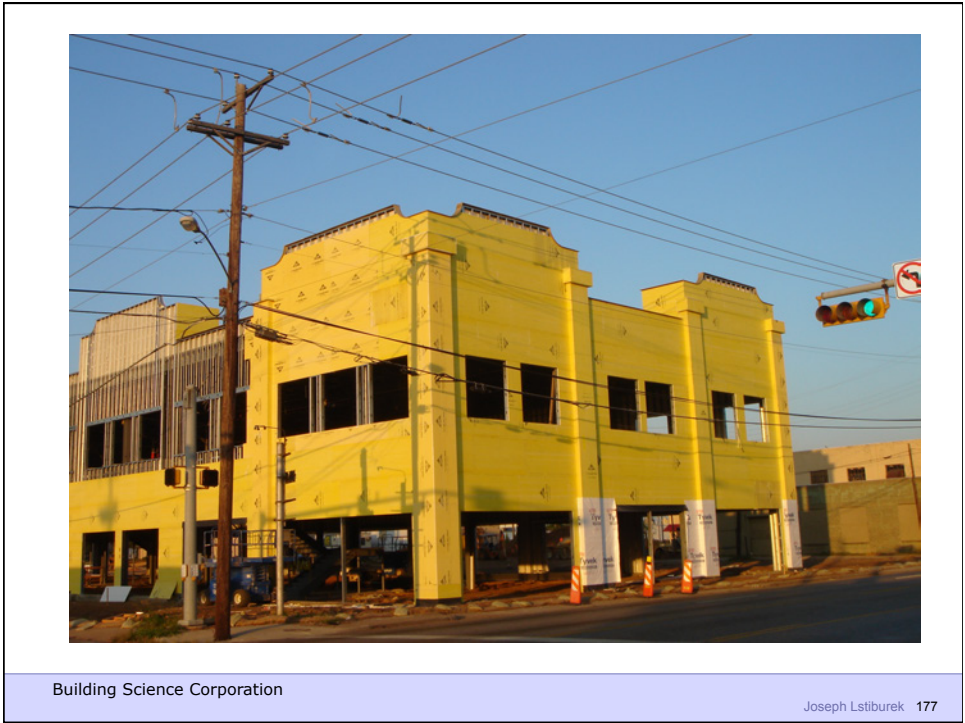



Building Science Corporation

Joseph Lstiburek 179

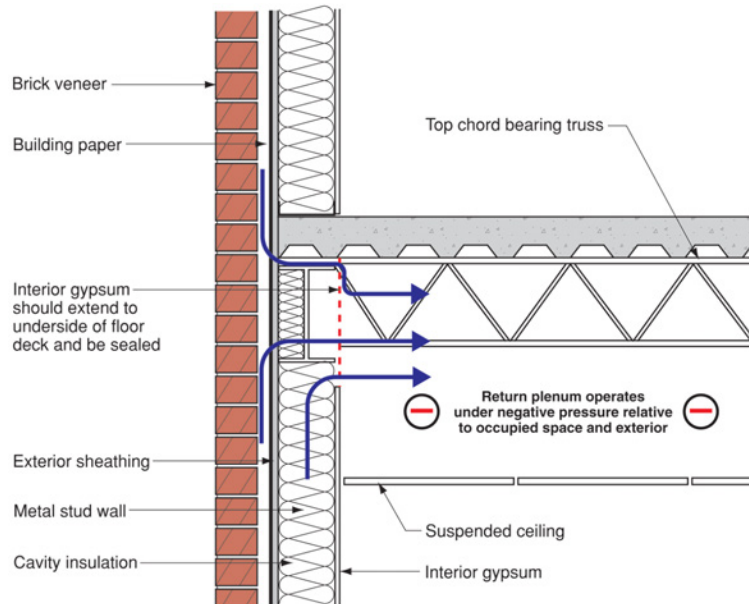

Building Science Corporation

Joseph Lstiburek 180



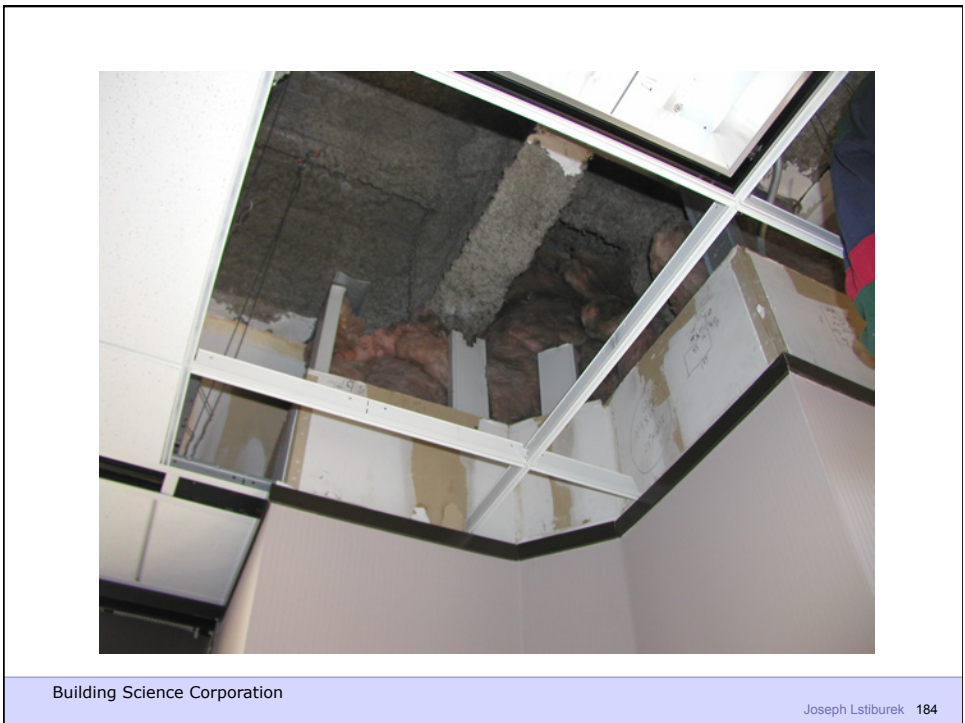



Building Science Corporation

Joseph Lstiburek 185



Building Science Corporation

Joseph Lstiburek 186



Building Science Corporation

Joseph Lstiburek 187

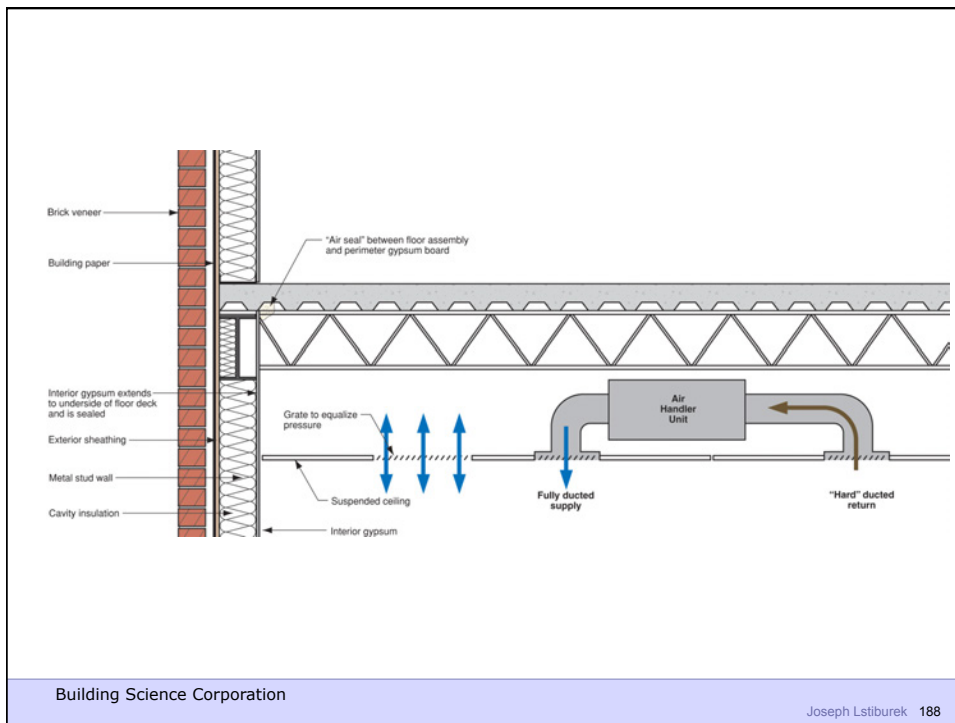

Building Science Corporation

Joseph Lstiburek 188

Pressure difference

Flow Rate (CFM)

Area of opening

Air Flow

- Air flow depends on size of hole
- Air flow depends on pressure difference
- $Flow = Area \times \sqrt{\Delta P \times Coefficient}$
- Air flows from higher pressure to lower pressure

Building Science Corporation

Joseph Lstiburek 189

Figure 2.11
Three Dimensional Multi-Layer Multi-Cell Analogue

Figure 2.12
Three Dimensional Multi-Layer Multi-Cell Non-Contiguous Analogue

Building Science Corporation

Joseph Lstiburek 190

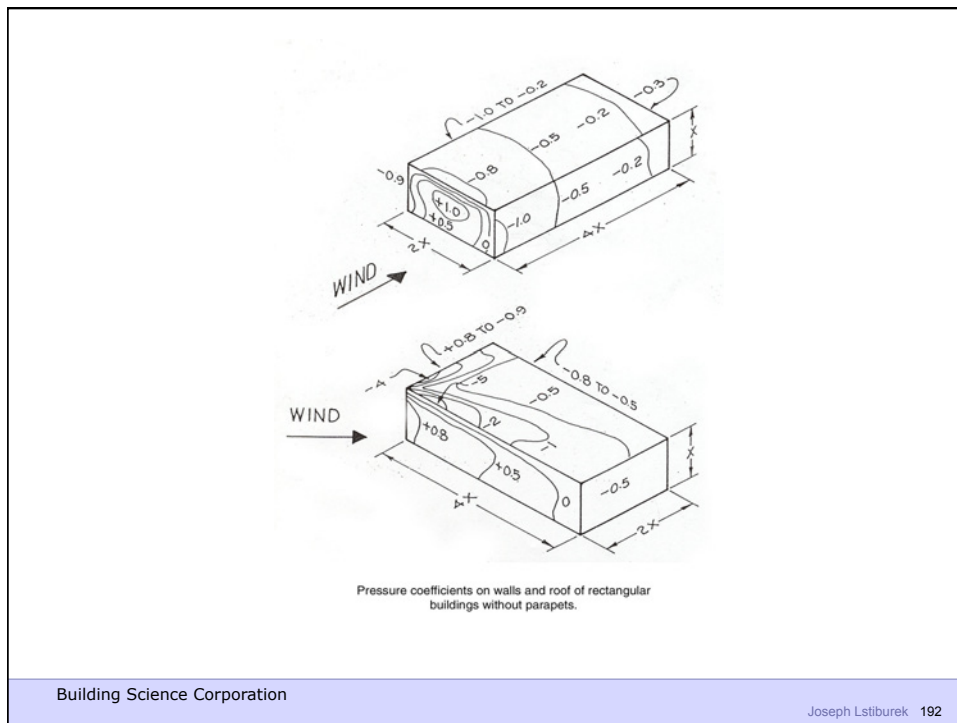
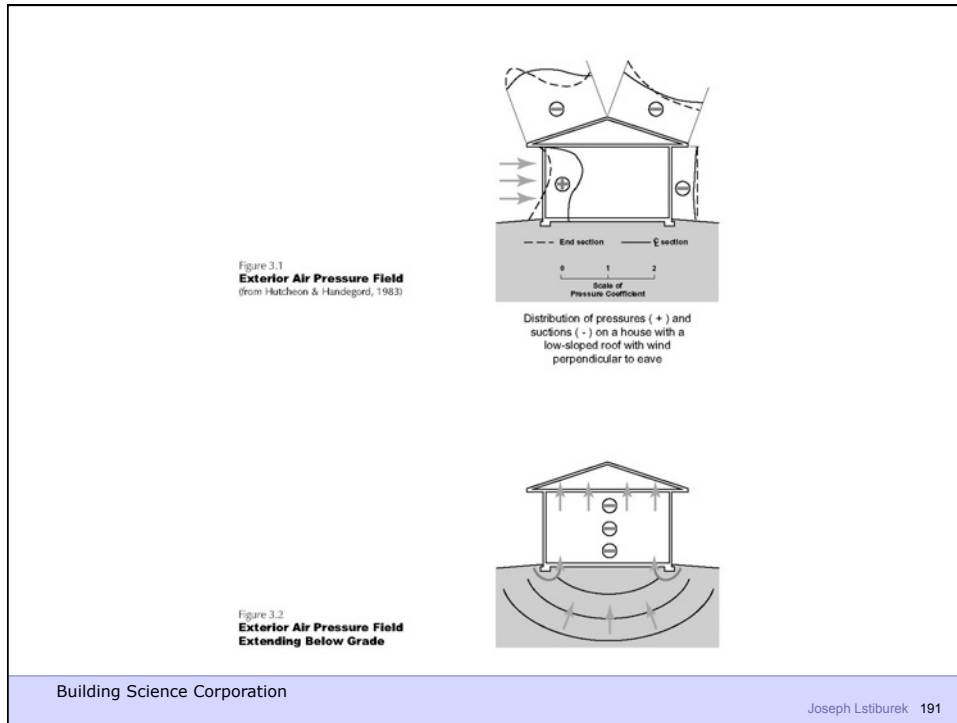

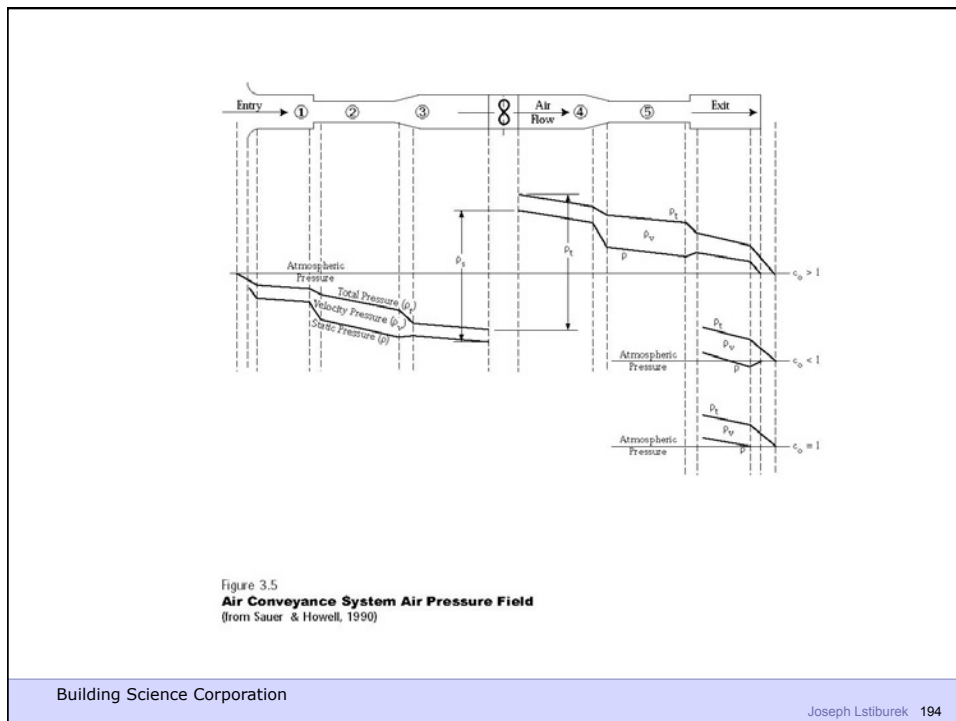
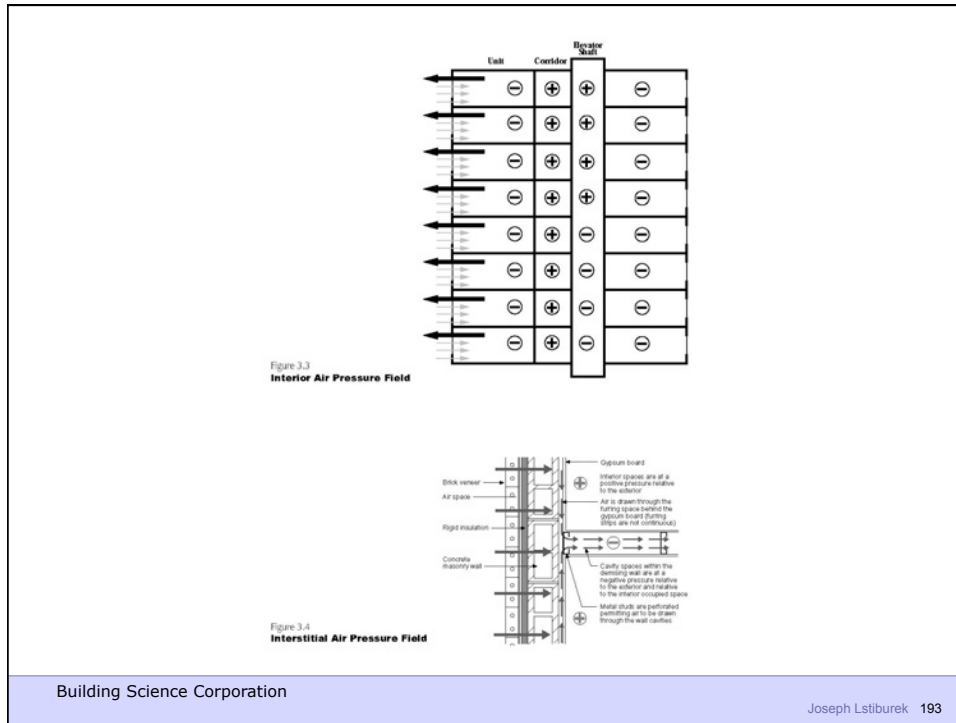

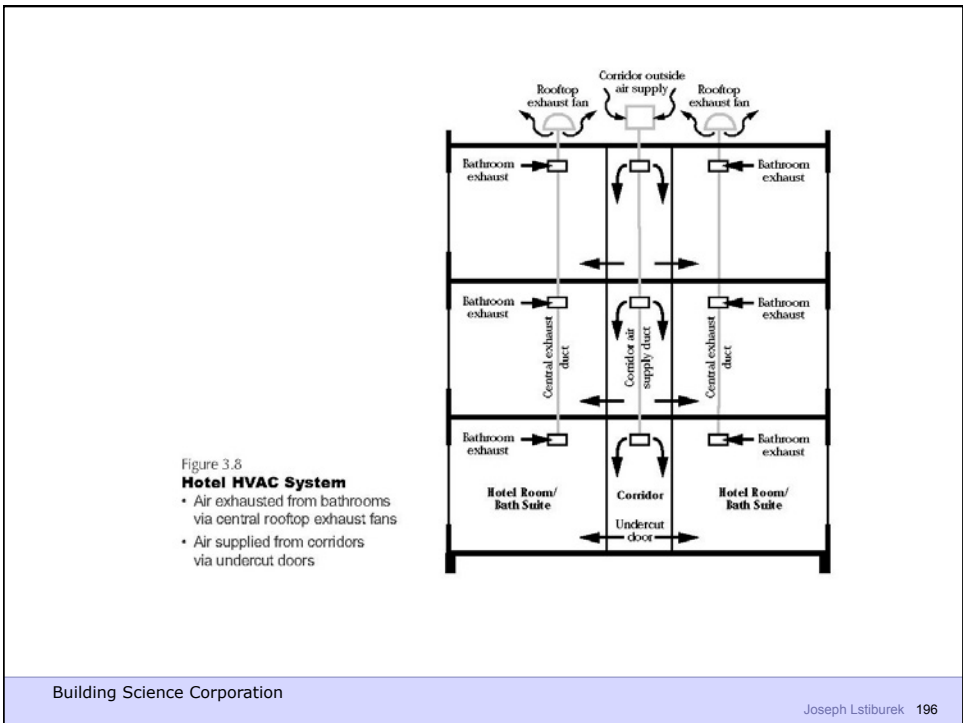
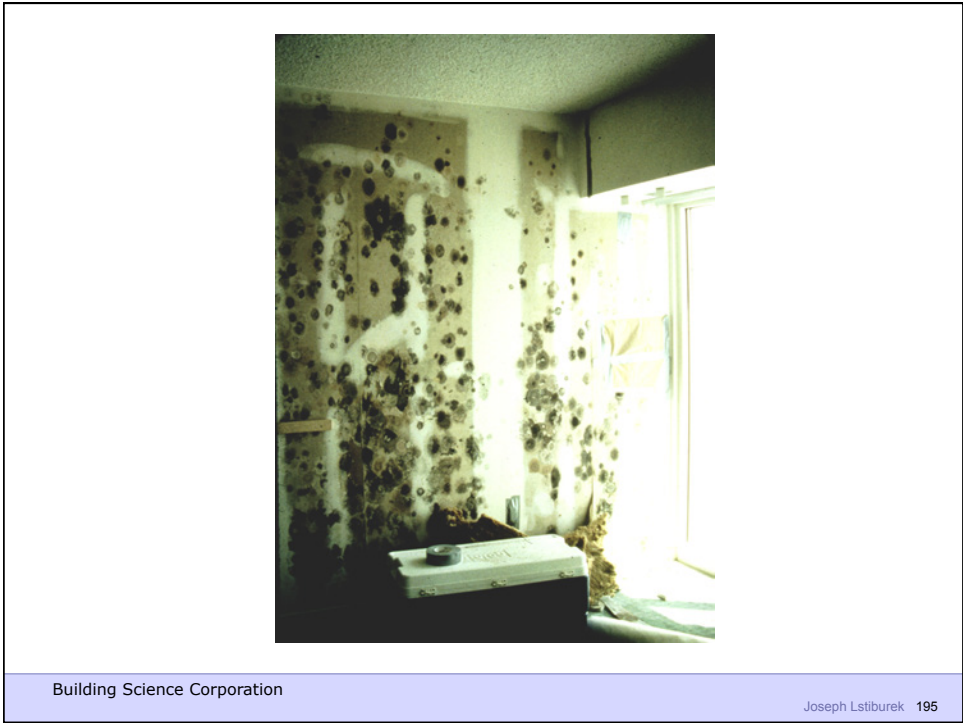

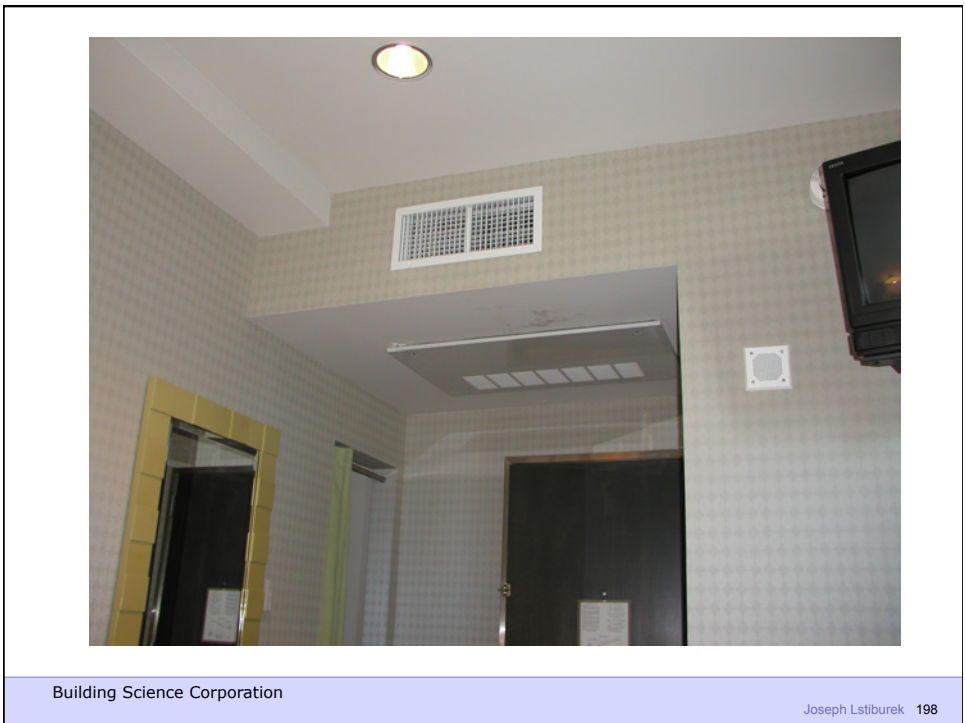
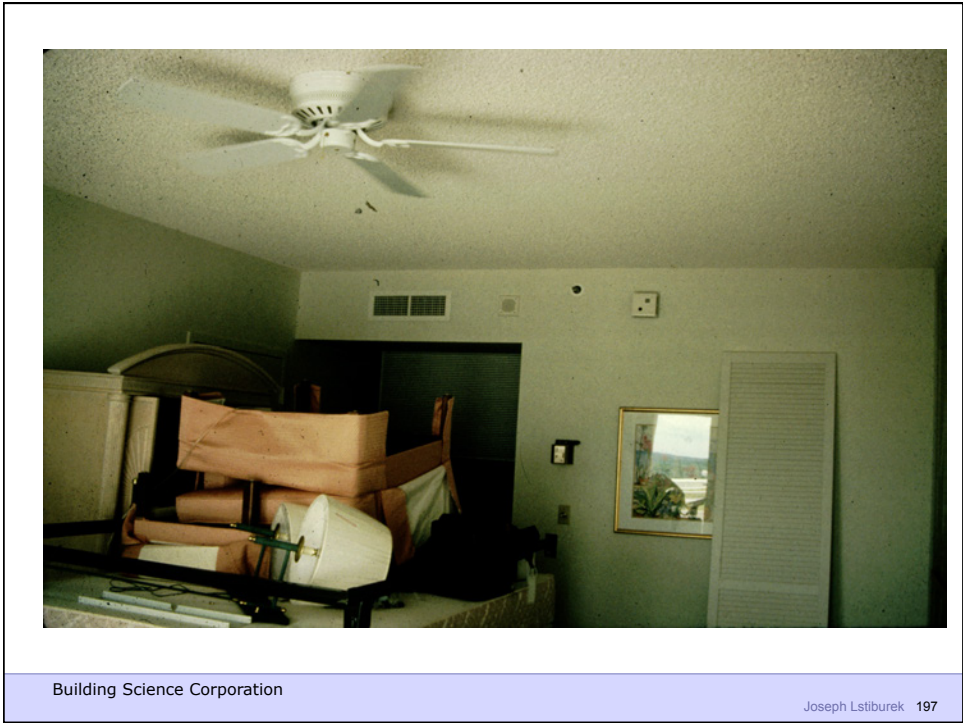

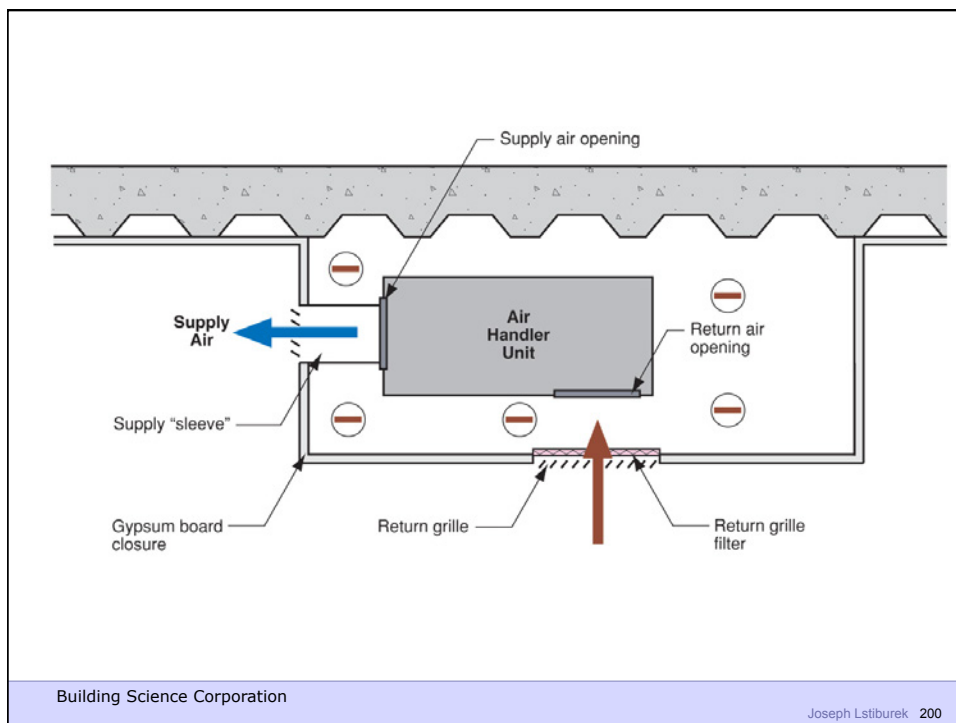
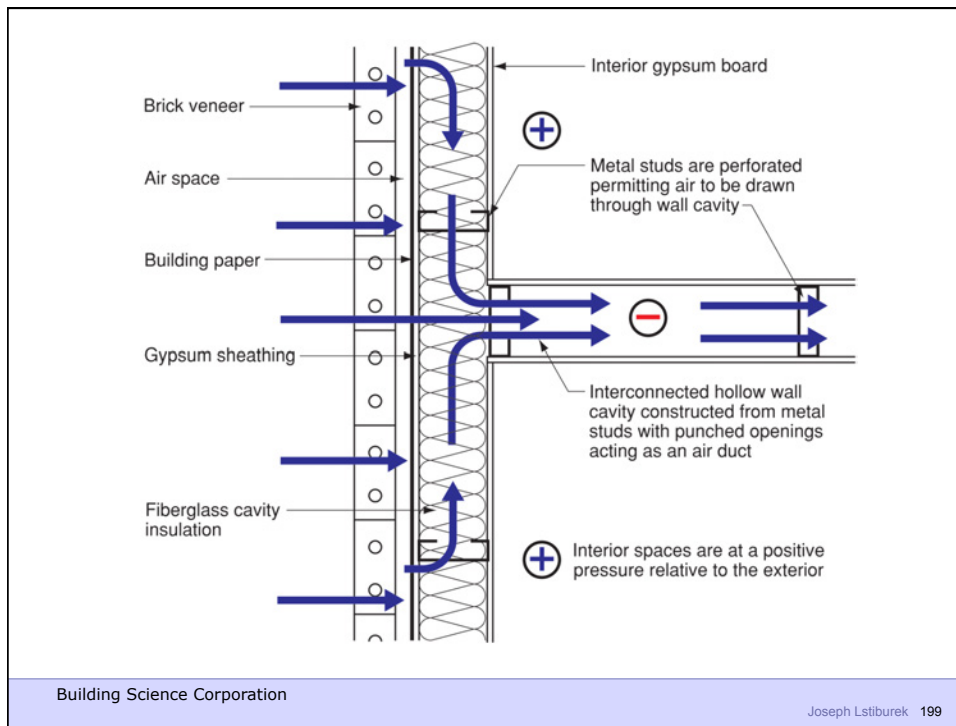

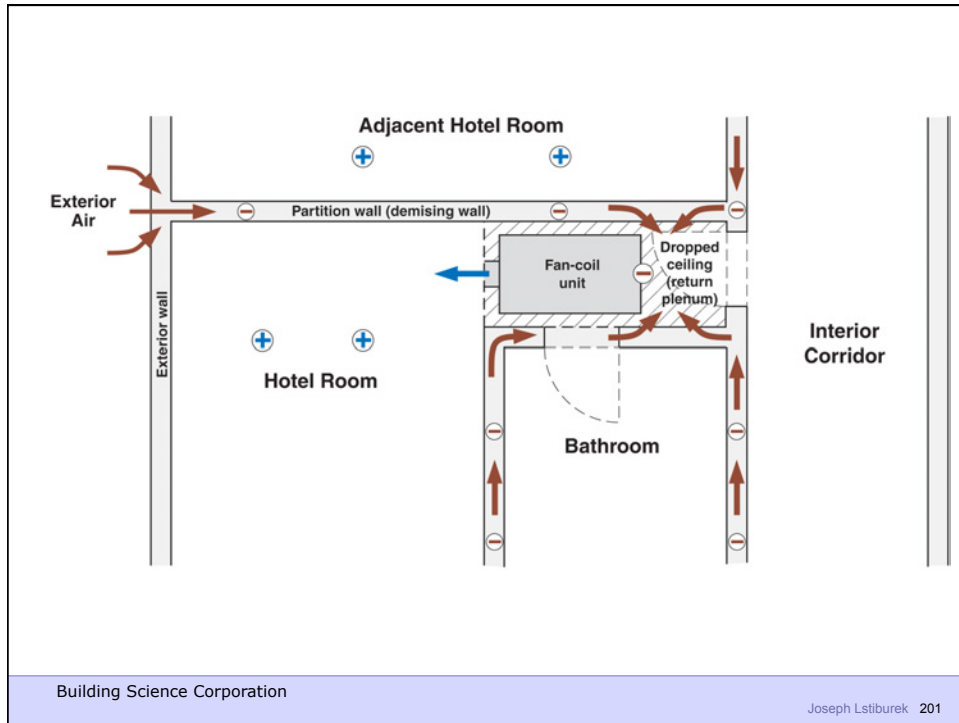



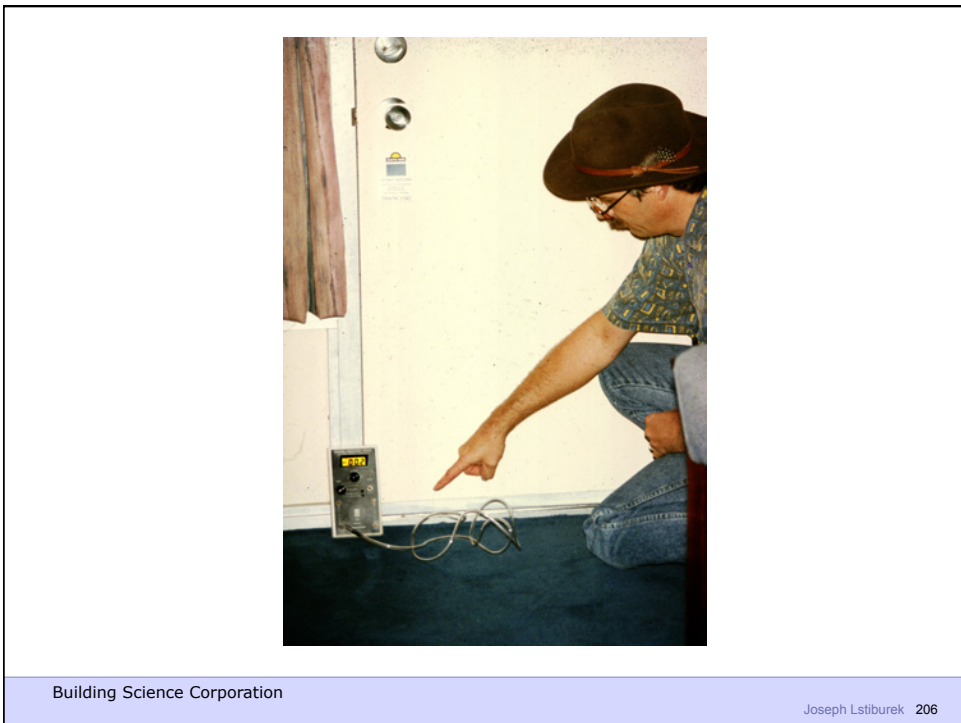
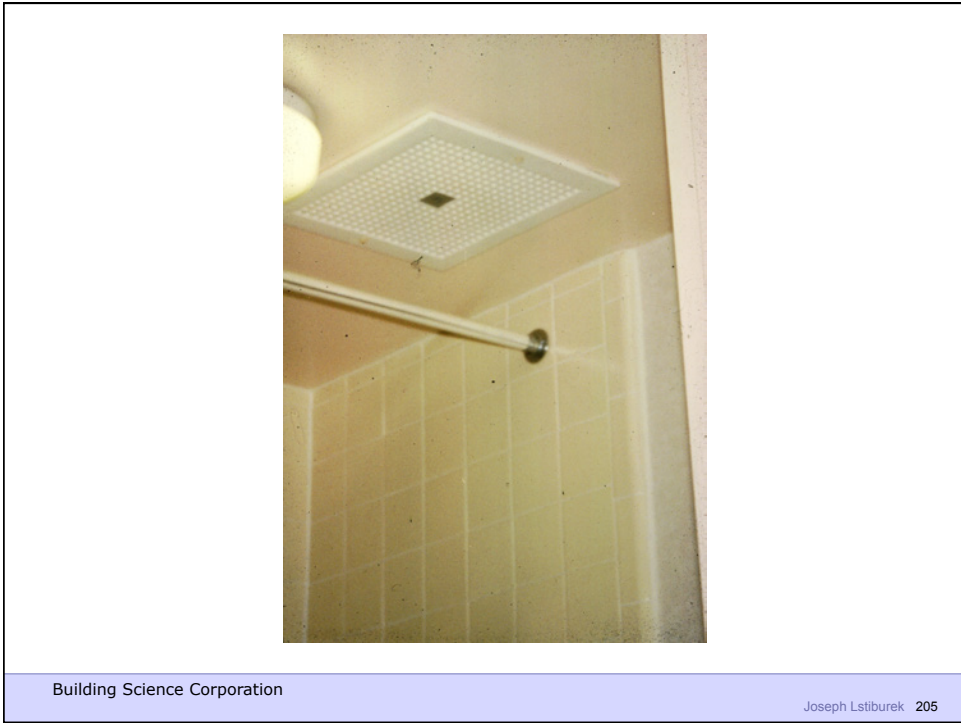





Building Science Corporation

Joseph Lstiburek 209



Building Science Corporation

Joseph Lstiburek 210