

Slabs New Way - No Mold

• Providing rigid foam under the basement slab over a gravel bed is a good idea

• The concrete floor on top will now be warm and will not be prone to condensation during summer high humidity days

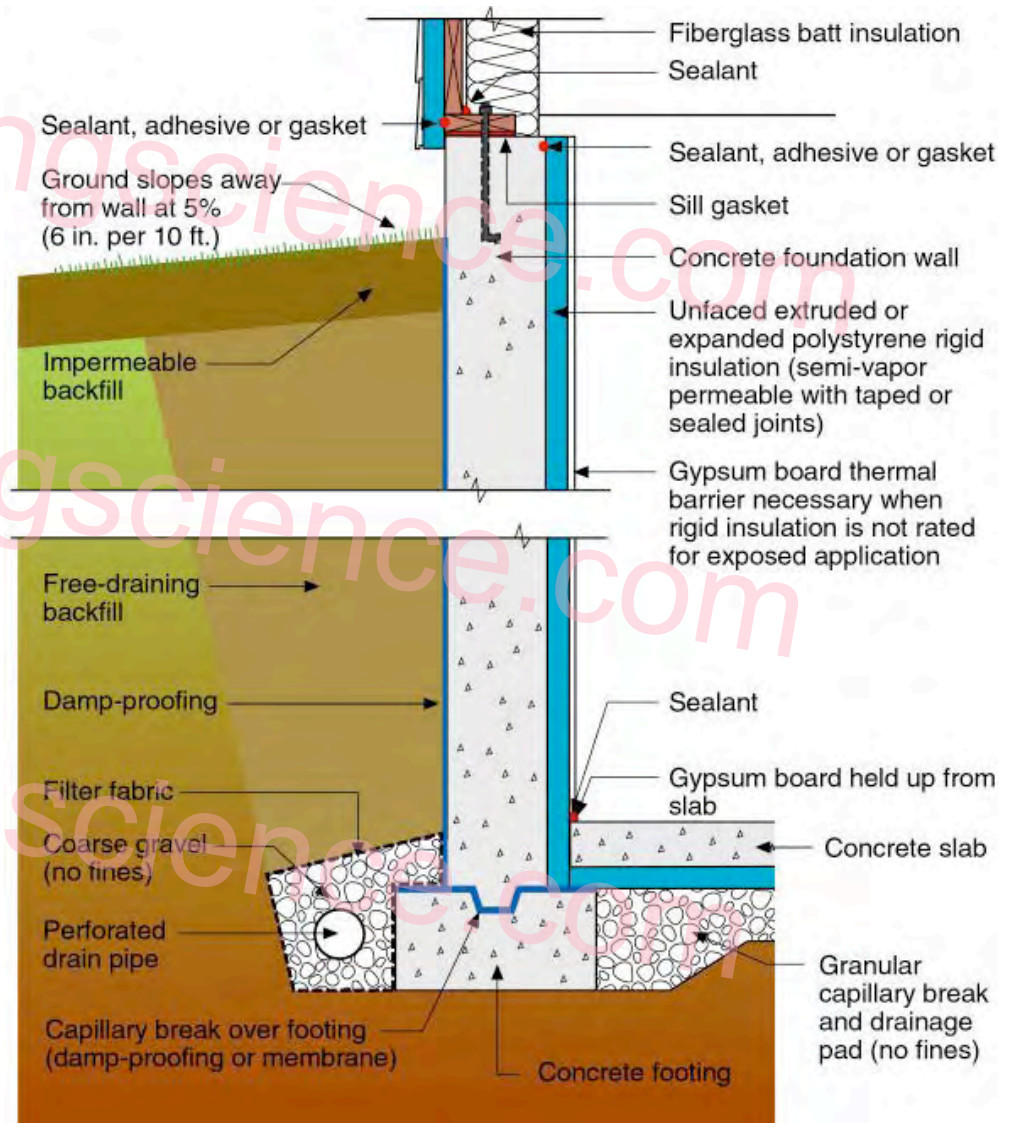



Finished Floor over Existing Slab on Grade



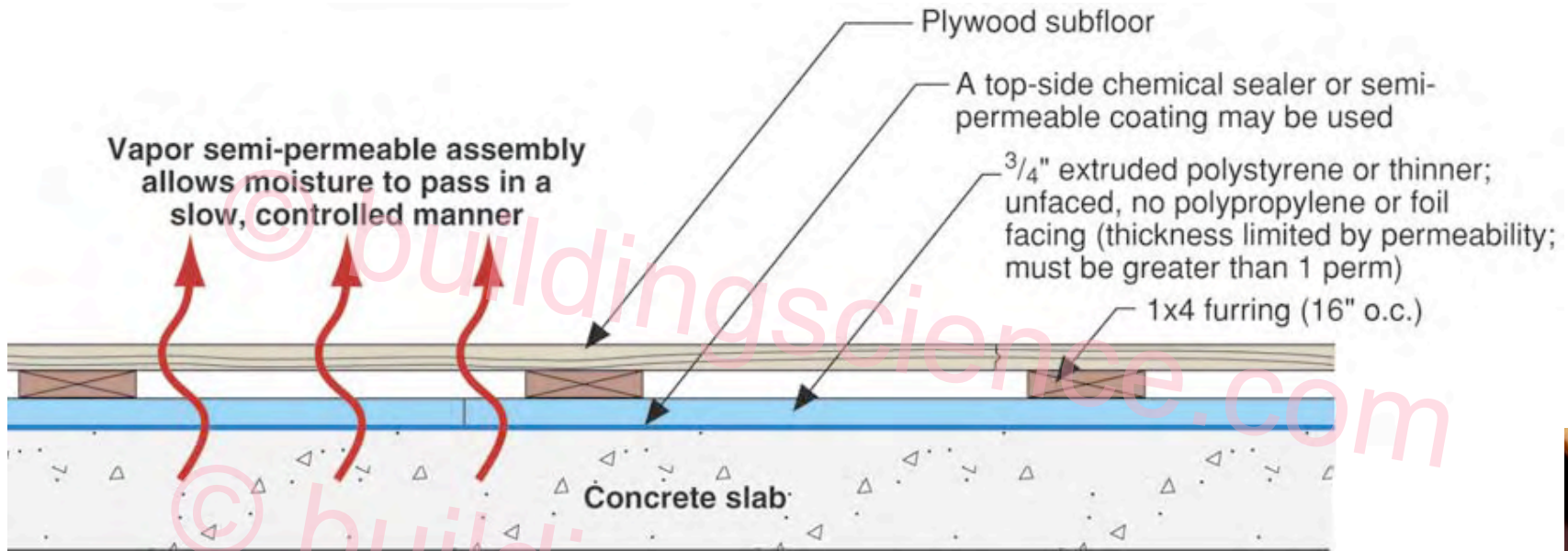



Slabs on Grade - No Mold

Slabs on grade in cold and mixed humid climates should be insulated to avoid condensation and mold growth

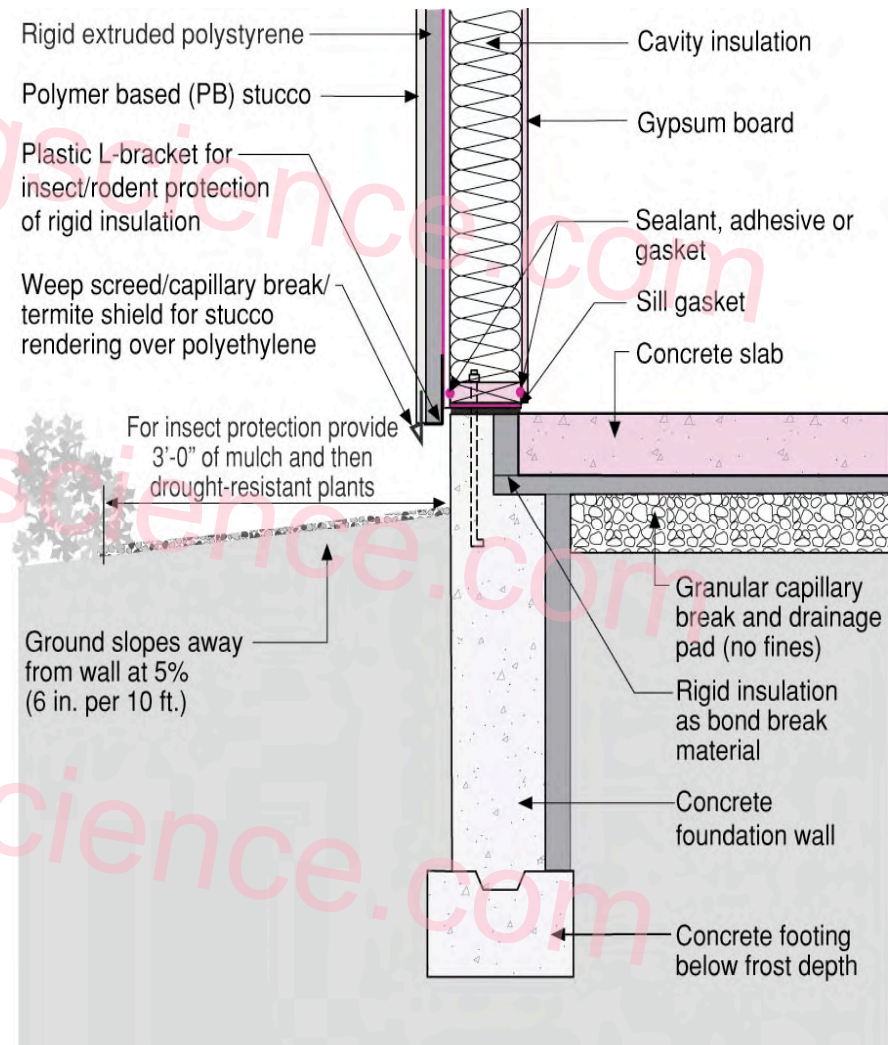















Why a Capillary Break is Required at Footing

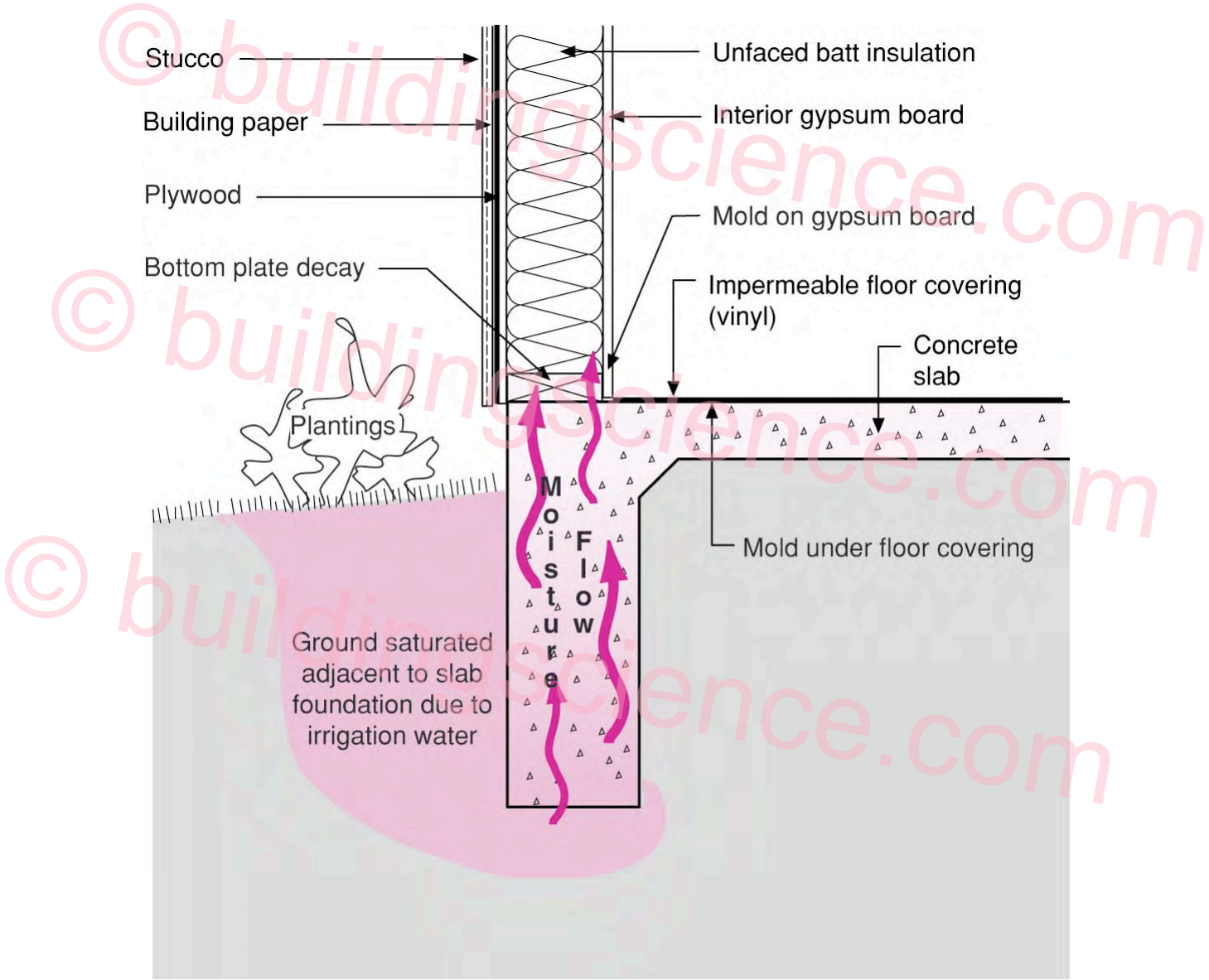

Why Polyethylene Must Be In Contact with the Slab

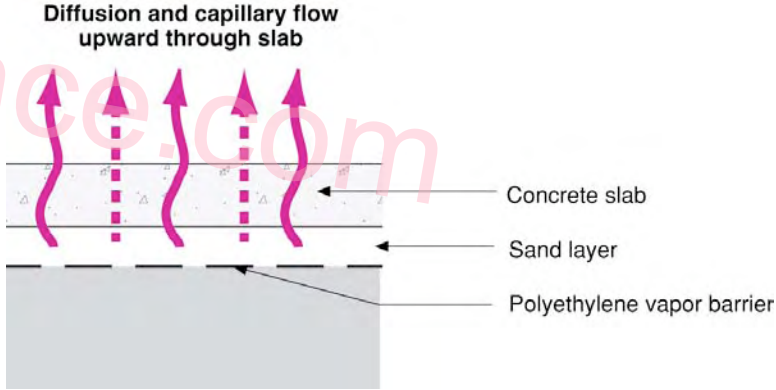
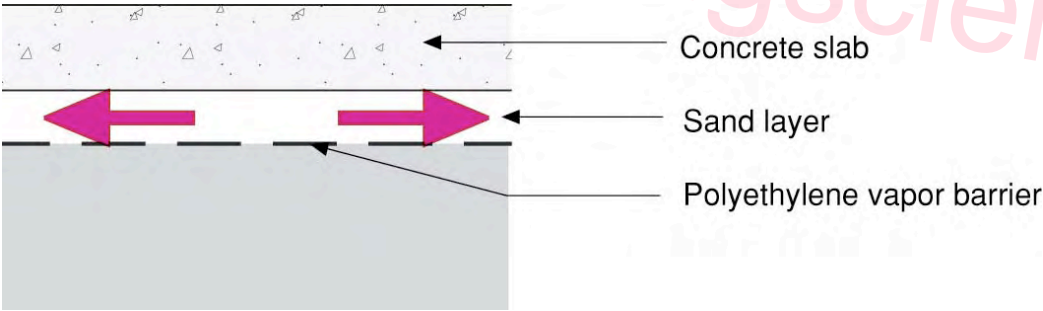
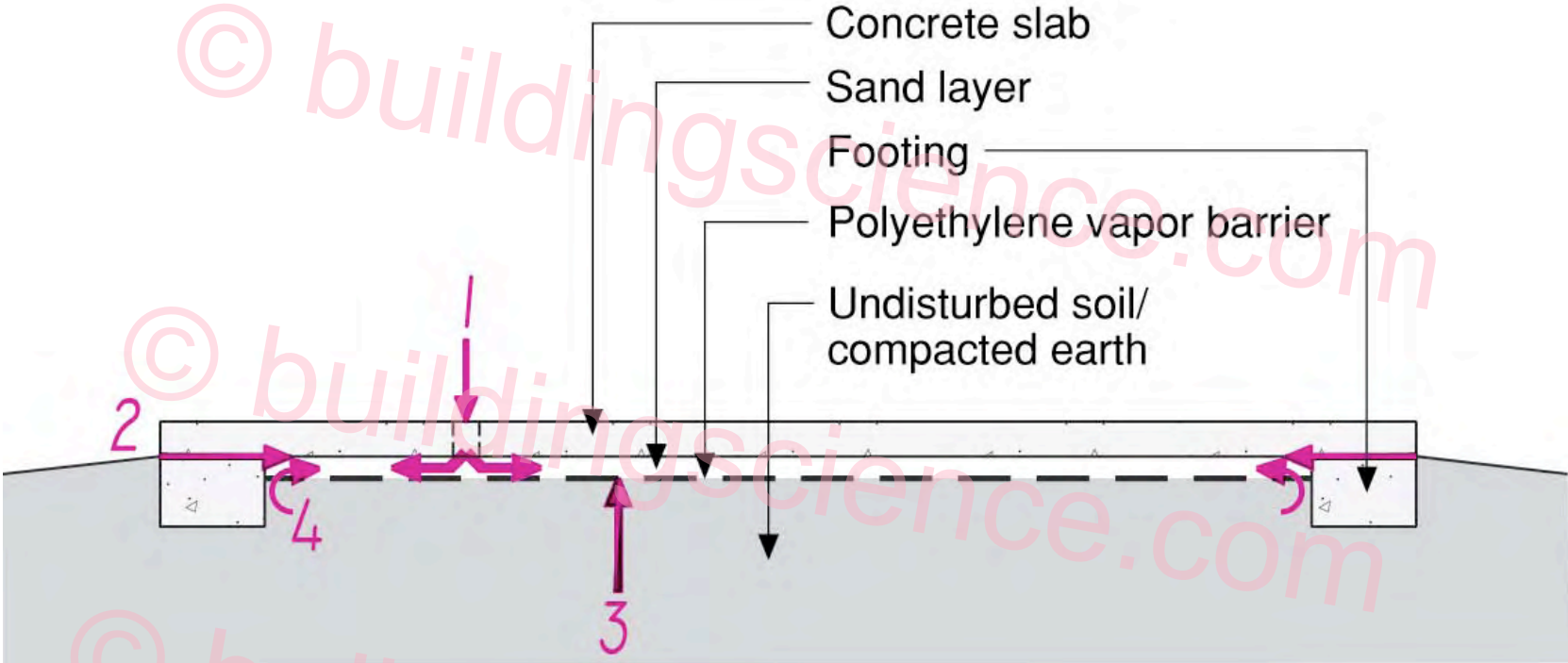

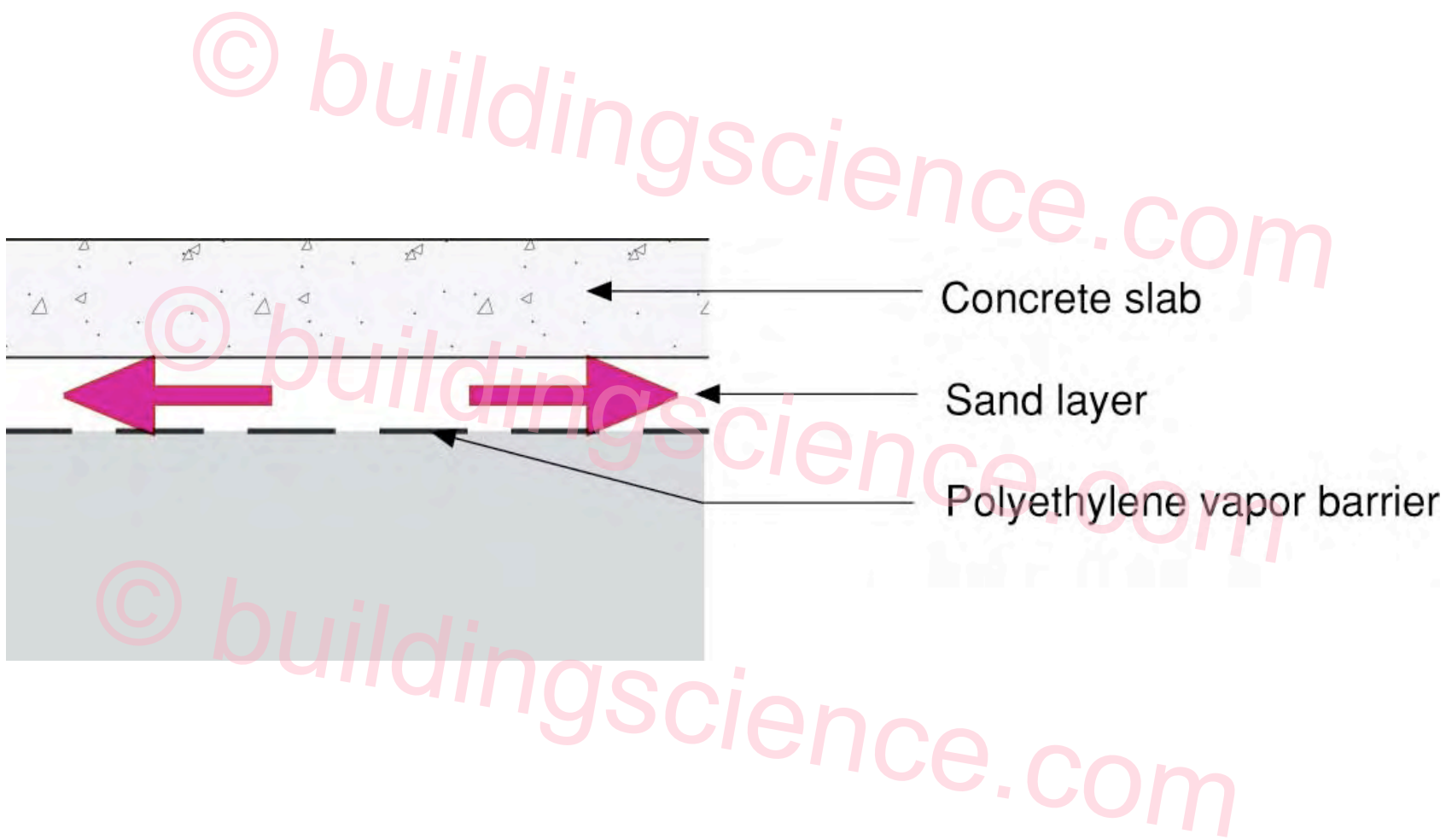

•Polyethylene is always necessary if there is no insulation below the slab

•Important everywhere

•Polyethylene must be in contact with the slab...no sand between slab and poly

